

F.A.I. RTE.	SECTION	COUNTY	TOTAL SHEETS	SHEET NO.
90/94		COOK	565	300
STA. 1518+00.00 TO STA. 1529+50.00				
FED. ROAD DIST. NO. 1 ILLINOIS		FED. AID PROJECT		
62301		(2021-922 PT2 ETC 2324.6-1P) R-10		

**NOTES:**

- SEE DRAWINGS EI-100 AND EI-101 FOR ELECTRICAL SYMBOLS AND ABBREVIATIONS.
- SEE DRAWING EI-106 FOR ELECTRIC DUCTBANK DETAILS.
- UNLESS NOTED OTHERWISE, ALL ITEMS AND WORK SHOWN IN HEAVY LINE WEIGHT ON THIS DRAWING ARE PROPOSED NEW ITEMS AND WORK.
- SEE DRAWING EI-107 FOR TYPICAL INSTALLATION DETAILS OF DUCTBANK AT AN EXISTING BRIDGE ABUTMENT. DUCTBANK SHALL BE TERMINATED AT THE STATIONS AND OFFSETS SHOWN APPROXIMATELY 30" BELOW FINISHED GRADE.
- EXTEND CONDUIT STUB-OUT 2' BEYOND THE SIGN STRUCTURE FOUNDATION. CAP FOR FUTURE USE.

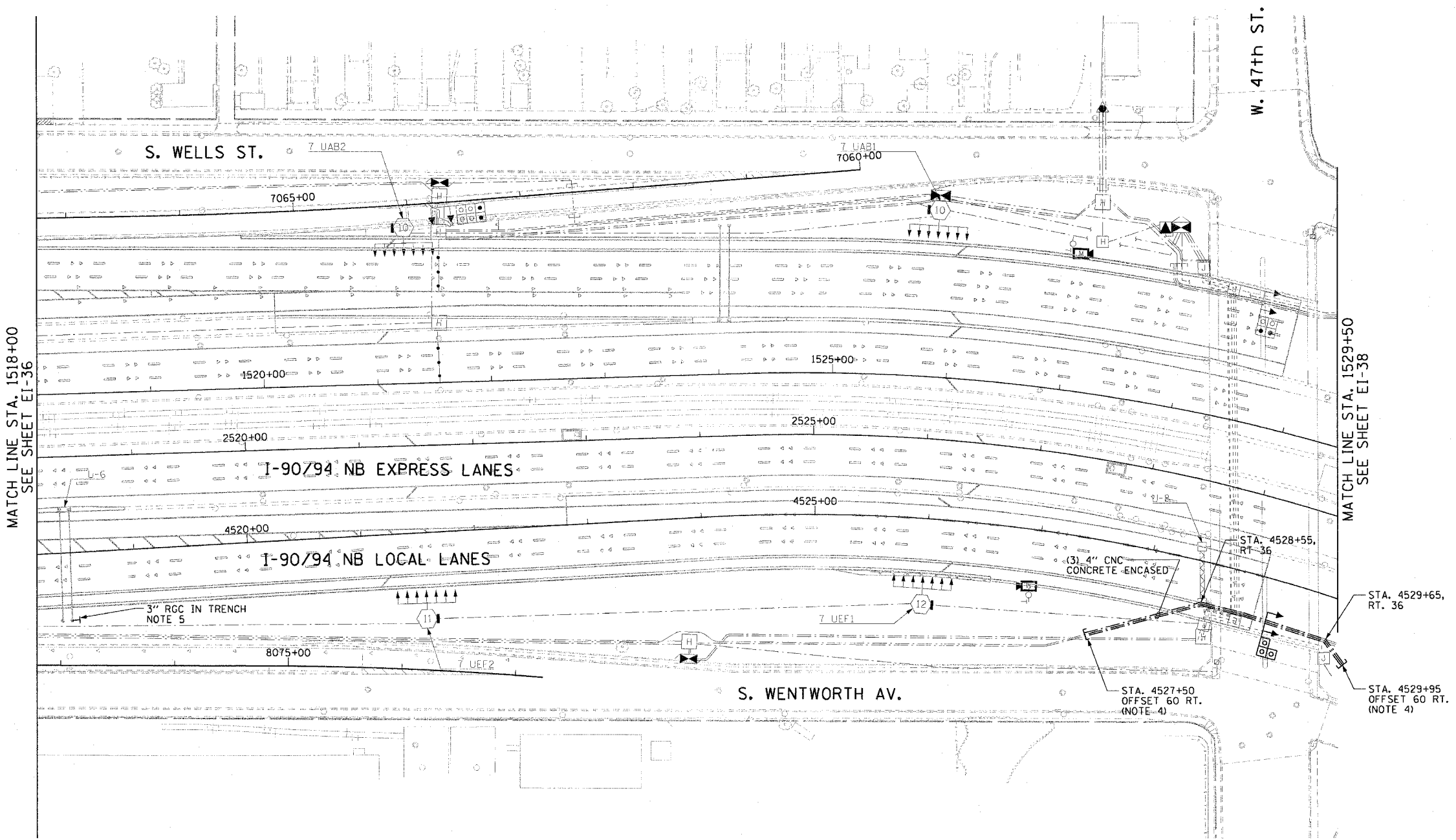

MATCH LINE STA. 1518+00  
SEE SHEET EI-36

MATCH LINE STA. 1529+50  
SEE SHEET EI-38

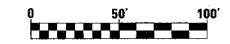

EI-37

REVISIONS	
NAME	DATE

ILLINOIS DEPARTMENT OF TRANSPORTATION  
F.A.I. 90/94 (DAN RYAN EXPRESSWAY)  
GARFIELD BLVD TO 31ST STREET (NB LOCAL LANES)

**ELECTRICAL INFRASTRUCTURE PLAN**

SCALE: 1"=50'  
DATE: June 9, 2006

DRAWN BY: HAR  
CHECKED BY: JPC

CTE | AECOM

06/07/2006 12:27:40 PM