

F.A.I.	SECTION	COUNTY	TOTAL SHEETS	SHEET NO.
94/90		COOK	565	304
STA. 1560+00		TO STA. 1572+00		
FED. ROAD DIST. NO.		ILLINOIS FED. AID PROJECT		
62301 • (2021-922 PT2 ETC 2324.6-1P) R-10				

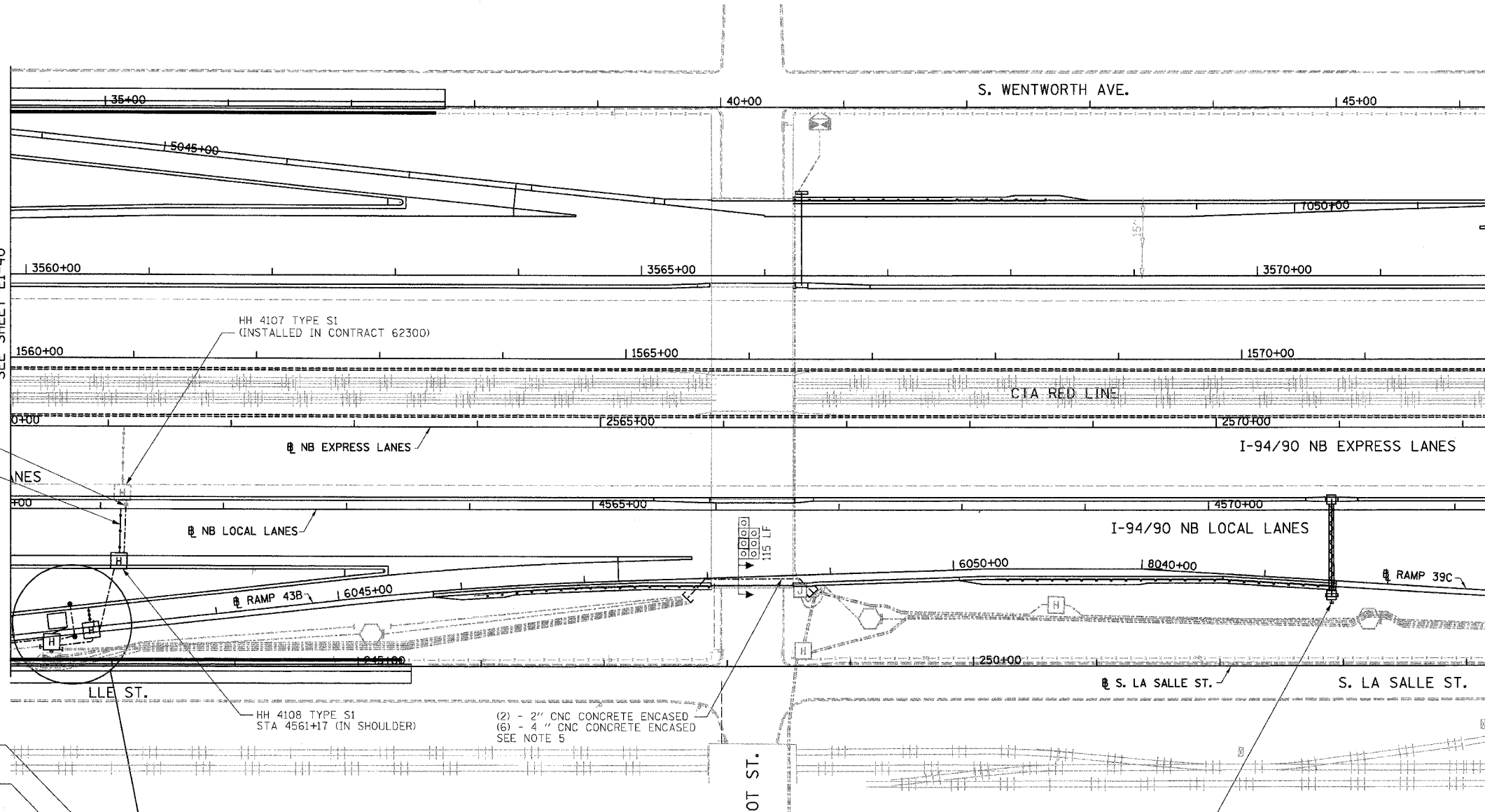

- (1) - 2" GSC IN TRENCH CONNECT TO EXISTING STUBOUT AT ELEV. = -4.77
- (1) - 42' - 3" PVC CONCRETE ENCASED

- CONCRETE FOUNDATION, TYPE A
- (1) - 2" GSC IN TRENCH
- LOOP DETECTOR 12' X 15', BY CONTRACT 62583
- (1) - 2" GSC IN TRENCH
- HH 4109 TYPE C1 STA 6042+78, 11' RT
- (1) - 2' - 4" CNC STUBOUT
- (4) - 2' - 3" GSC STUBOUT
- HH 4108 TYPE S1 STA 4561+17 (IN SHOULDER)
- (2) - 2" CNC CONCRETE ENCASED
- (6) - 4" CNC CONCRETE ENCASED
- SEE NOTE 5
- (1) - 2" GSC IN TRENCH
- (1) - 17' - 3" PVC CONCRETE ENCASED
- HH 4110, TYPE S1 (SPECIAL) STA 6042+91
- CONCRETE FOUNDATION, TYPE A
- (2) - 2" GSC IN TRENCH
- (1) - 2' - 4" CNC STUBOUT

- NOTES:
1. SEE DRAWINGS EI-100 AND EI-101 FOR ELECTRICAL SYMBOLS AND ABBREVIATIONS.
 2. SEE DRAWINGS EI-102, EI-103, AND EI-104 FOR TYPICAL HANDHOLE INSTALLATION DETAILS.
 3. TRENCHED CONDUITS INSTALLED IN PARALLEL ARE TO BE INSTALLED IN COMMON TRENCH.
 4. THIS CONTRACT IS RESPONSIBLE FOR PROPOSED ITEMS THAT ARE LABELED. UNLABELLED ITEMS ARE THE RESPONSIBILITY OF CONTRACT 62583. ALL WORK MUST BE COORDINATED BY BOTH CONTRACTS.
 5. ELECTRICAL DUCTBANKS AROUND BRIDGE ABUTMENTS MUST CLEAR ALL PROPOSED DRAINAGE STRUCTURES. SEE DRAINAGE PLANS FOR DETAILS.

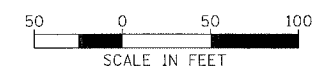

BOWMAN, BARRETT & ASSOCIATES INC.
CONSULTING ENGINEERS
Chicago, Illinois
312.228.0100
www.bbainc.com

REVISIONS	
NAME	DATE

EI-41

ILLINOIS DEPARTMENT OF TRANSPORTATION
F.A.I. 94/90 (DAN RYAN EXPRESSWAY)
59TH STREET TO 31ST STREET (NB LOCAL LANES)
ELECTRICAL INFRASTRUCTURE PLANS

SCALE: 1"=50'
DATE: 06/09/06

DRAWN BY: JDC
CHECKED BY: RS

6/7/2006 12:53:38 PM