

| | | | | |
|-------------------------------------------|----------|------------------|--------------|-----------|
| F.A.I. | SECTION | COUNTY | TOTAL SHEETS | SHEET NO. |
| 94/90 | | COOK | 565 | 310 |
| STA. 1632+00 | | TO STA. 1644+00 | | |
| FED. ROAD DIST. NO. | ILLINOIS | FED. AID PROJECT | | |
| 62301 • (2021-922 PT2 ETC 2324.6-1P) R-10 | | | | |



NO PROPOSED WORK ON THIS SHEET

W. 30th ST.

MATCH LINE STA. 1632+00
SEE SHEET EI-46

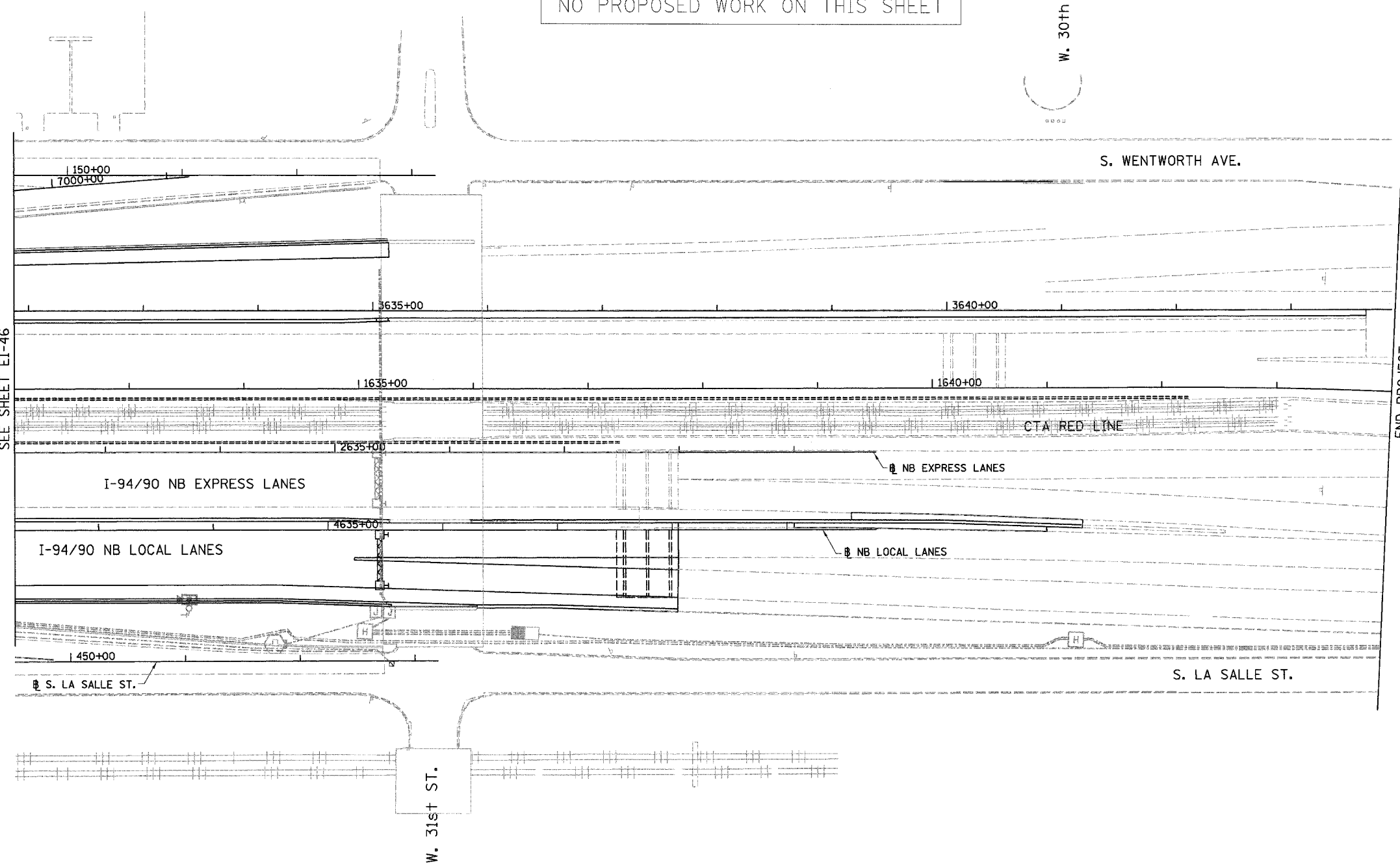

END PROJECT

- NOTES:
- SEE DRAWINGS EI-100 AND EI-101 FOR ELECTRICAL SYMBOLS AND ABBREVIATIONS.
 - SEE DRAWINGS EI-102, EI-103, AND EI-104 FOR TYPICAL HANDHOLE INSTALLATION DETAILS
 - TRENCHED CONDUITS INSTALLED IN PARALLEL ARE TO BE INSTALLED IN COMMON TRENCH.
 - THIS CONTRACT IS RESPONSIBLE FOR PROPOSED ITEMS THAT ARE LABELED. UNLABELLED ITEMS ARE THE RESPONSIBILITY OF CONTRACT 62583. ALL WORK MUST BE COORDINATED BY BOTH CONTRACTS.

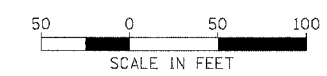

BOWMAN, BARRETT & ASSOCIATES INC.
CONSULTING ENGINEERS
Chicago, Illinois
312.228.0100
www.bbainc.com

| REVISIONS | |
|-----------|------|
| NAME | DATE |
| | |
| | |
| | |
| | |
| | |
| | |
| | |
| | |
| | |
| | |

ILLINOIS DEPARTMENT OF TRANSPORTATION
F.A.I. 94/90 (DAN RYAN EXPRESSWAY)
59TH STREET TO 31ST STREET (NB LOCAL LANES)
ELECTRICAL INFRASTRUCTURE PLANS
SCALE: 1"=50'
DATE: 06/09/06
DRAWN BY: JDC
CHECKED BY: RS

EI-47

12/25/09 PM
6/7/2006