

F. A. NO.	SECTION	COUNTY	TOTAL SHEETS	SHEET NO.
90/94	*	COOK	665	457
STA.	TO STA.			
FED. ROAD DIST. NO. 1	ILLINOIS	FED. AID PROJECT		
62301	*(2021-922 PT2 ETC 2324.8-1P) R-10			

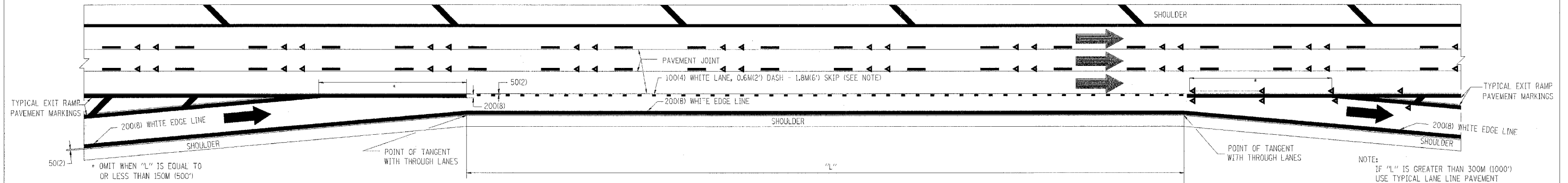

**TYPICAL ENTRANCE/EXIT RAMP COMBINATION PAVEMENT MARKINGS**

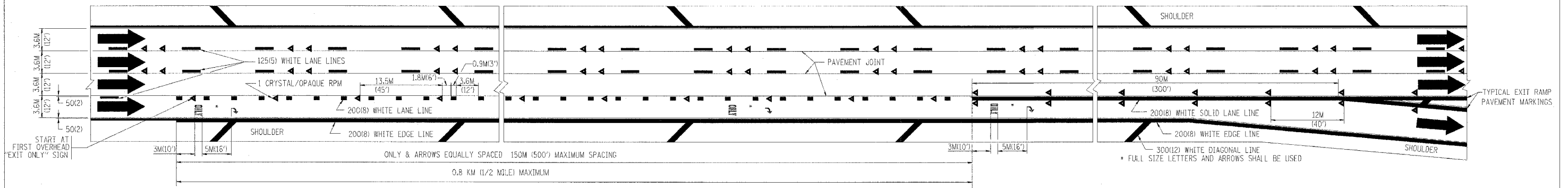

**TYPICAL EXIT ONLY LANE PAVEMENT MARKINGS**

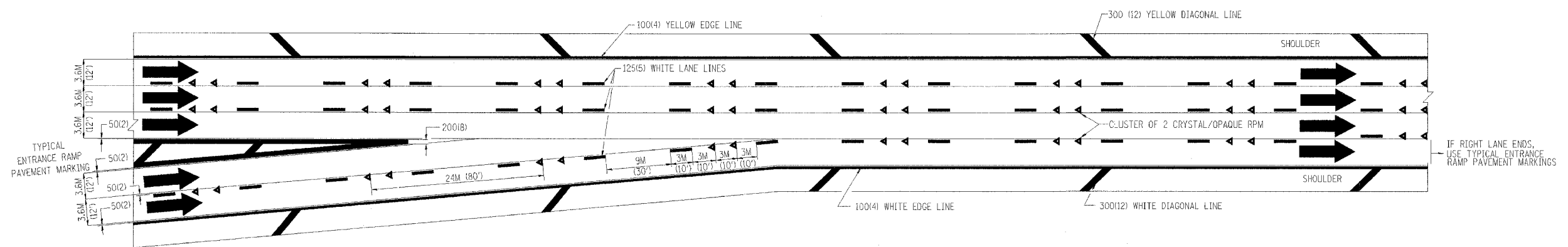

**TYPICAL TWO LANE ENTRANCE RAMP PAVEMENT MARKINGS**

REVISIONS	
NAME	DATE
DWS	1/90
DWS	5/91

ILLINOIS DEPARTMENT OF TRANSPORTATION

**MULTI-LANE FREEWAY  
PAVEMENT MARKING  
DETAILS**

SCALE: NONE  
DATE: 10/18/2002

DRAWN BY C.A.D.D.

CHECKED BY

TC12 SHEET 2 OF 2

REVISION DATE: 01/01/96