

| | | | | |
|-----------------------|---------|------------------------------------|------------------|-----------|
| F. A. REC. | SECTION | COUNTY | TOTAL SHEETS | SHEET NO. |
| 9094 | * | COOK | 565 | 459 |
| STA. | | TO STA. | | |
| FED. ROAD DIST. NO. 1 | | ILLINOIS | FED. AID PROJECT | |
| 62301 | | *(2021-422 PT2 ETC 2324 6-1P) R-10 | | |

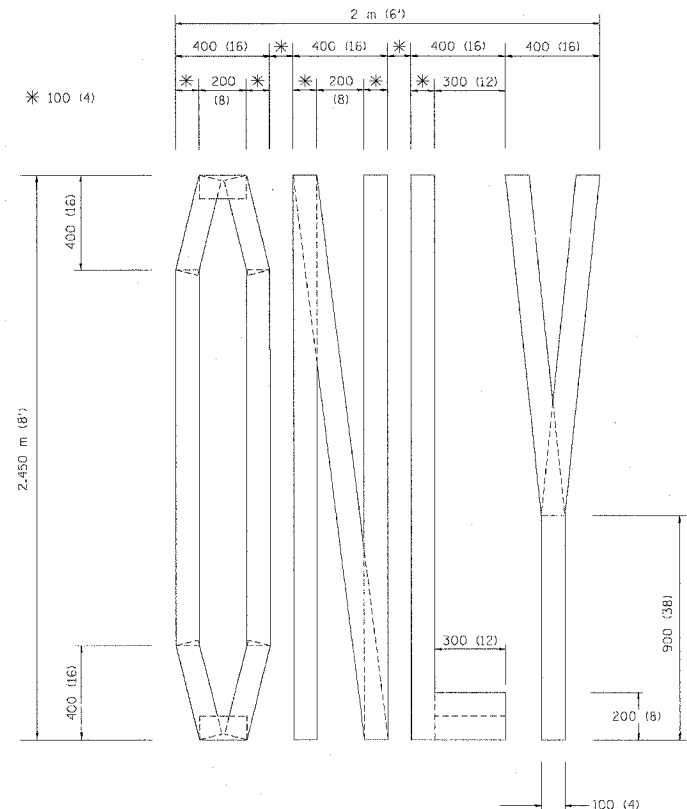

QUANTITY
 100 (4) LINE = 19.7 m (64.1 ft.)
 1.97 sq. m (21.1 sq. ft.)

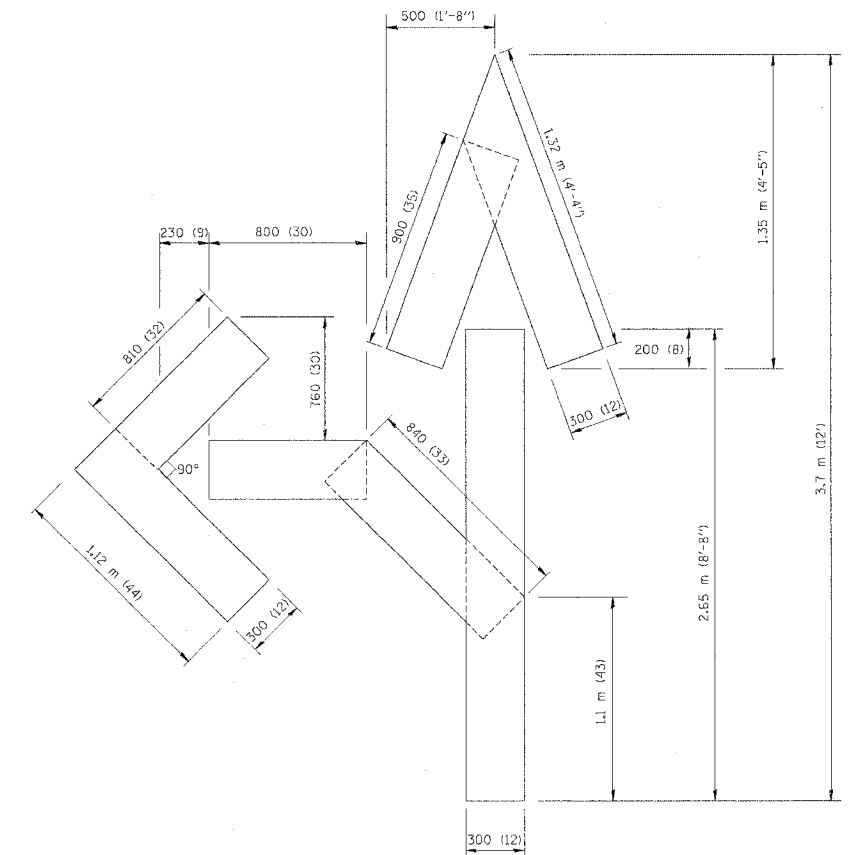

QUANTITY
 100 (4) LINE = 25.3 m (82.5 ft.)
 2.53 sq. m (27.5 sq. ft.)

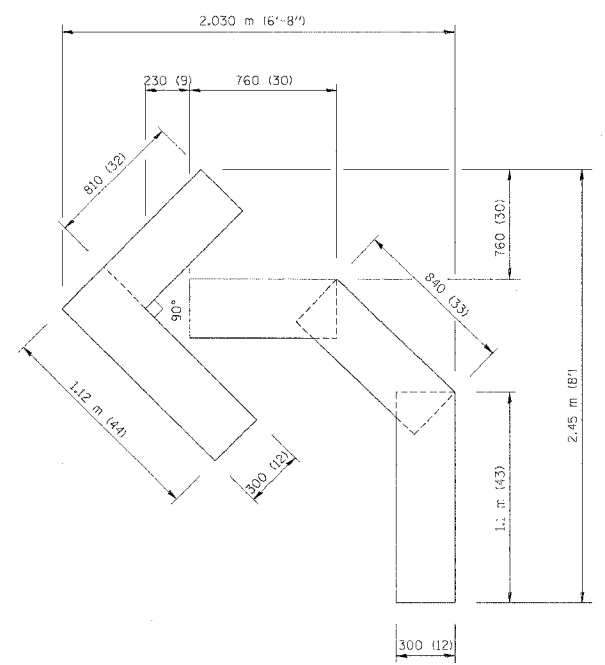

QUANTITY
 100 (4) LINE = 13.9 m (45.5 ft.)
 1.39 sq. m (15.2 sq. ft.)

All dimensions are in millimeters (inches) unless otherwise shown.

ILLINOIS DEPARTMENT OF TRANSPORTATION

PAVEMENT MARKING LETTERS AND SYMBOLS FOR TRAFFIC STAGING

| REVISIONS | | |
|--------------|----------|--|
| NAME | DATE | |
| T. RAMMACHER | 09/18/94 | |
| J. OBERLE | 06/01/96 | |
| T. RAMMACHER | 06/05/96 | |
| T. RAMMACHER | 11/04/97 | |
| T. RAMMACHER | 03/02/98 | |
| E. GOMEZ | 06/28/00 | |

SCALE: NONE
 DATE: 10/18/2002

DRAWN BY CADD
 CHECKED BY TC-16