

F.A.I.	SECTION	COUNTY	TOTAL SHEETS	SHEET NO.
94/90		COOK	588	88
STA.		TO STA.		
FED. ROAD DIST. NO.	ILLINOIS	FED. AID PROJECT		
62303 • (2021-922 PT2 ETC 2324.6-1P) R-11				



HIGHWAY STANDARD 701411
 'LANE CLOSURE, MULTILANE,
 AT ENTRANCE OR EXIT RAMP,
 FOR SPEEDS >= 45 MPH

USE IDOT DISTRICT STD TC-9 "TRAFFIC
 CONTROL DEVICES FOR FREEWAY SINGLE &
 MULTI-LANE WEAVE"

W2-1115(0)-3618, R2-1, W13-3, R5-1, W4-1, W5-4,
 W4-3 AND R2-1106-3618 INCLUDED IN "TRAFFIC
 CONTROL AND PROTECTION "EXPRESSWAYS"

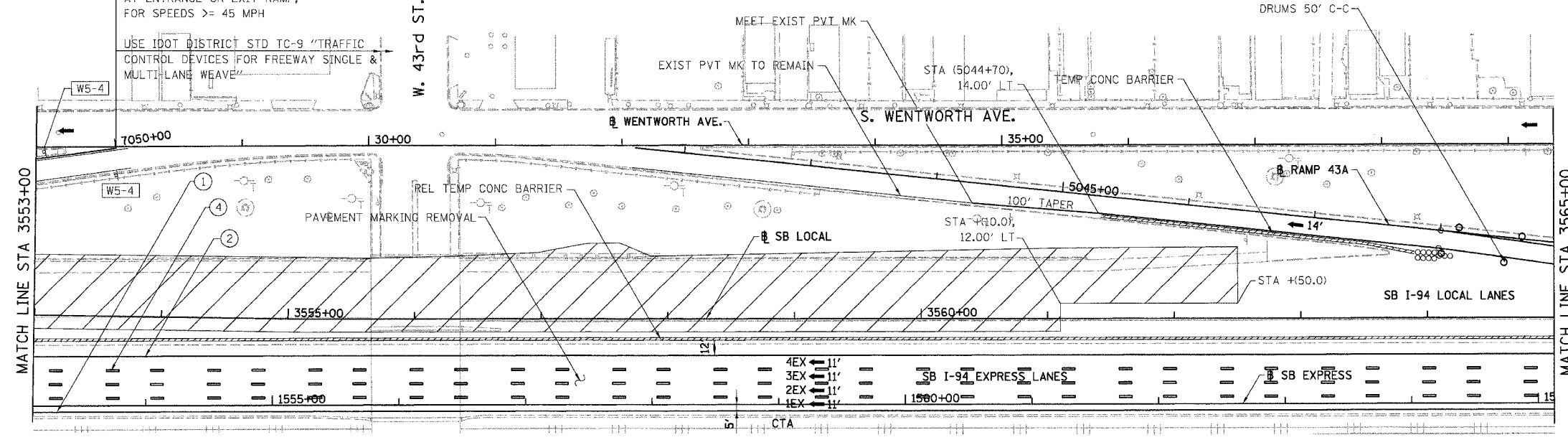

- LEGEND:**
- 1 → LANE NUMBER AND DIRECTION OF TRAFFIC
 - ▨ WORK AREA
 - ▨ TEMPORARY PAVEMENT
 - ⊙ IMPACT ATTENUATORS, TEMPORARY (NON-REDIRECTIVE), TEST LEVEL 3
 - ⊙ DRUM OR BARRICADE TYPE II WITH STEADY BURNING LIGHT
 - ⊙ BARRICADE TYPE III
 - ▬ TEMPORARY CONCRETE BARRIER
 - ① LINE 4" (YELLOW EDGE)
 - ② LINE 4" (WHITE EDGE)
 - ③ LINE 4" (SKIP DASH, 6' SKIP - 2' DASH, WHITE)
 - ④ LINE 5" (SKIP DASH, 30' SKIP - 10' DASH, WHITE)
 - ⑤ LINE 8" (WHITE GORE LINE)
 - ⑥ LINE 8" (SKIP DASH, 12' SKIP - 3' DASH, WHITE)
 - ⑦ LINE 12" (DIAGONAL, 30' C-C, WHITE)
 - ⑧ LETTERS AND SYMBOLS
 - ES-XXX-XX EXISTING OVERHEAD OR CANTILEVER SIGNS
 - GS-XXX-XX EXISTING POST MOUNTED SIGNS
 - TS-XXX-XX TEMPORARY SIGNS

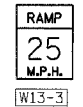
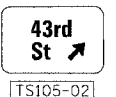

W2-1115(0)-3618, R2-1, W13-3, R5-1, W4-1, W5-4,
 W4-3 AND R2-1106-3618 INCLUDED IN "TRAFFIC
 CONTROL AND PROTECTION "EXPRESSWAYS"

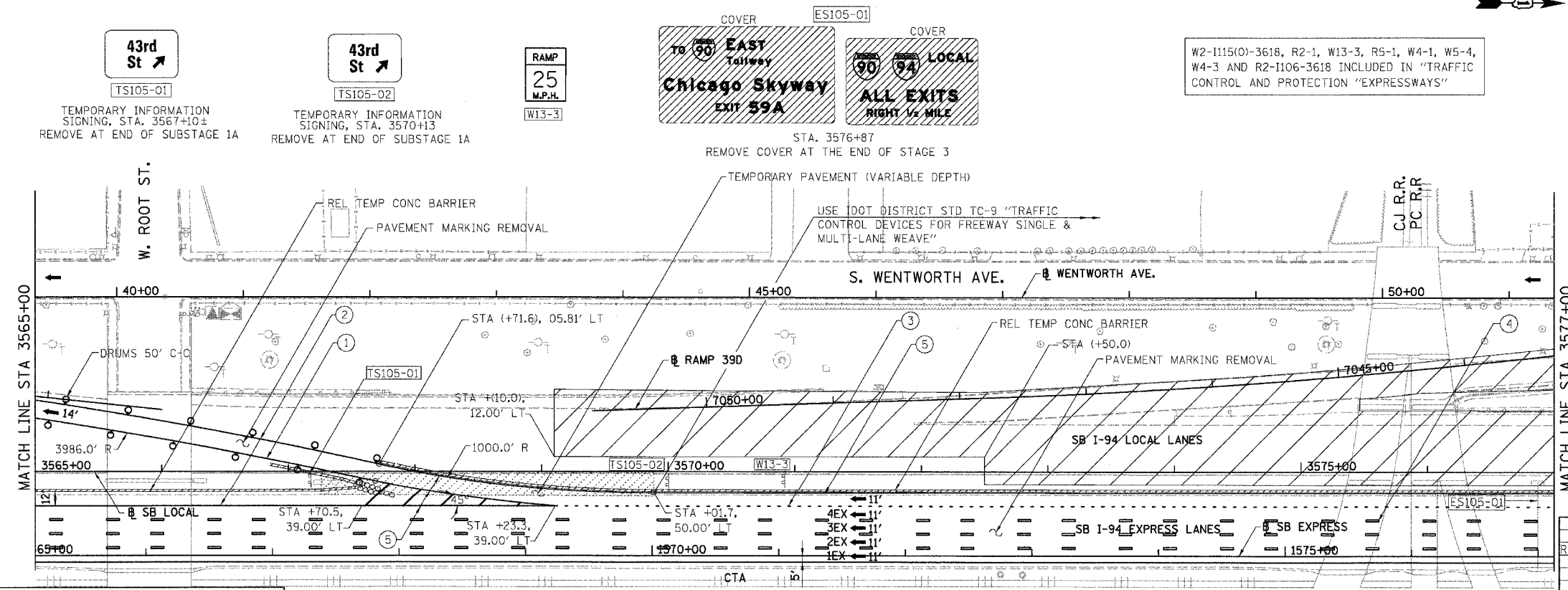

BOWMAN, BARRETT & ASSOCIATES INC.
 CONSULTING ENGINEERS
 Chicago, Illinois
 312.228.0100
 www.bbandainc.com

SB I-94/90 EXPRESS LANES TEMPORARY PAVEMENT MARKINGS INSTALLED IN STAGE I
 TO REMAIN TO END OF STAGE 3, UNLESS OTHERWISE SPECIFIED IN SUBSTAGE 1A.

REVISIONS	NAME	DATE
REVISED SHEET		8/23/06

ILLINOIS DEPARTMENT OF TRANSPORTATION
 F.A.I. 94/90 (DAN RYAN EXPRESSWAY)
 GARFIELD BLVD TO 31ST STREET (SB LOCAL LANES)
 SUGGESTED STAGES OF CONSTRUCTION
 AND TRAFFIC CONTROL
 STAGE I

SCALE: 1"=50'
 DATE: 06/09/06

DRAWN BY: RA
 CHECKED BY: RS

6/23/2006 2:00:55 PM