

F.A.I.	SECTION	COUNTY	TOTAL SHEETS	SHEET NO.
94/90		COOK	588	414
STA.		TO STA.		
62303		*12021-922 PT2 ETC 2324.6-1P1 R-11		

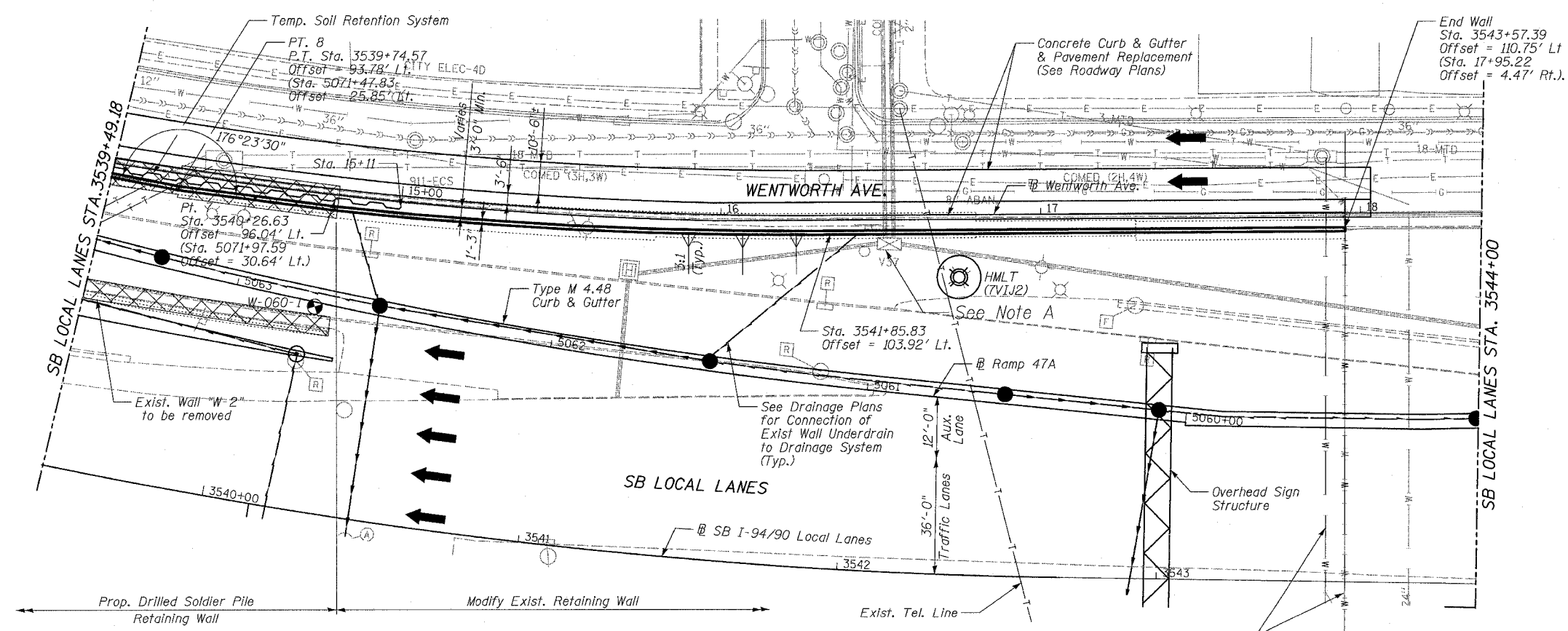
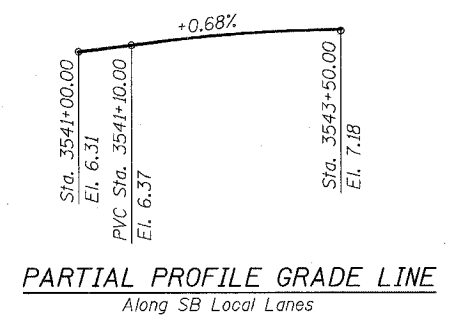
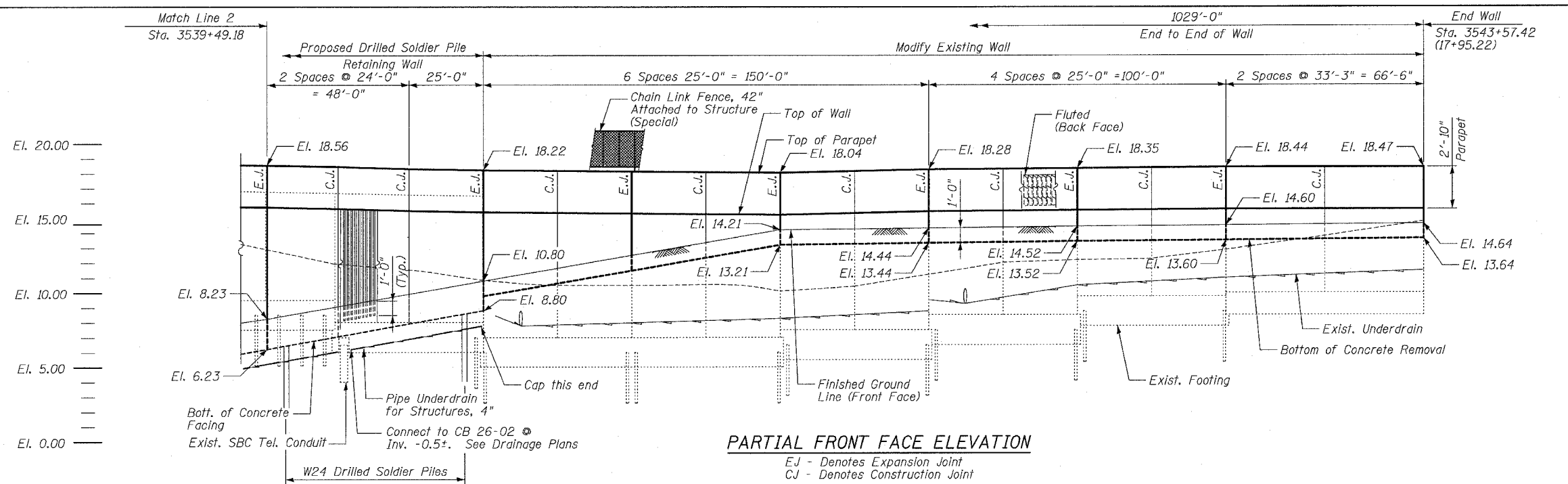

LEGEND

- Soil Boring Location
- Proposed Drainage Structure
- Proposed Underdrain
- Proposed Storm Sewer
- High Mast Lighting Foundation and Tower (See Notes on Sheet 1)
- Removal of Exist. Structures

REVISIONS

NAME	DATE
REVISED	6/14/06

SHEET 3 OF 24

ILLINOIS DEPARTMENT OF TRANSPORTATION
 F.A.I. 94/90 (DAN RYAN EXPRESSWAY)
 GARFIELD BLVD TO 31ST STREET (SB LOCAL LANES)
 COOK COUNTY
 STA. 3532+90.57 TO STA. 3543+57.42
 RETAINING WALL S-45S-F
 GENERAL PLAN & ELEVATION 3
 S.N. 016-W978

SCALE: NTS
 DATE: JUNE 9, 2006
 DRAWN BY: MTR
 CHECKED BY: BLU

BOWMAN, BARRETT & ASSOCIATES INC.
 CONSULTING ENGINEERS
 Chicago, Illinois
 312.228.0100
 www.bbandainc.com

Note A: Existing Lighting controller to be relocated. Coordinate with Contractor 62583 and electrical contractor as required.

12/3/2006 6/23/2006