

ROUTE NO.	SECTION	COUNTY	SHEETS	SHEET	SHEET NO.
F.A.P. 326	0910-IBR-84	KANE	62	23	32 SHEETS
FED. ROAD DIST. NO. 7	T.A.LINETS	FED. AID PROJECT			

Contract #62531  
 ISTHA Contract #RR-02-5129  
 ISTHA Bridge No. 1101

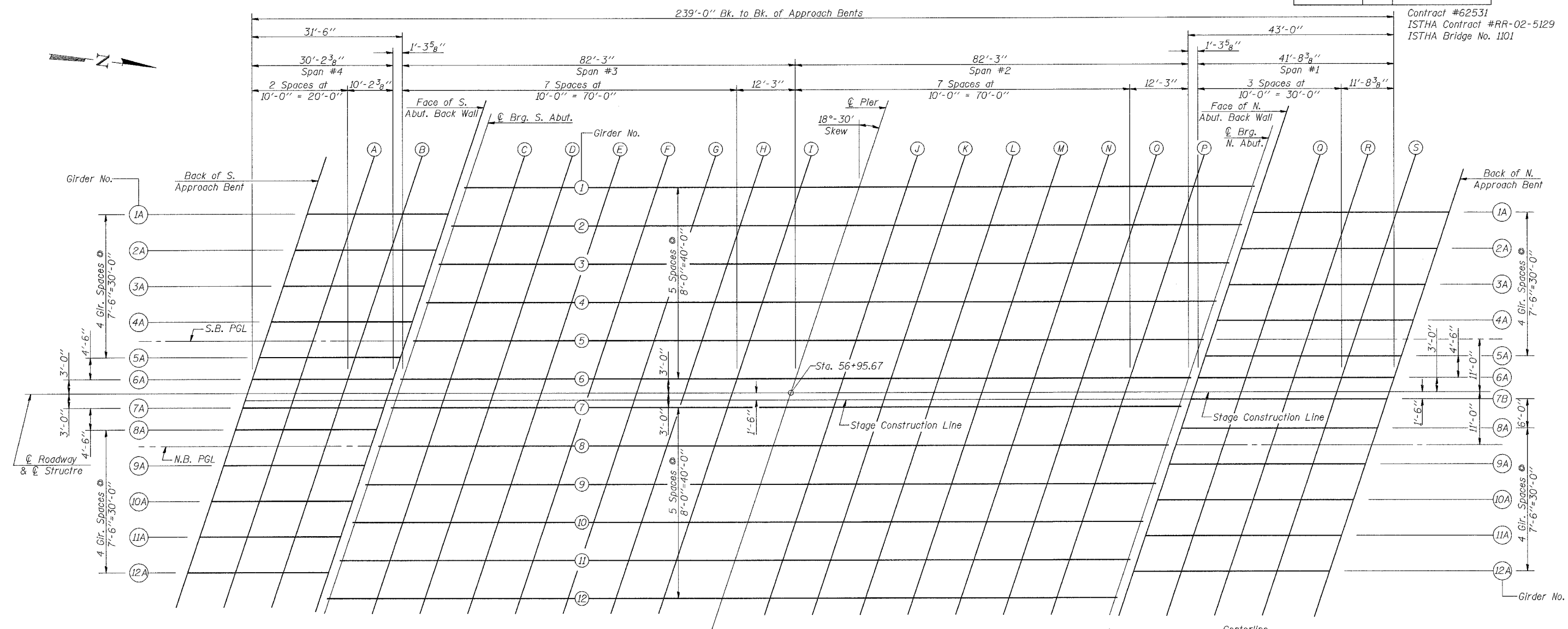

**PLAN**

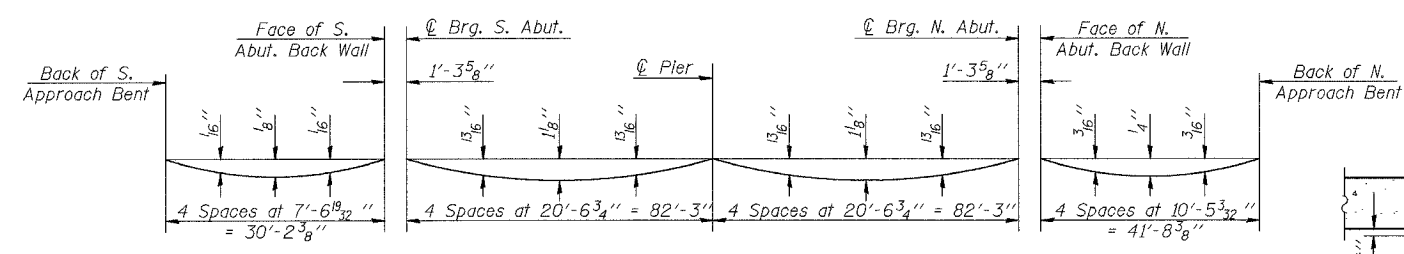

**DEAD LOAD DEFLECTION DIAGRAM**  
 (Includes weight of concrete, excluding beams).

Note: The above deflections are not to be used in the field if the engineer is working from the grade elevations adjusted for dead load deflections as shown on Sheets 6 thru 9 of 32.

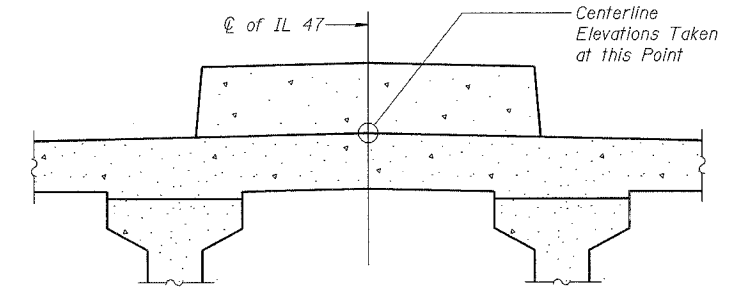

**SECTION THRU MEDIAN**

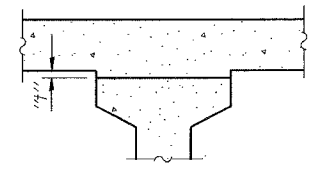

**FILLET HEIGHTS**

To determine "t": After all precast prestressed beams have been erected, elevations of the top flanges of the beams shall be taken at intervals shown on the plan above. These elevations subtracted from the "Theoretical Grade Elevations Adjusted for Dead Load Deflections" minus slab thickness, equals the fillet heights "t" above top flanges of beams.

**rjngroup**  
 Excellence through Ownership  
 200 West Front Street  
 Wheaton, IL 60187

ILLINOIS DEPARTMENT OF TRANSPORTATION  
 TOP OF SLAB ELEVATIONS - I  
 IL RTE. 47 OVER I-88 (E-W TOLLWAY)  
 KANE COUNTY  
 STRUCTURE NO. 045-0082

DATE: 2-01-2006  
 DRAWN BY WJV  
 CHECKED BY BLB

K:\118221\Structures\IL-47.dwg: 1:865 (incl. Plans) Review.dgn 5/2/2006