

F.A.I.	SECTION	COUNTY	TOTAL SHEETS	SHEET NO.
94/90	2003-0295	COOK	344	18
STA.		TO STA.		
FED. ROAD DIST. NO.		ILLINOIS FED. AID PROJECT		
62581				

CURVE EBLCL1
PI STA. = 132+91.17
N:1889095.35
E:1171624.77
Δ = 13° 35' 27" (RT)
D = 2° 30' 00"
R = 2,291.82'
T = 273.10'
L = 543.63'
E = 16.21'
e = N/A
T.R. = -----
S.E. RUN = 0.045 FT/FT
P.C. STA. = 130+18.07
N:1888846.65
E:1171737.58
P.T. STA. = 135+61.70
N:1889363.61
E:1171573.55

CURVE EBLCL2
PI STA. = 135+98.36
N:1889399.61
E:1171566.67
Δ = 3° 18' 16" (RT)
D = 4° 30' 30"
R = 1,270.92'
T = 36.66'
L = 73.30'
E = 0.53'
e = N/A
T.R. = -----
S.E. RUN = 0.066 FT/FT
P.C. STA. = 135+61.70
N:1889363.61
E:1171573.55
P.T. STA. = 136+35.00
N:1889435.96
E:1171561.89

CURVE EBLCL3
PI STA. = 138+65.73
N:1889668.47
E:1171527.14
Δ = 20° 53' 29" (RT)
D = 4° 29' 38"
R = 1,275.00'
T = 235.06'
L = 464.90'
E = 21.49'
e = N/A
T.R. = -----
S.E. RUN = 0.066 FT/FT
P.C. STA. = 136+30.67
N:1889435.43
E:1171557.84
P.T. STA. = 140+95.57
N:1889897.14
E:1171581.56

CURVE EBCNL1
PI STA. = 8+26.39
N:1889165.88
E:1171643.11
Δ = 21° 11' 19" (RT)
D = 2° 44' 16"
R = 2,092.71'
T = 391.42'
L = 773.91'
E = 36.29'
e = N/A
T.R. = -----
S.E. RUN = 0.042 FT/FT
P.C. STA. = 4+34.96
N:1888806.58
E:1171798.38
P.T. STA. = 12+08.87
N:1889557.02
E:1171628.20

CURVE EBCNL2
PI STA. = 13+73.30
N:1889721.34
E:1171621.93
Δ = 8° 20' 29" (RT)
D = 5° 26' 41"
R = 1,052.30'
T = 76.73'
L = 153.20'
E = 2.79'
e = N/A
T.R. = -----
S.E. RUN = 0.042 FT/FT
P.C. STA. = 12+96.57
N:1889644.66
E:1171624.86
P.T. STA. = 14+49.77
N:1889797.63
E:1171630.17

CURVE WBCNL1
PI STA. = 9+99.17
N:1888778.07
E:1171931.76
Δ = 12° 06' 39" (RT)
D = 6° 47' 05"
R = 844.49'
T = 89.59'
L = 178.50'
E = 4.74'
e = N/A
T.R. = -----
S.E. RUN = 0.066 FT/FT
P.C. STA. = 9+09.59
N:1888696.49
E:1171968.76
P.T. STA. = 10+88.09
N:1888865.60
E:1171912.69

CURVE WBCNL2
PI STA. = 16+05.28
N:1889370.95
E:1171802.61
Δ = 10° 18' 26" (RT)
D = 4° 30' 00"
R = 1,273.24'
T = 114.84'
L = 229.05'
E = 5.17'
e = N/A
T.R. = -----
S.E. RUN = 0.042 FT/FT
P.C. STA. = 14+90.45
N:1889258.74
E:1171827.05
P.T. STA. = 17+19.50
N:1889485.71
E:1171798.64

CURVE WBCNL3
PI STA. = 21+18.55
N:1889884.68
E:1171789.81
Δ = 19° 57' 27" (RT)
D = 6° 00' 00"
R = 954.93'
T = 168.01'
L = 332.63'
E = 14.67'
e = N/A
T.R. = -----
S.E. RUN = 0.066 FT/FT
P.C. STA. = 19+50.53
N:1889716.68
E:1171792.26
P.T. STA. = 22+83.16
N:1890043.42
E:1171844.85

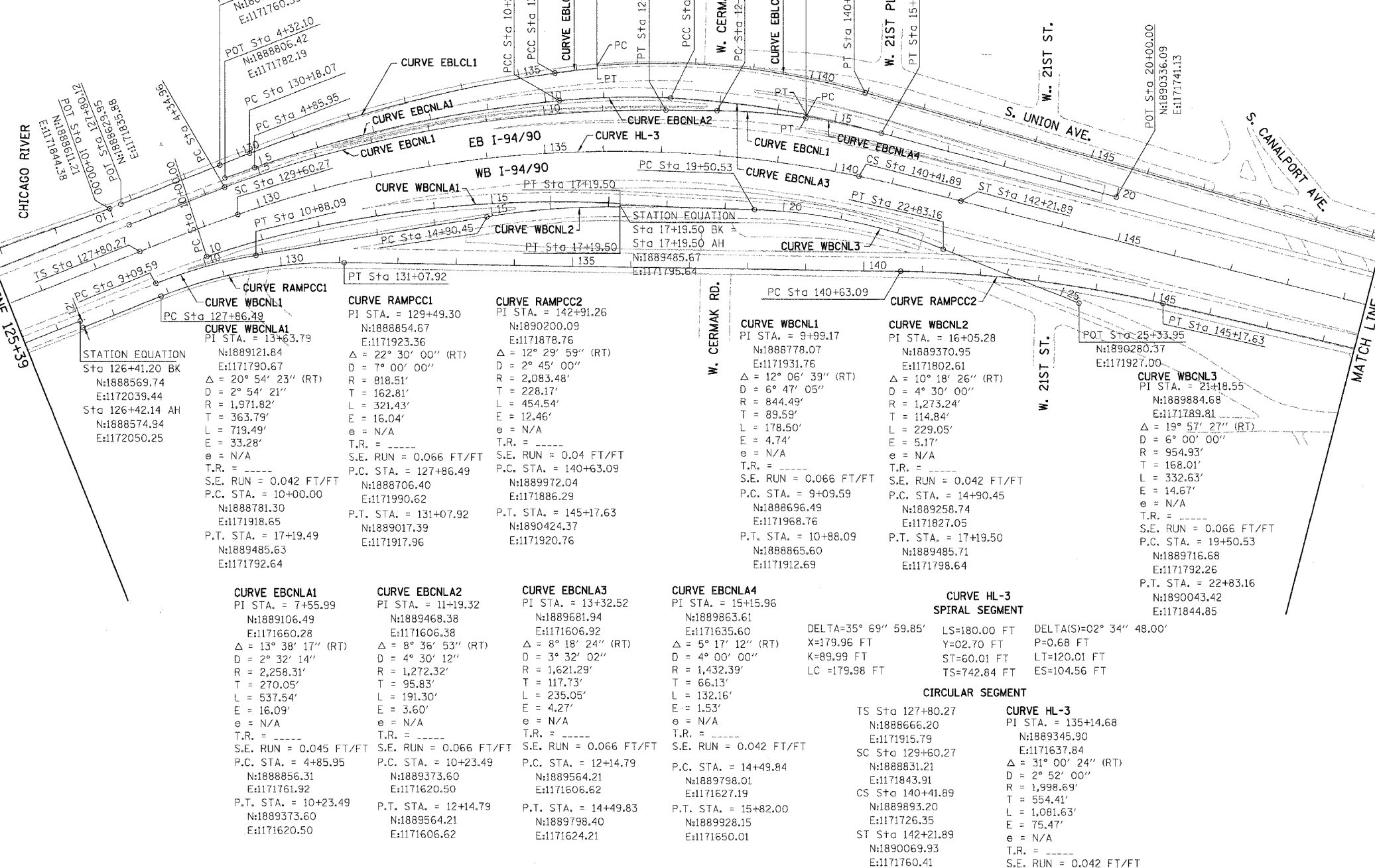

CURVE EBCNL1A1
PI STA. = 7+55.99
N:1889106.49
E:1171660.28
Δ = 13° 38' 17" (RT)
D = 2° 32' 14"
R = 2,258.31'
T = 270.05'
L = 537.54'
E = 16.09'
e = N/A
T.R. = -----
S.E. RUN = 0.045 FT/FT
P.C. STA. = 4+85.95
N:1888856.31
E:1171761.92
P.T. STA. = 10+23.49
N:1889373.60
E:1171620.50

CURVE EBCNL2A1
PI STA. = 11+19.32
N:1889468.38
E:1171606.38
Δ = 8° 36' 53" (RT)
D = 4° 30' 12"
R = 1,272.32'
T = 95.83'
L = 191.30'
E = 3.60'
e = N/A
T.R. = -----
S.E. RUN = 0.066 FT/FT
P.C. STA. = 10+23.49
N:1889373.60
E:1171620.50
P.T. STA. = 12+14.79
N:1889564.21
E:1171606.62

CURVE EBCNL3A1
PI STA. = 13+32.52
N:1889681.94
E:1171606.92
Δ = 8° 18' 24" (RT)
D = 3° 32' 02"
R = 1,621.29'
T = 117.73'
L = 235.05'
E = 4.27'
e = N/A
T.R. = -----
S.E. RUN = 0.066 FT/FT
P.C. STA. = 12+14.79
N:1889564.21
E:1171606.62
P.T. STA. = 14+49.83
N:1889798.40
E:1171624.21

CURVE EBCNL4A1
PI STA. = 15+15.96
N:1889863.61
E:1171635.60
Δ = 5° 17' 12" (RT)
D = 4° 00' 00"
R = 1,432.39'
T = 66.13'
L = 132.16'
E = 1.53'
e = N/A
T.R. = -----
S.E. RUN = 0.042 FT/FT
P.C. STA. = 14+49.84
N:1889798.01
E:1171627.19
P.T. STA. = 15+82.00
N:1889928.15
E:1171650.01

CURVE EBCNL1A2
PI STA. = 13+63.79
N:1889121.84
E:1171790.67
Δ = 20° 54' 23" (RT)
D = 2° 54' 21"
R = 1,971.82'
T = 363.79'
L = 719.49'
E = 33.28'
e = N/A
T.R. = -----
S.E. RUN = 0.042 FT/FT
P.C. STA. = 10+00.00
N:1888781.30
E:1171918.65
P.T. STA. = 17+19.49
N:1889485.63
E:1171792.64

CURVE EBCNL2A2
PI STA. = 129+49.30
N:1888854.67
E:1171923.36
Δ = 22° 30' 00" (RT)
D = 7° 00' 00"
R = 818.51'
T = 162.81'
L = 321.43'
E = 16.04'
e = N/A
T.R. = -----
S.E. RUN = 0.066 FT/FT
P.C. STA. = 127+86.49
N:1888706.40
E:1171990.62
P.T. STA. = 131+07.92
N:1889017.39
E:1171917.96

CURVE EBCNL3A2
PI STA. = 142+91.26
N:1890200.09
E:1171878.76
Δ = 12° 29' 59" (RT)
D = 2° 45' 00"
R = 2,083.48'
T = 228.17'
L = 454.54'
E = 12.46'
e = N/A
T.R. = -----
S.E. RUN = 0.04 FT/FT
P.C. STA. = 140+63.09
N:1889972.04
E:1171886.29
P.T. STA. = 145+17.63
N:1890424.37
E:1171920.76

CURVE HL-3 SPIRAL SEGMENT
DELTA=35° 69' 59.85'
X=179.96 FT
K=89.99 FT
LC=179.98 FT

CURVE HL-3 CIRCULAR SEGMENT
LS=180.00 FT
Y=02.70 FT
ST=60.01 FT
TS=742.84 FT

CURVE HL-3
PI STA. = 135+14.68
N:1889345.90
E:1171637.84
Δ = 31° 00' 24" (RT)
D = 2° 52' 00"
R = 1,998.69'
T = 554.41'
L = 1,081.63'
E = 75.47'
e = N/A
T.R. = -----
S.E. RUN = 0.042 FT/FT

REVISIONS	
NAME	DATE

ILLINOIS DEPARTMENT OF TRANSPORTATION
F.A.I. 94/90 (DAN RYAN EXPRESSWAY)
SB DAN RYAN ELEVATED BRIDGE
REPAIR FROM 15TH TO 28TH STREETS
ALIGNMENT PLAN
STA. 125+39 TO STA. 149+39

SCALE: 1"=100'
DATE: 4/14/2006

DRAWN BY: RA
CHECKED BY: RS

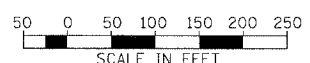

BOWMAN, BARRETT & ASSOCIATES INC.
CONSULTING ENGINEERS
Chicago, Illinois
312.228.0100
www.bbafinc.com

CAL05
4/14/2006
94056 AM