

F.A.I.	SECTION	COUNTY	TOTAL SHEETS	SHEET NO.
94/90	2003-0298	COOK	344	66
STA.	TO STA.			
FED. ROAD DIST. NO.	ILLINOIS	FED. AID PROJECT		
62581				

MATCH LINE X-X

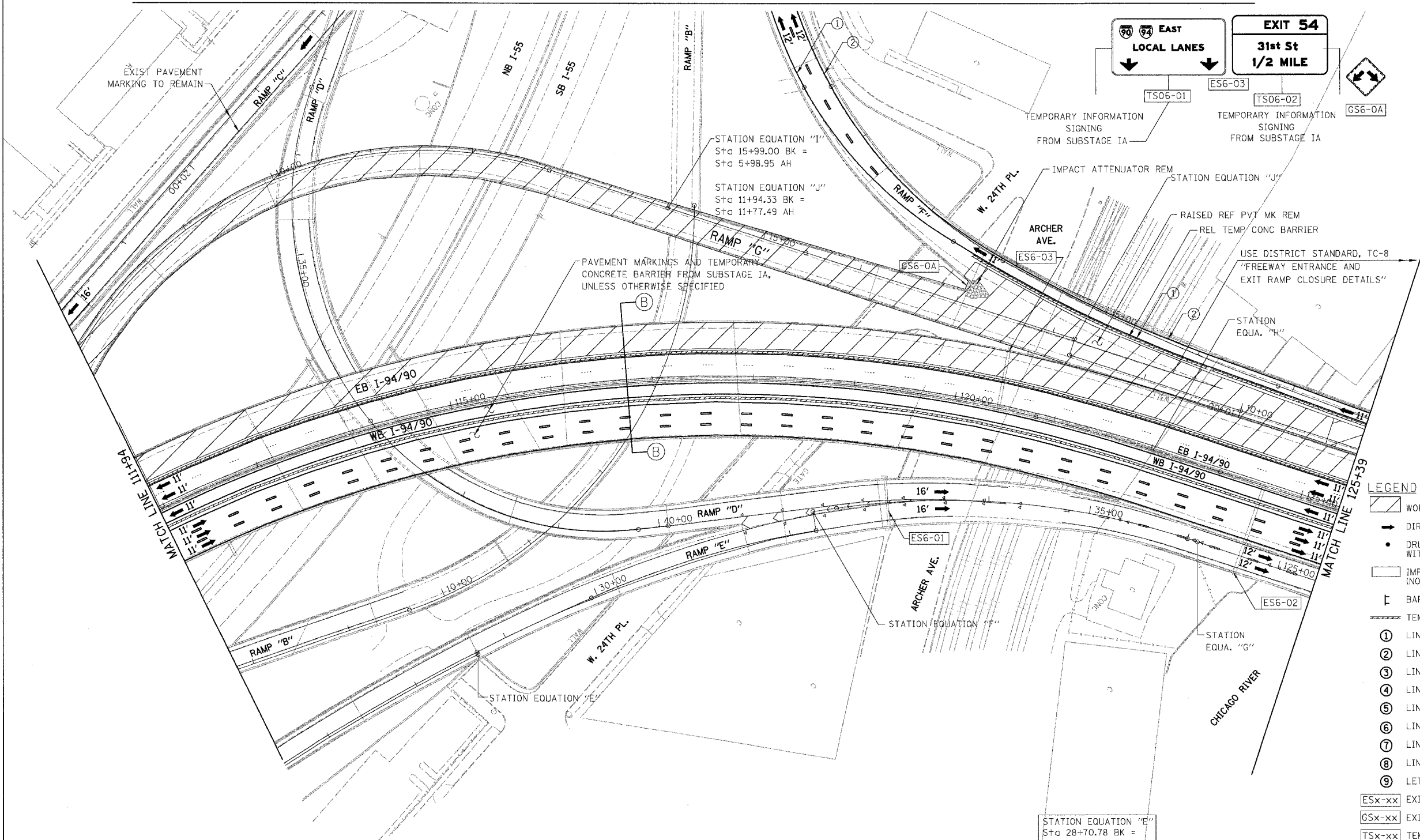

- LEGEND**
- WORK ZONE
  - DIRECTION OF TRAFFIC
  - DRUM OR BARRICADE TYPE II WITH STEADY BURN LIGHT
  - IMPACT ATTENUATORS, TEMPORARY (NON-REDIRECTIVE), TEST LEVEL 3
  - BARRICADE TYPE III
  - TEMPORARY CONCRETE BARRIER
  - LINE 4" (YELLOW EDGE LINE)
  - LINE 4" (WHITE EDGE LINE)
  - LINE 4" (SKIP DASH, 6' SKIP - 2' DASH, WHITE)
  - LINE 5" (SKIP DASH, 30' SKIP - 10' DASH, WHITE)
  - LINE 8" (WHITE LINE)
  - LINE 8" (SKIP DASH, 12' SKIP - 3' DASH, WHITE)
  - LINE 12" (DIAGONAL, 30' C-C)
  - LINE 12" (DIAGONAL, 500' C-C)
  - LETTERS AND SYMBOLS
  - EXISTING OVERHEAD OR CANTILEVER SIGNS
  - EXISTING POST MOUNTED SIGNS
  - TEMPORARY SIGNS

**EXIT 53A**  
**Canalport Ave**  
**Cermak Rd**  
**LEFT 1/4 MILE**

**WEST**  
**Wisconsin**  
 Ryan Expy

**DMS**

STATION EQUATION "E"  
 Sta 28+70.78 BK =  
 Sta 28+68.28 AH

STATION EQUATION "F"  
 Sta 32+25.87 BK =  
 Sta 32+25.87 AH

STATION EQUATION "G"  
 Sta 36+10.50 BK =  
 Sta 124+16.76 AH

STATION EQUATION "H"  
 Sta 15+99.00 BK =  
 Sta 5+98.95 AH

NOTE:  
 ALL PAVEMENT MARKINGS ON THIS SHEET WILL BE PAVEMENT MARKING TAPE, TYPE III, UNLESS OTHERWISE NOTED.

REVISIONS	NAME	DATE

**ILLINOIS DEPARTMENT OF TRANSPORTATION**  
**F.A.I. 94/90 (DAN RYAN EXPRESSWAY)**  
**SB DAN RYAN ELEVATED BRIDGE**  
**REPAIR FROM 15TH TO 28TH STREETS**  
**MAINTENANCE OF TRAFFIC PLAN - SUBSTAGE IC**  
**STA. 111+94 TO STA. 125+39**

SCALE: 1"=50'  
 DATE: 4/14/2006

MOT-36  
 DRAWN BY: RA  
 CHECKED BY: RS

BOWMAN, BARRETT & ASSOCIATES INC  
 CONSULTING ENGINEERS  
 Chicago, Illinois  
 312.228.0100  
 www.bbainc.com

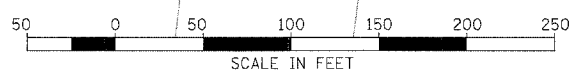

16602622 AM 4/14/2006