

F.A.I.	SECTION	COUNTY	TOTAL SHEETS	SHEET NO.
94/90		COOK	344	97
STA.	TO STA.			
FED. ROAD DIST. NO.	ILLINOIS	FED. AID PROJECT		
62301	*(2021-922 PT2 ETC 2324.6-1P) R-10			

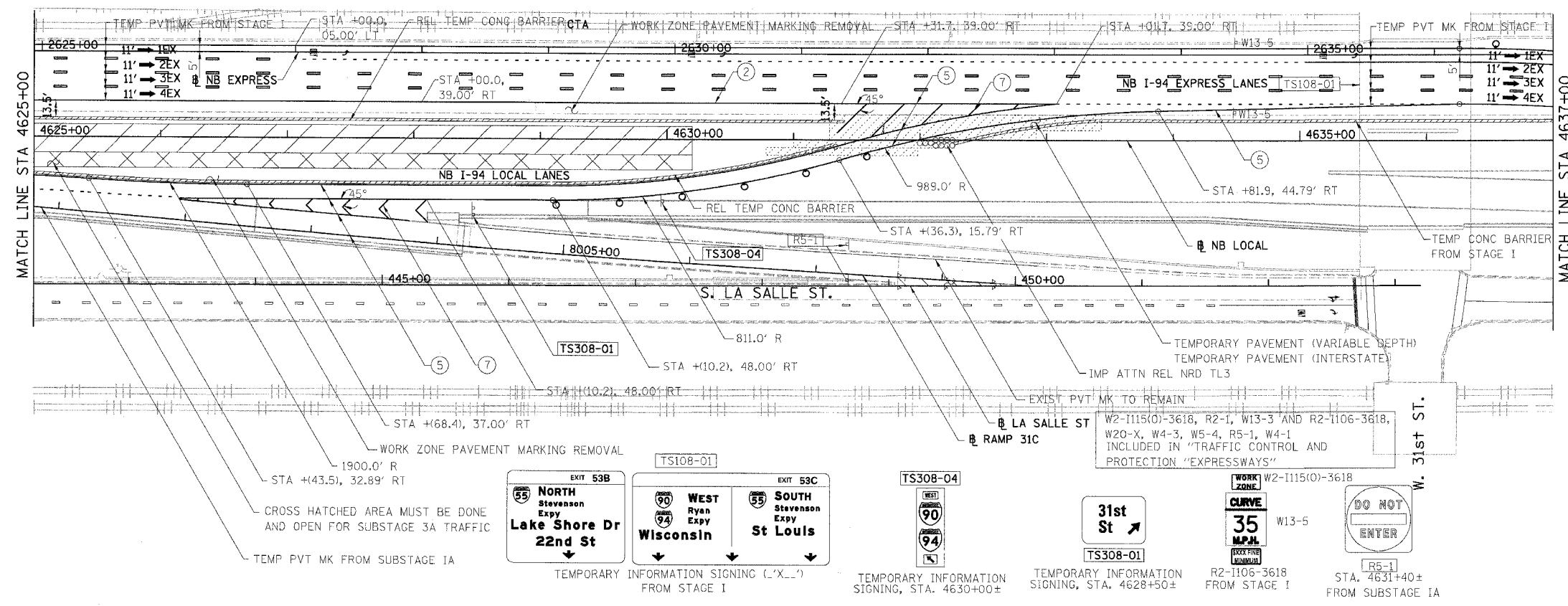

- LEGEND:**
- 1 → LANE NUMBER AND DIRECTION OF TRAFFIC
 - [Hatched Box] WORK AREA
 - [Dashed Box] TEMPORARY PAVEMENT
 - [Symbol] IMPACT ATTENUATORS, TEMPORARY (NON-REDIRECTIVE), TEST LEVEL 3
 - [Symbol] DRUM OR BARRICADE TYPE II WITH STEADY BURNING LIGHT
 - [Symbol] BARRICADE TYPE III
 - [Symbol] TEMPORARY CONCRETE BARRIER
 - ① LINE 4" (YELLOW EDGE)
 - ② LINE 4" (WHITE EDGE)
 - ③ LINE 4" (SKIP DASH, 6' SKIP - 2' DASH, WHITE)
 - ④ LINE 5" (SKIP DASH, 30' SKIP - 10' DASH, WHITE)
 - ⑤ LINE 8" (WHITE GORE LINE)
 - ⑥ LINE 8" (SKIP DASH, 12' SKIP - 3' DASH, WHITE)
 - ⑦ LINE 12" (DIAGONAL, 30' C-C, WHITE)
 - ⑧ LETTERS AND SYMBOLS
 - [ES-XXX-XX] EXISTING OVERHEAD OR CANTILEVER SIGNS
 - [GS-XXX-XX] EXISTING POST MOUNTED SIGNS
 - [TS-XXX-XX] TEMPORARY SIGNS
- +XX.XX STATION PROVIDED FROM THE ± SB I-90/94 EXPRESS LANES
 (+XX.XX) STATION PROVIDED FROM THE ± SB I-90/94 LOCAL LANES

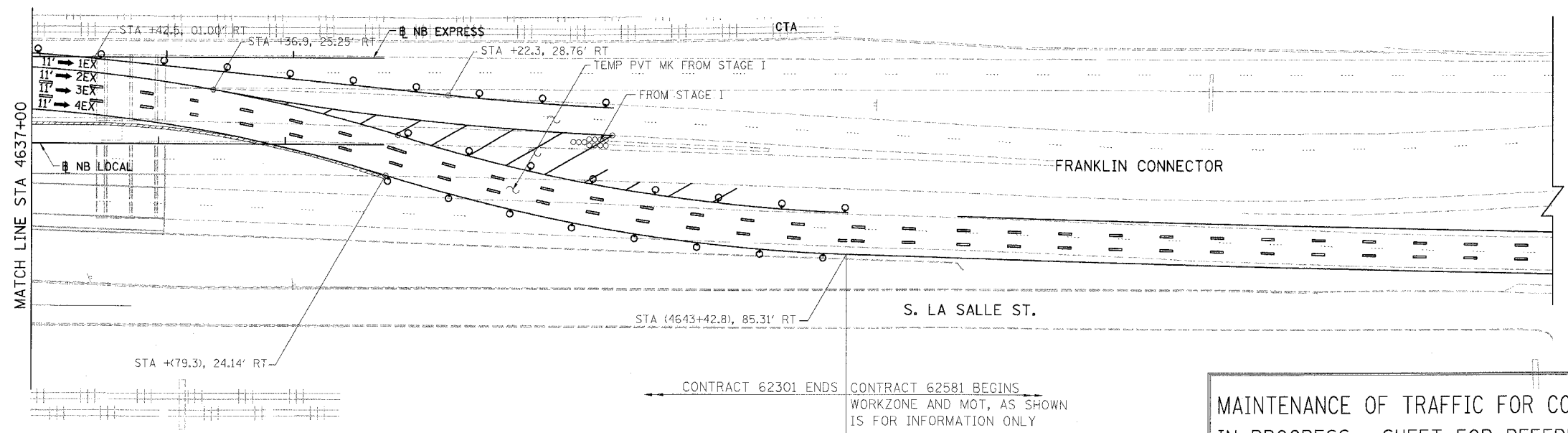

- NOTES:**
- SEE SHEET MOTTS-01 FOR TYPICAL SECTIONS.
 - SEE TEMPORARY SIGN PANEL SHEETS FOR DETAILS.

CONTRACT 62301 STAGE I SHOULD BE READY TO OPEN TO TRAFFIC AT THE SAME TIME THAT CONTRACT 62581 MAINTENANCE OF TRAFFIC, STAGE I IS OPEN TO TRAFFIC. BOTH CONTRACTS SHOULD COORDINATE MAINTENANCE OF TRAFFIC ISSUES AND TEMPORARY SIGNING DURING DIFFERENT MOT STAGES.

MAINTENANCE OF TRAFFIC FOR CONTRACT 62301 IN PROGRESS. SHEET FOR REFERENCE ONLY. SEE FINAL CONTRACT 62301 FOR FINAL INFORMATION.

BOWMAN, BARRETT & ASSOCIATES INC.
 CONSULTING ENGINEERS
 Chicago, Illinois
 312.228.0100
 www.bbainc.com

NB I-94/90 EXPRESS LANES TEMPORARY PAVEMENT MARKINGS WERE INSTALLED IN STAGES I, 2 AND SUBSTAGE IA, UNLESS OTHERWISE SPECIFIED IN STAGE 3. CROSS OVER RAMP'S TEMPORARY PAVEMENT MARKINGS INSTALLED IN STAGE 3 TO REMAIN TO END OF SUBSTAGE 3A, UNLESS OTHERWISE SPECIFIED IN SUBSTAGE 3A.

REVISIONS	
NAME	DATE

MOT-308
 ILLINOIS DEPARTMENT OF TRANSPORTATION
 F.A.I. 94/90 (DAN RYAN EXPRESSWAY)
 GARFIELD BLVD TO 31ST STREET (NB LOCAL LANES)
 SUGGESTED STAGES OF CONSTRUCTION AND TRAFFIC CONTROL
 STAGE 3
 SCALE: 1"=50'
 DATE: 5/12/2006
 DRAWN BY: RA
 CHECKED BY: RS