

F.A.I.	SECTION	COUNTY	TOTAL SHEETS	SHEET NO.
94/90	2003-0298	COOK	344	128
STA.		TO STA.		
FED. ROAD DIST. NO.		ILLINOIS FED. AID PROJECT		
62581				

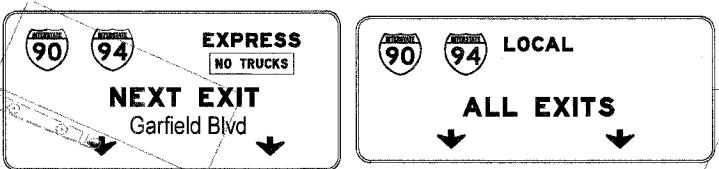
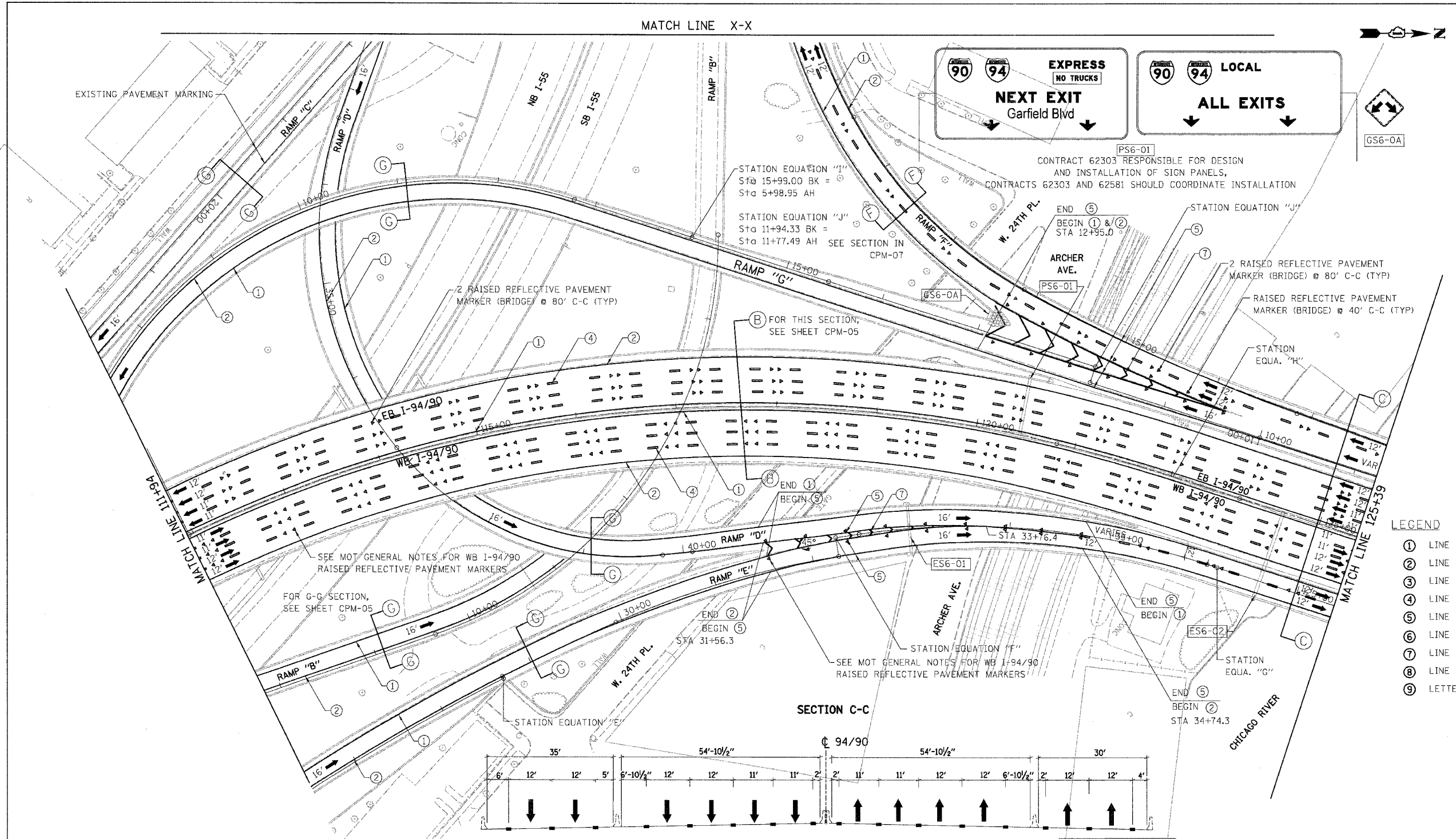

CONTRACT 62303 RESPONSIBLE FOR DESIGN AND INSTALLATION OF SIGN PANELS, CONTRACTS 62303 AND 62581 SHOULD COORDINATE INSTALLATION

STATION EQUATION "I"  
Sta 15+99.00 BK =  
Sta 5+98.95 AH

STATION EQUATION "J"  
Sta 11+94.33 BK =  
Sta 11+77.49 AH SEE SECTION IN CPM-07

STATION EQUATION "J"  
END (5)  
BEGIN (1) & (2)  
STA 12+95.0

2 RAISED REFLECTIVE PAVEMENT MARKER (BRIDGE) @ 80' C-C (TYP)

RAISED REFLECTIVE PAVEMENT MARKER (BRIDGE) @ 40' C-C (TYP)

(B) FOR THIS SECTION, SEE SHEET CPM-05

SEE MOT GENERAL NOTES FOR WB I-94/90 RAISED REFLECTIVE PAVEMENT MARKERS

FOR G-G SECTION, SEE SHEET CPM-05

SEE MOT GENERAL NOTES FOR WB I-94/90 RAISED REFLECTIVE PAVEMENT MARKERS

- LEGEND**
- ① LINE 4" (YELLOW EDGE LINE)
  - ② LINE 4" (WHITE EDGE LINE)
  - ③ LINE 4" (SKIP DASH, 6' SKIP - 2' DASH, WHITE)
  - ④ LINE 5" (SKIP DASH, 30' SKIP - 10' DASH, WHITE)
  - ⑤ LINE 8" (WHITE LINE)
  - ⑥ LINE 8" (SKIP DASH, 12' SKIP - 3' DASH, WHITE)
  - ⑦ LINE 12" (DIAGONAL, 30' C-C)
  - ⑧ LINE 12" (DIAGONAL, 500' C-C)
  - ⑨ LETTERS AND SYMBOLS

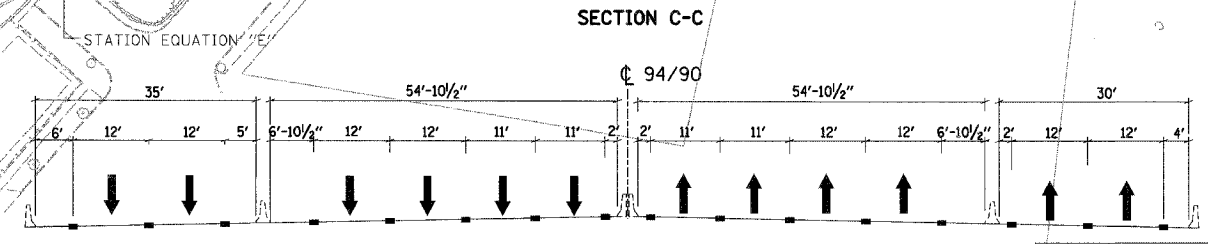

LOOKING NORTH- NOT TO SCALE

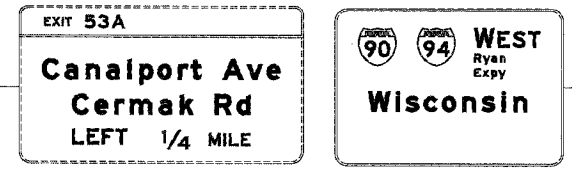

STATION EQUATION "E"  
Sta 28+70.78 BK =  
Sta 28+68.28 AH

STATION EQUATION "F"  
Sta 32+25.87 BK =  
Sta 32+25.87 AH

STATION EQUATION "G"  
Sta 36+10.50 BK =  
Sta 124+16.76 AH

STATION EQUATION "H"  
Sta 15+99.00 BK =  
Sta 5+98.95 AH

NOTE:  
ALL PAVEMENT MARKINGS ON THIS SHEET WILL BE POLYUREA PAVEMENT MARKING TYPE I, UNLESS OTHERWISE NOTED.

REVISIONS	
NAME	DATE

ILLINOIS DEPARTMENT OF TRANSPORTATION  
F.A.I. 94/90 (DAN RYAN EXPRESSWAY)  
SB DAN RYAN ELEVATED BRIDGE  
REPAIR FROM 15TH TO 28TH STREETS  
PROPOSED PAVEMENT MARKING PLAN  
STA. 111+94 TO STA. 125+39

SCALE: 1"=50'  
DATE: 4/14/2006

DRAWN BY: RA  
CHECKED BY: RS

BOWMAN, BARRETT & ASSOCIATES INC.  
CONSULTING ENGINEERS  
Chicago, Illinois  
312.228.0100  
www.bbainc.com

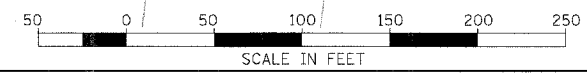

4/14/2006 9:23:51 AM