

F.A.I.	SECTION	COUNTY	TOTAL SHEETS	SHEET NO.
94/90	2003-0298	COOK	344	156
STA.		TO STA.		
FED. ROAD DIST. NO.	ILLINOIS	FED. AID PROJECT		

62581

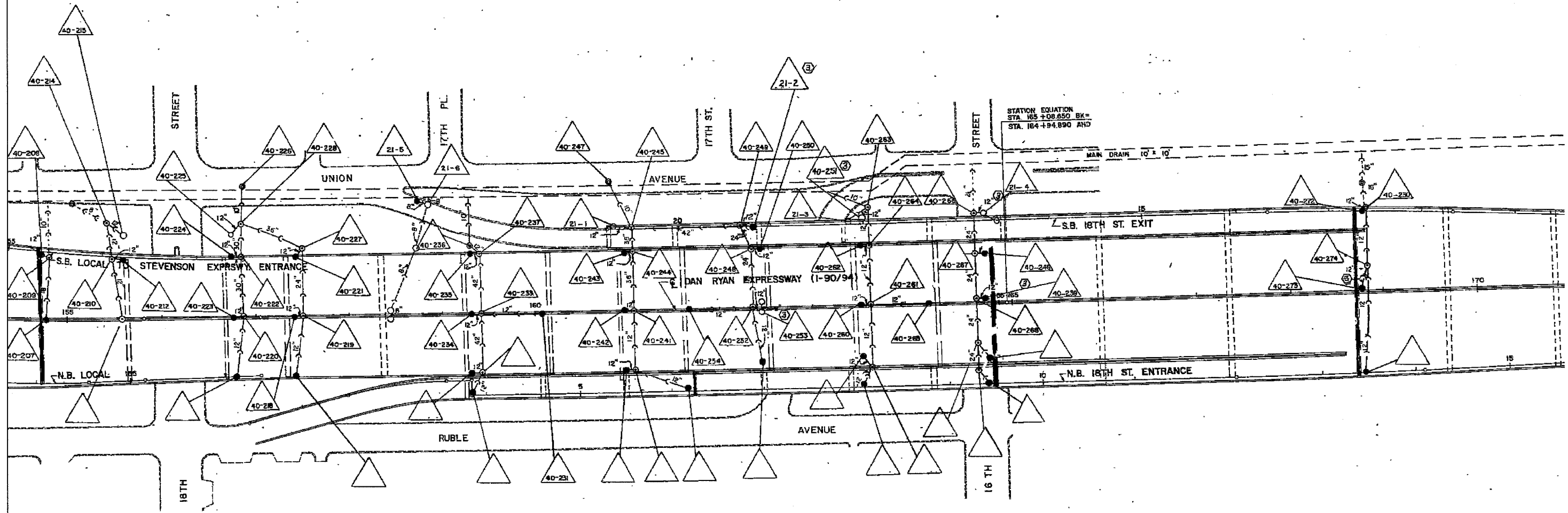
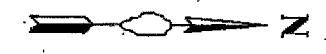

BOWMAN, BARRETT & ASSOCIATES INC.
CONSULTING ENGINEERS
Chicago, Illinois
312.228.0100
www.bbainc.com

FOR INFORMATION ONLY

NOTE:
Information from 1988-89 As-Builts to show probable location of existing catch basins collecting bridge drainage. Field verify location with Engineer. Clean all catch basins receiving drainage from SB viaduct.

REVISIONS	
NAME	DATE

ILLINOIS DEPARTMENT OF TRANSPORTATION
F.A.I. 94/90 (DAN RYAN EXPRESSWAY)
SB DAN RYAN ELEVATED BRIDGE
REPAIR FROM 15TH TO 28TH STREETS
EXISTING DRAINAGE SYSTEM
DETAILS

SCALE: NTS
DATE: 4/14/2006

DRAWN BY: BOC
CHECKED BY: BLU

11/14/2006 10:25:55 AM