

F. A. RILEY	SECTION	COUNTY	TOTAL SHEETS	SHEET NO.
			344	339
STA.		TO STA.		
FED. ROAD DIST. NO. 1		BLINDS		FED. AID PROJECT

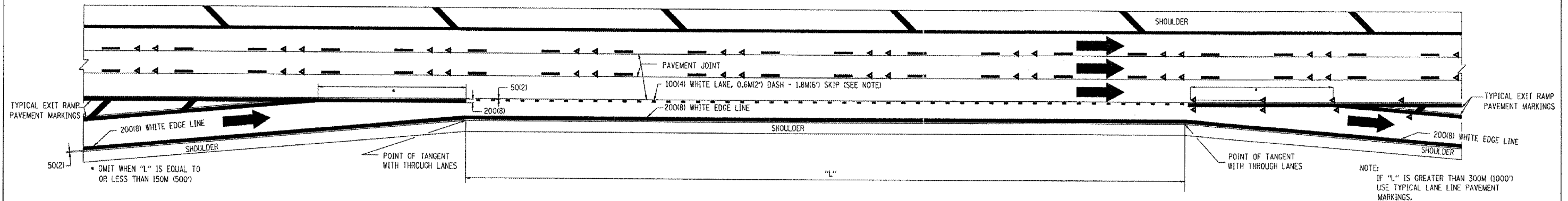

TYPICAL ENTRANCE/EXIT RAMP COMBINATION PAVEMENT MARKINGS

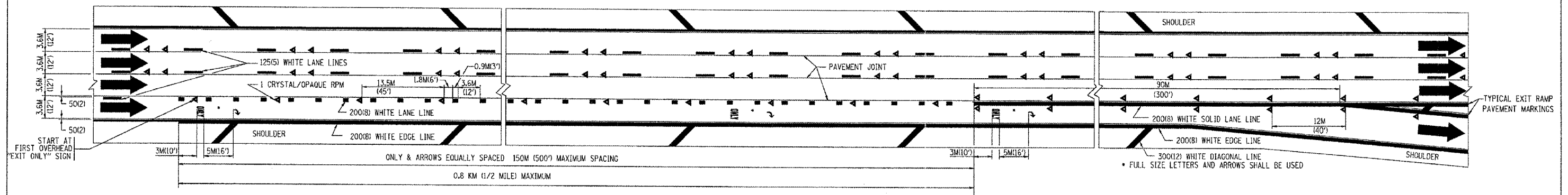

TYPICAL EXIT ONLY LANE PAVEMENT MARKINGS

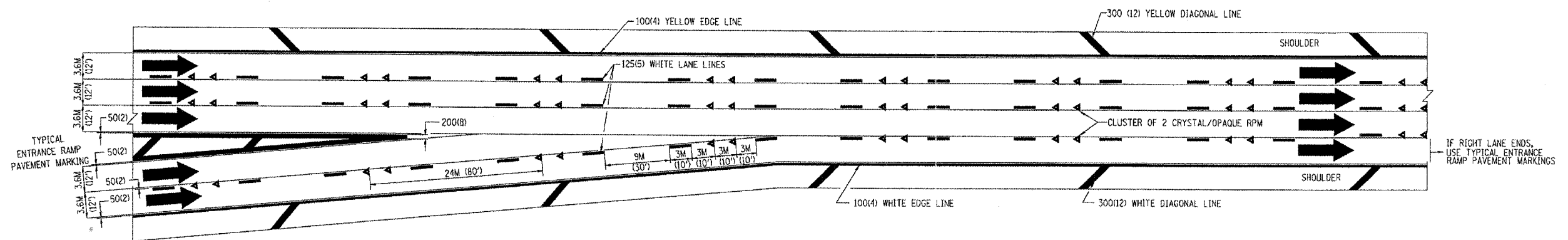

TYPICAL TWO LANE ENTRANCE RAMP PAVEMENT MARKINGS

DATE-TIME:
DGN-SPEC:
VIT/CIR

REVISIONS	
NAME	DATE
DWS	1/90
DWS	5/91

ILLINOIS DEPARTMENT OF TRANSPORTATION

**MULTI-LANE FREEWAY
PAVEMENT MARKING
DETAILS**

SCALE: NONE
DATE: 10/18/2002

DRAWN BY C.A.D.D.
CHECKED BY

TC12 SHEET 2 OF 2

REVISION DATE: 01/01/96