

F.A.S. RTE.	SECTION	COUNTY	TOTAL SHEETS	SHEET NO.
1517	(2)RS-3, (3)RS-4	MCLEAN	223	134
STA. 410+00.00		TO STA. 413+00.00		
FED. ROAD DIST. NO.	ILLINOIS	FED. AID PROJECT		

DATE	BY

DATE	BY

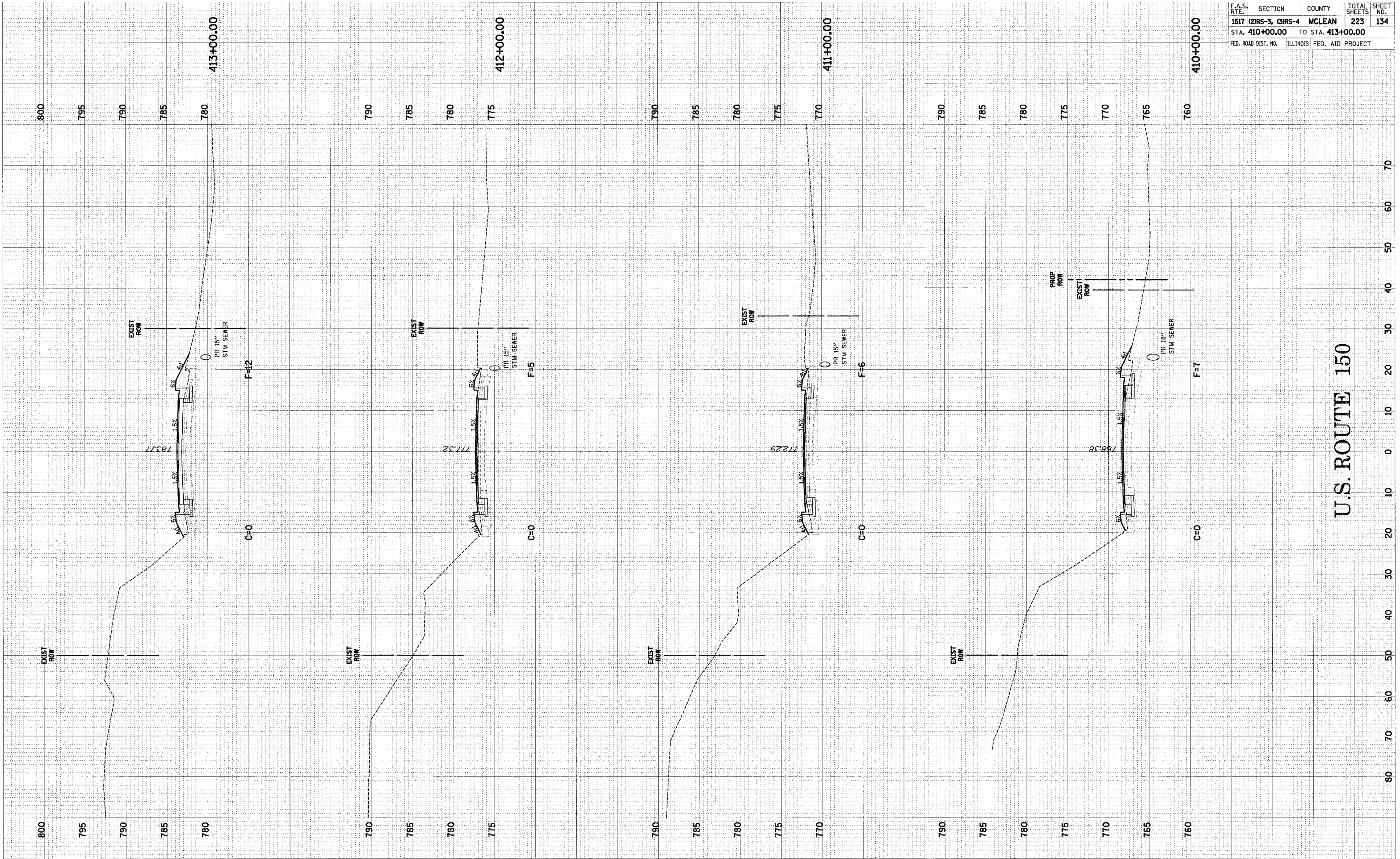

U.S. ROUTE 150

U.S. ROUTE 150 CROSS-SECTIONS STA. 410+00.00 TO STA. 413+00.00