

F.A.P. RTE.	SECTION	COUNTY	TOTAL SHEETS	SHEET NO.
311	1 N & TS	KENDALL	174	27
STA. 84+00		TO STA. 90+00		
FED. ROAD DIST. NO. 7 ILLINOIS FED. AID PROJECT				

PLAN	DATE	BY
SUBMITTED	8/20	AS
DESIGNED	8/20	AS
CHECKED	8/20	AS
APPROVED	8/20	AS
DATE	8/20	AS

PROFILE	DATE	BY
SUBMITTED	8/20	AS
DESIGNED	8/20	AS
CHECKED	8/20	AS
APPROVED	8/20	AS
DATE	8/20	AS

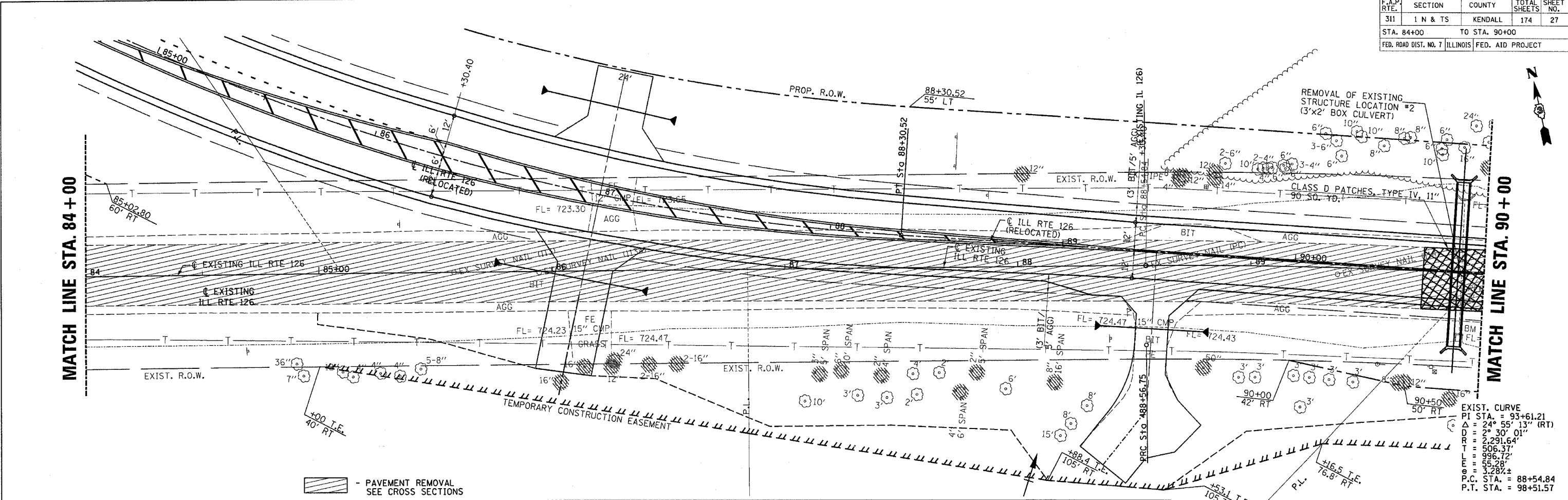

- PAVEMENT REMOVAL  
SEE CROSS SECTIONS

EXIST. CURVE  
 PI STA. = 93+61.21  
 $\Delta$  = 24° 55' 13" (RT)  
 DD = 2° 30' 01"  
 TR = 2,291.64'  
 T = 506.37'  
 L = 996.72'  
 E = 352.89'  
 P.C. STA. = 88+54.84  
 P.T. STA. = 98+51.57

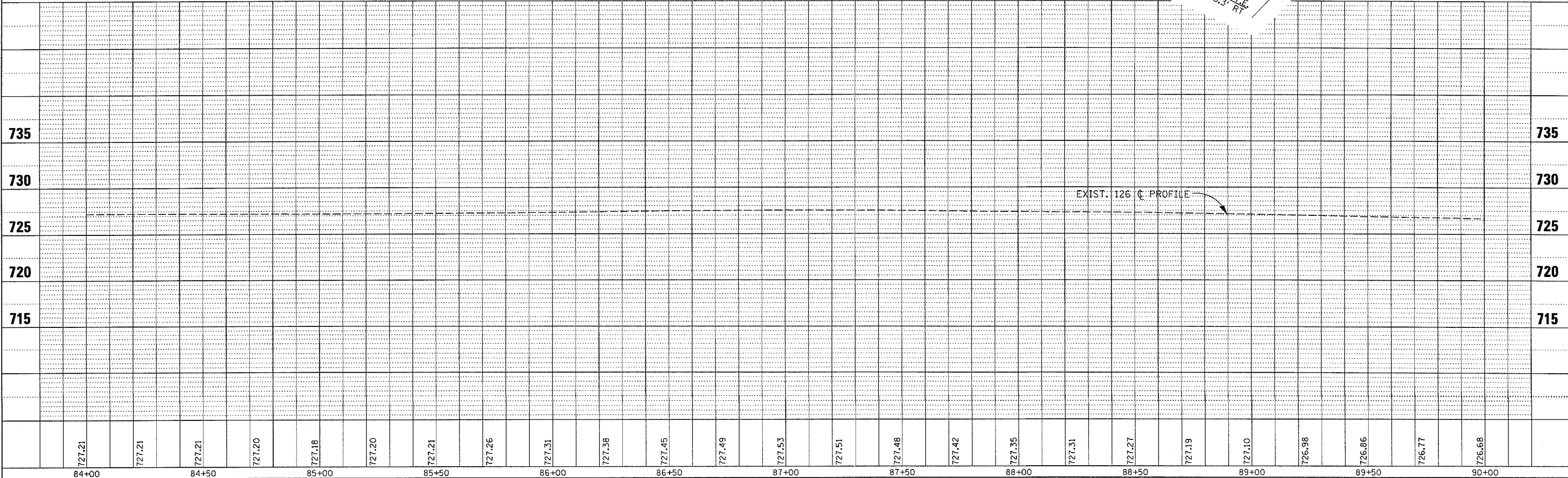

3/30/2006  
 c:\projects\ep02804\consul\1\pp-126-60-66.dgn