

EXIST. CURVE  
 PI STA. = 93+61.21  
 $\Delta = 24^\circ 55' 13''$  (RT)  
 $D = 2^\circ 30' 01''$   
 $R = 2,291.64'$   
 $T = 506.37'$   
 $L = 996.72'$   
 $E = 55.28'$   
 $e = 4\%$   
 P.C. STA. = 88+54.84  
 P.T. STA. = 98+51.57

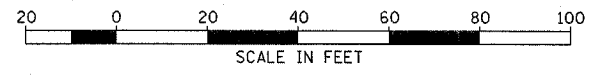

F.A.P. RTE.	SECTION	COUNTY	TOTAL SHEETS	SHEET NO.
311	1 N & TS	KENDALL	174	43
STA. 496+00		TO STA. 498+35.31		
FED. ROAD DIST. NO. 7		ILLINOIS	FED. AID PROJECT	

PLAN	DATE	BY
SURVEYED	7/26	WJN
ALIGNED	7/26	WJN
CHECKED	7/26	WJN
DATE	7/26	WJN
FILE NAME	26-60-66-897	
NO.	1	

PROFILE	DATE	BY
SURVEYED	7/26	WJN
GRADES CHECKED	7/26	WJN
DATE	7/26	WJN
FILE NAME	26-60-66-897	
NO.	1	

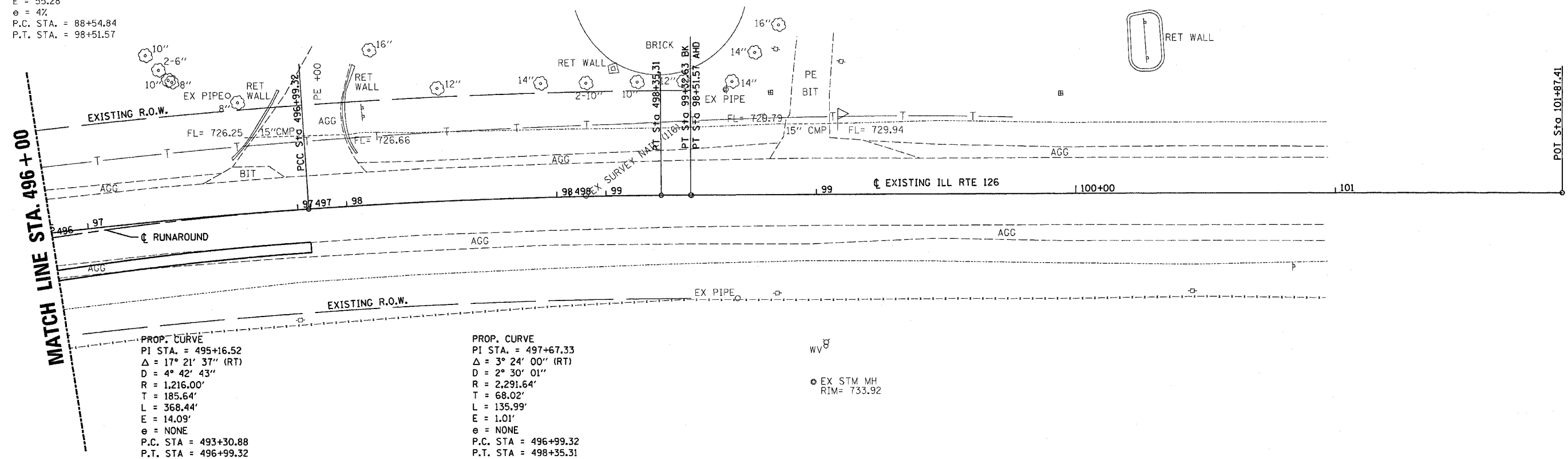

PROP. CURVE  
 PI STA. = 495+16.52  
 $\Delta = 17^\circ 21' 37''$  (RT)  
 $D = 4^\circ 42' 43''$   
 $R = 1,216.00'$   
 $T = 185.64'$   
 $L = 368.44'$   
 $E = 14.09'$   
 $e = \text{NONE}$   
 P.C. STA. = 493+30.88  
 P.T. STA. = 496+99.32

PROP. CURVE  
 PI STA. = 497+67.33  
 $\Delta = 3^\circ 24' 00''$  (RT)  
 $D = 2^\circ 30' 01''$   
 $R = 2,291.64'$   
 $T = 68.02'$   
 $L = 135.99'$   
 $E = 1.01'$   
 $e = \text{NONE}$   
 P.C. STA. = 496+99.32  
 P.T. STA. = 498+35.31

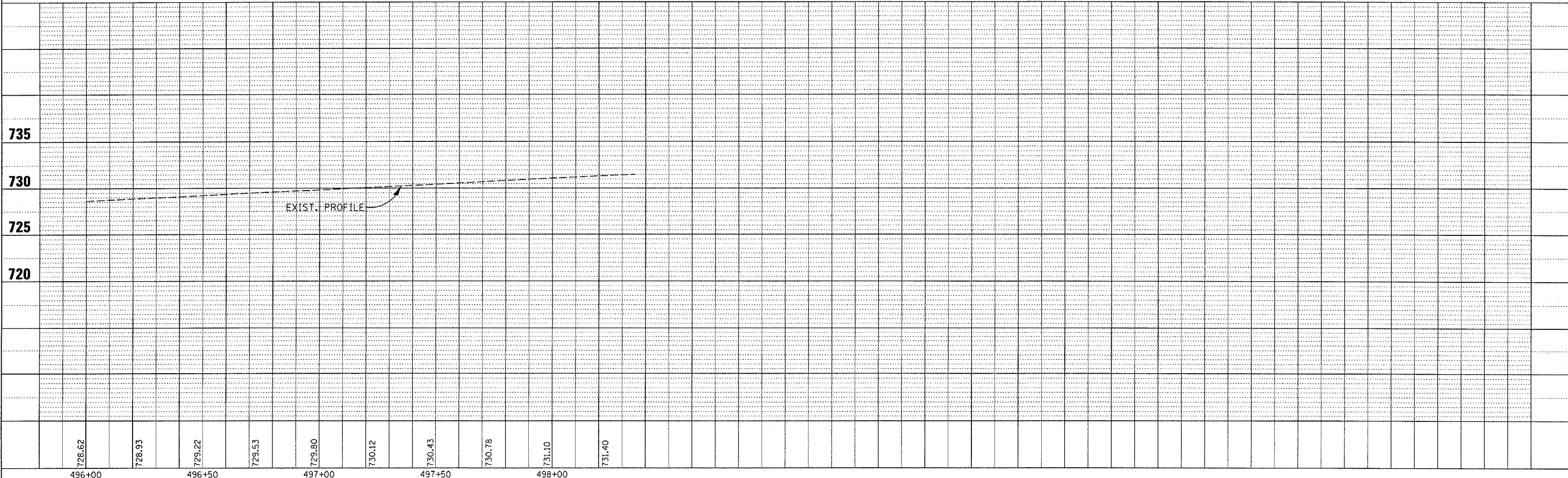

3/30/2006  
 c:\projects\ep02804\consu17\pp-126-60-66-897