

F.A.P. RTE.	SECTION	COUNTY	TOTAL SHEETS	SHEET NO.
311	1 N & TS	KENDALL	174	44
STA. 197+41.32		TO STA. 200+00		
FED. ROAD DIST. NO. 7 ILLINOIS FED. AID PROJECT				

PROP. CURVE
 PI STA. = 198+72.39
 $\Delta = 51^\circ 45' 23''$ (RT)
 $D = 28^\circ 38' 52''$
 $R = 200.00'$
 $T = 97.02'$
 $L = 180.66'$
 $E = 22.29'$
 $e =$ NORMAL CROWN
 P.C. STA = 197+75.37
 P.T. STA = 199+56.04

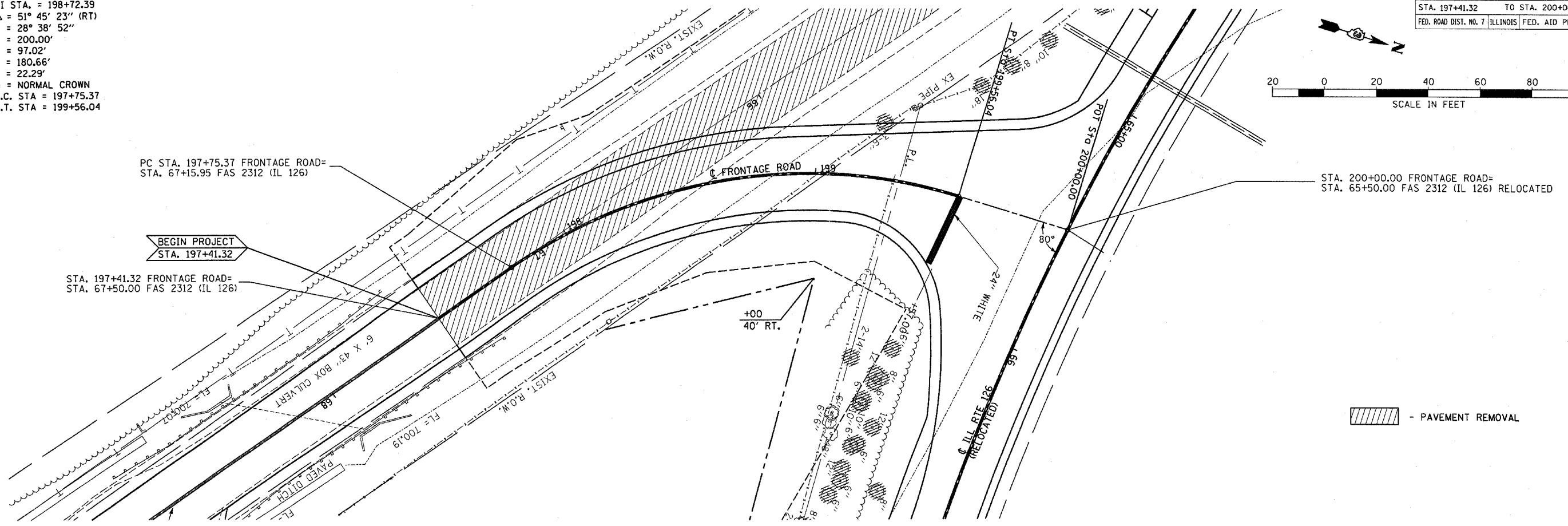
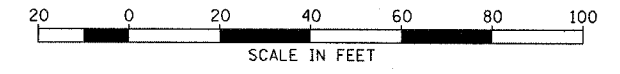

PC STA. 197+75.37 FRONTAGE ROAD=
 STA. 67+15.95 FAS 2312 (IL 126)

BEGIN PROJECT
STA. 197+41.32

 STA. 197+41.32 FRONTAGE ROAD=
 STA. 67+50.00 FAS 2312 (IL 126)

STA. 200+00.00 FRONTAGE ROAD=
 STA. 65+50.00 FAS 2312 (IL 126) RELOCATED

- PAVEMENT REMOVAL

DATE	BY	REVISION
PLANNING	DESIGNED	CHECKED

DATE	BY	REVISION
PROFILE	GRADES	CHECKED

BENCHMARK *402 "□" ON S.E. CORNER OF BOX
 CULVERT AT EAST SIDE OF EXISTING RTE. 126.
 STA. 197+16, 25' RT.
 ELEV. = 704.07

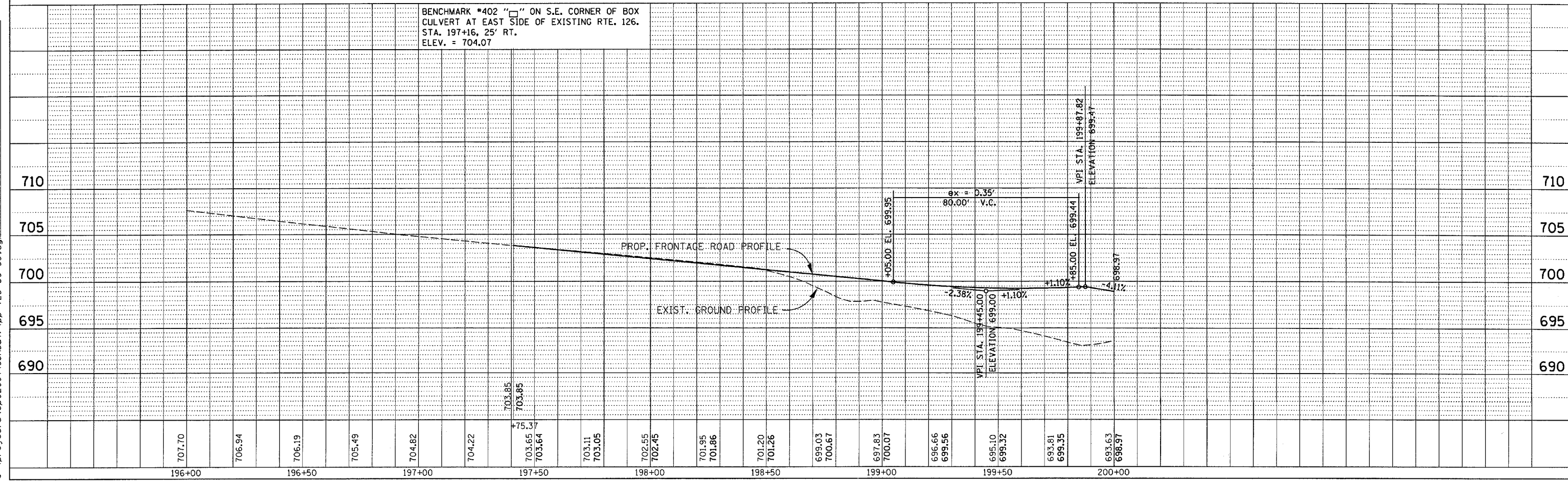

3/30/2006
c:\projects\ep02804\consul1\pp-126-60-66.dgn

FRONTAGE ROAD
STA.197 + 41.32 to STA.200 + 00