

FAP RTE.	SECTION	COUNTY	TOTAL SHEETS	SHEET NO.
317	(25B-1)I	LIVINGSTON	21	19
STA. 472+94.25		TO STA. 474+79.75		

GENERAL NOTES

This Standard is used where, at any time any vehicle, equipment, workers, or their activities will encroach on one lane of a bridge. Traffic signals and a positive barrier are required.

When traffic signals are not in operation, flaggers shall be used and traffic control devices shall conform to Standard 701201 or 701206.

Temporary concrete barrier shall be according to Standard 704001.

Bi-directional lights shall be used at night along the centerline where the work area is separated from the travel lane using barricades or drums. Monodirectional lights shall be used at night on all other barricades or drums.

Existing or temporary pavement marking shall be on both sides of the open lane from stop bar to stop bar.

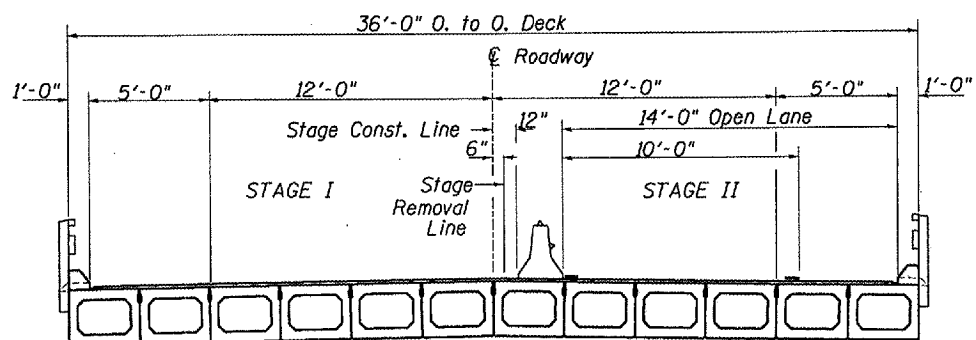

CROSS SECTION
LOOKING EAST

- SYMBOLS
- Work area
 - Sign
 - Type III barricade
 - Drum with steady burning light
 - Traffic signal
 - Double vertical panel
 - Type C Bidirectional reflector
 - Temporary concrete barrier
 - Impact attenuator
 - Steady burning lights and double vertical panels
 - Microwave Detector

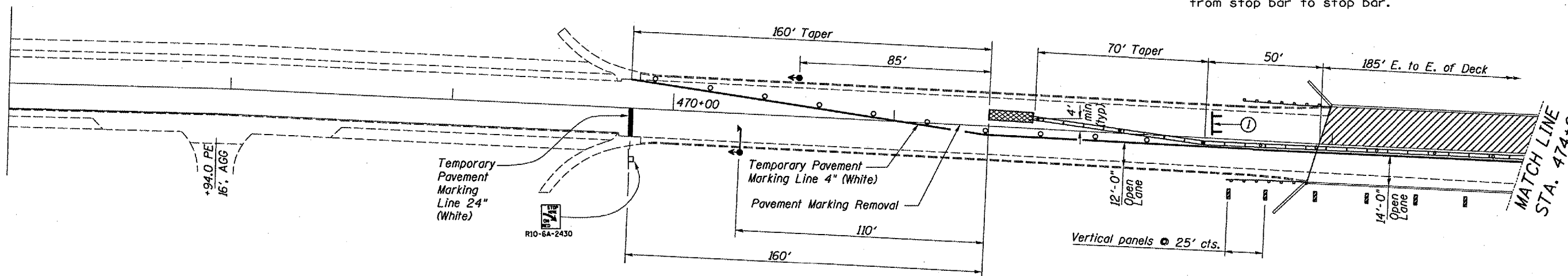

① Type III Barricades shall be in place when no work is being performed

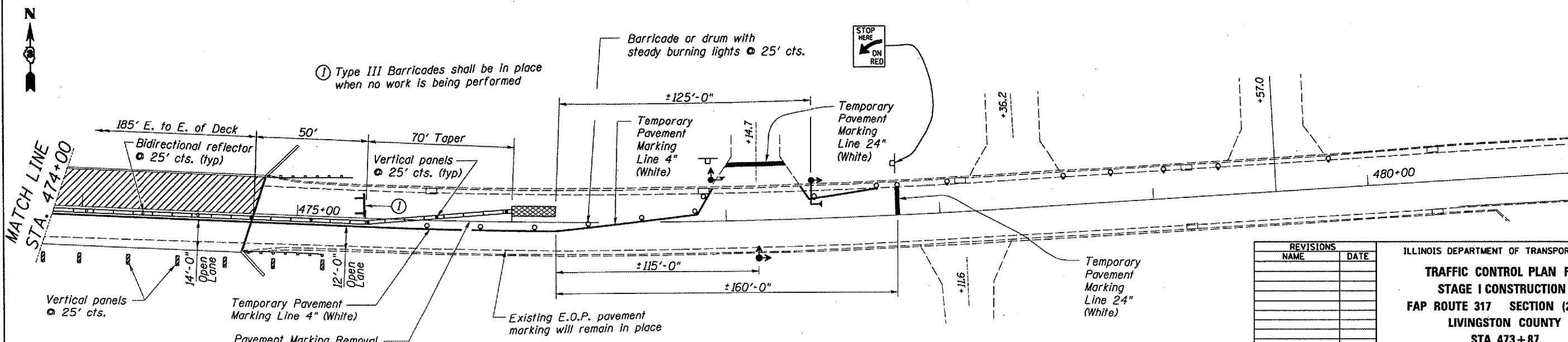

① Type III Barricades shall be in place when no work is being performed

REVISIONS	
NAME	DATE

ILLINOIS DEPARTMENT OF TRANSPORTATION
**TRAFFIC CONTROL PLAN FOR
 STAGE I CONSTRUCTION**
 FAP ROUTE 317 SECTION (25B-1)I
 LIVINGSTON COUNTY
 STA. 473+87
 DATE 09/27/2005 DRAWN BY RW

DATE: 09/27/2005
FILE: c:\projects\cma06\cnc322\det011.scdgn