

F.A.P. RTE.	SECTION	COUNTY	TOTAL SHEETS	SHEET NO.
330	(1R)	KANKAKEE	9	1
ILLINOIS				

STATE OF ILLINOIS
DEPARTMENT OF TRANSPORTATION
DIVISION OF HIGHWAYS

PROPOSED HIGHWAY PLANS

FAP ROUTE 330 (IL ROUTE 17)
SECTION (1R)
PROJECT
KANKAKEE COUNTY
PAVEMENT PATCHING
C-93-075-06

INDEX OF SHEETS

1. COVER SHEET
2. GENERAL NOTES
3. SUMMARY OF QUANTITIES
4. TYPICAL ROADWAY SECTIONS
5. PATCHING SCHEDULE - EASTBOUND LANES
6. PATCHING SCHEDULES - WESTBOUND LANES
7. PAVEMENT MARKING SCHEDULE
8. CLASS A PATCHING DETAIL
9. PAVEMENT STRIPING DETAILS

STANDARDS

- | | |
|-----------|--|
| 001001 | AREAS OF REINFORCEMENT BARS |
| 420001-06 | PAVEMENT JOINTS |
| 442001-02 | CLASS A PATCHING |
| 701101-01 | OFF-ROAD OPERATIONS MULTILANE, 4.5 m (15') TO 600 mm (24") FROM PAVEMENT EDGE |
| 701106-01 | OFF-ROAD OPERATIONS, MULTILANE, MORE THAN 4.5 m (15') AWAY |
| 701426-02 | LANE CLOSURE, MULTILANE, INTERMITTENT OR MOVING OPERATIONS FOR SPEEDS ≥ 45 MPH TO 55 MPH |
| 701422-01 | LANE CLOSURE, MULTILANE, FOR SPEEDS ≥ 45 MPH TO 55 MPH |
| 702001-06 | TRAFFIC CONTROL DEVICES |

MICROFILMED _____
REEL NUMBER _____
AWARDED _____
RESIDENT ENGINEER _____
AS BUILT CHANGES WERE MADE
ON THE FOLLOWING SHEETS _____

DISTRICT 3 NO. 1-815-434-6131
PROJECT ENGINEER: JOE KANNEL 1-815-434-8420
UNIT CHIEF: RON WOODSHANK 1-815-434-8419

J.U.L.I.E.
JOINT UTILITY LOCATION INFORMATION FOR EXCAVATION
1-800-892-0123

CONTRACT NO. 66655

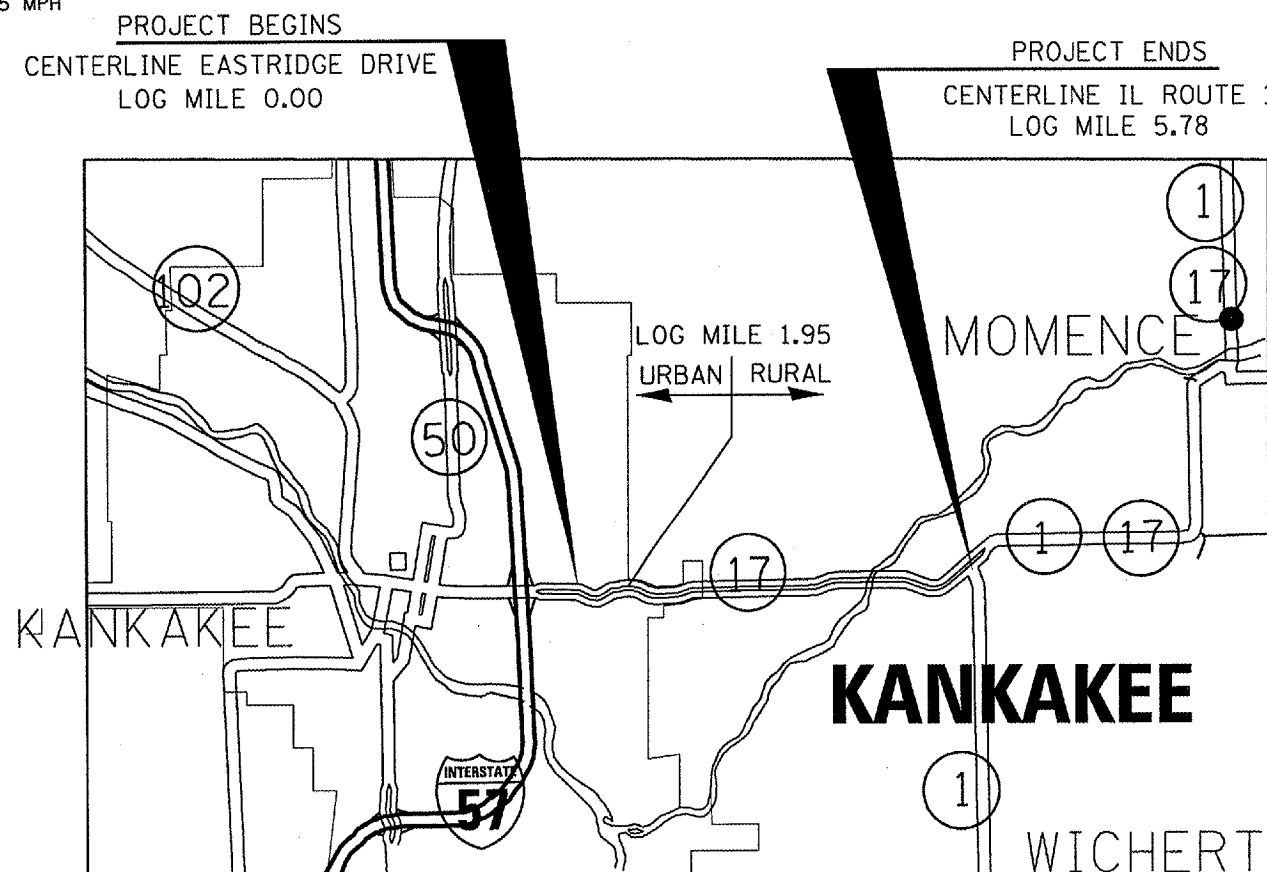

GROSS LENGTH OF IMPROVEMENT = 30518 FT = 5.78 MI.
NET LENGTH OF IMPROVEMENT = 30518 FT = 5.784 MI.

D-93-002-06

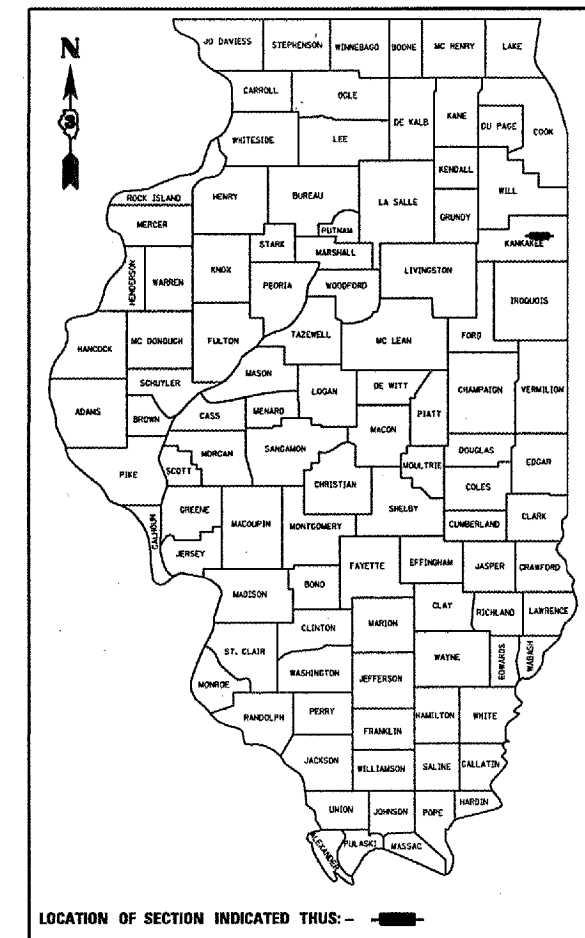

HIGHWAY CLASSIFICATION
URBAN/RURAL OTHER PRINCIPAL ARTERIAL
2004 ADT = 14000
PV 84% MU 8% SU 8%

STATE OF ILLINOIS
DEPARTMENT OF TRANSPORTATION
DIVISION OF HIGHWAYS

SUBMITTED 5/16 2006
James L. Mont
DEPUTY DIRECTOR OF HIGHWAYS, REGION ENGINEER

June 30, 2006
Mike Hene
ENGINEER OF DESIGN AND ENVIRONMENT

June 30, 2006
Melton R. Sees P.E.
DIRECTOR OF HIGHWAYS, CHIEF ENGINEER

**PRINTED BY THE AUTHORITY
OF THE STATE OF ILLINOIS**

F.A.P. RTE.	SECTION	COUNTY	TOTAL SHEETS	SHEET NO.
330	(1R)I	KANKAKEE	9	2
ILLINOIS				

GENERAL NOTES:

Plan dimensions and details relative to the existing roadway and structure have been taken from existing plans and are subject to nominal construction variations. It shall be the contractor's responsibility to verify such dimensions and details in the field and to make necessary approved adjustments prior to construction or ordering of materials. Such variations shall not be cause for additional compensation for a change in the scope of the work, however, the contractor will be paid for the quantity actually furnished at the unit price bid for the work.

The contractor shall be responsible for protecting utility property from construction operations as outlined in Article 107.31 of the Standard Specifications. The "Julie" Number is 1-800-892-0123. A minimum of forty-eight (48) hours advance notice is required.

The cost of any saw cuts made to complete the work as described in plan details, unless otherwise noted shall not be paid for separately but shall be included in the various pay items involved.

The thickness of bituminous mixtures shown on the plans is the nominal thickness. Deviations from the nominal thickness will be permitted when such deviations occur due to irregularities in the existing surface or base on which the bituminous mixture is placed.

Where section or subsection monuments are encountered, the engineer shall be notified before such monuments are removed. The contractor shall protect and carefully preserve all monuments until an authorized surveyor or agent has witnessed or otherwise referenced their location. The contractor shall be responsible for having an authorized surveyor reestablish any section or subsection monuments destroyed by his operations.

Abandoned underground utilities that conflict with construction shall be disposed of outside the limits of the right of way according to Article 202.03 of the Standard Specifications and as directed by the Engineer. This work will not be paid for separately but shall be included in the cost of earth

Any reference to a standard in these plans shall be interpreted to mean the edition as indicated by the subnumber listed on the index of sheets or the copy of the standard included in these plans. excavation.

The existing shoulders are low. In the event that construction operations result in a drop off greater than 3" between the edge of pavement or edge of shoulder within 3' of the edge of pavement and the earth or aggregate shoulders, then the drop off shall be projected according to Article 701.04(B)(1) of the Standard Specifications. This work will be considered as included in the contract unit prices for traffic control.

Reinforcement bars that are to remain in place which are damaged during concrete removal operations shall be repaired or replaced using approved bar splicer or anchorage system. Cost included with "Pavement Patching".

Reinforcement bars shall conform to the requirements of AASHTO M 31 or M322 Grade 60.

The following rates of application have been used in calculation plan quantities:

Granular Materials	2.05	ons/ Cu	Ydd
--------------------	------	---------	-----

PREPARED BY: *Rick Paul M*
DISTRICT STUDIES & PLANS ENGINEER

DATE: 5/16/06

EXAMINED BY: *Herb Jung*
DISTRICT CONSTRUCTION ENGINEER

Matt Jurb
DISTRICT MATERIALS ENGINEER

Bruce A. Hueston
DISTRICT OPERATIONS ENGINEER

REVISIONS	
NAME	DATE

ILLINOIS DEPARTMENT OF TRANSPORTATION

GENERAL NOTES
FAP 41 (IL 17)
SECTION: (1R)I
KANKAKEE COUNTY

F.A.P. RTE.	SECTION	COUNTY	TOTAL SHEETS	SHEET NO.
330	(1R1)	KANKAKEE	9	3
ILLINOIS				

SUMMARY OF QUANTITIES

CONSTRUCTION CODE: **J000**

CODE NO.	ITEM	UNIT	TOTAL QUANTITY	100 % STATE	
				URBAN	RURAL
44200553	CLASS A PATCH PATCHES, TYPE II 10"	SQ YD	953	322	631
44200557	CLASS A PATCH PATCHES, TYPE III 10"	SQ YD	80	40	40
44200559	CLASS A PATCH PATCHES, TYPE IV 10"	SQ YD	80	40	40
44213000	PATCHING REINFORCEMENT	SQ YD	1,113	402	711
44213200	SAW CUTS	FOOT	8,100	2,790	5,310
67100100	MOBILIZATION	L SUM	1	0.5	0.5
70100320	TRAFFIC CONTROL AND PROTECTION, STANDARD 701422	L SUM	1	0.5	0.5
70103815	TRAFFIC CONTROL AND SURVEILLANCE	CALDAY	30	15	15
* 78001110	PAINT PAVEMENT MARKING - LINE 4"	FOOT	111932	13100	98832
* 78001130	PAINT PAVEMENT MARKING - LINE 6"	FOOT	14084	1640	12444
* 78001140	PAINT PAVEMENT MARKING - LINE 8"	FOOT	800	400	400

*SPECIALTY ITEM

Date: April 25, 2006
 File Name: c:\projects\cma\m7\con318\desol1.dgn

REVISIONS	
NAME	DATE

ILLINOIS DEPARTMENT OF TRANSPORTATION
SUMMARY OF QUANTITIES
 FAP 41 (IL 17)
 SECTION: (1R1)
 KANKAKEE COUNTY

F.A.P. RTE.	SECTION	COUNTY	TOTAL SHEETS	SHEET NO.
330	(1R)	KANKAKEE	9	4
ILLINOIS				

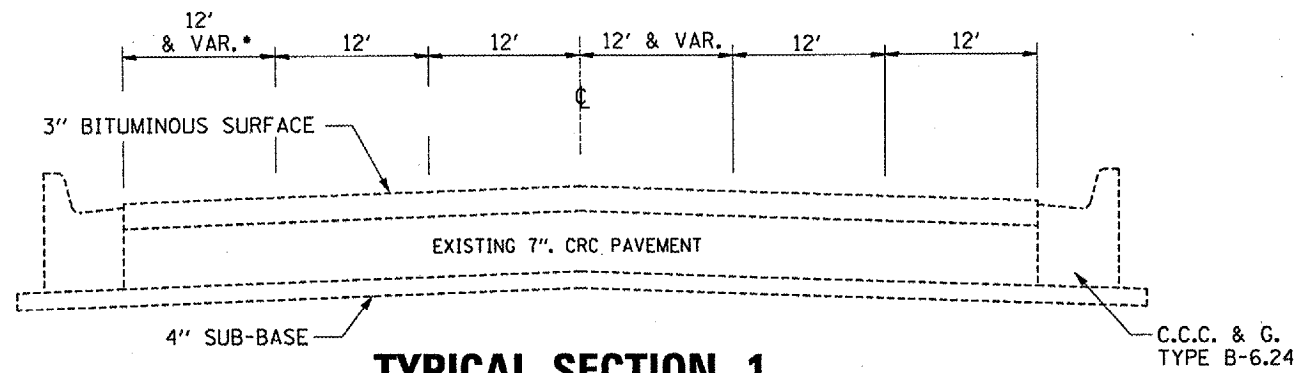

TYPICAL SECTION 1
LOG MILE 0.00 TO LOG MILE 0.07

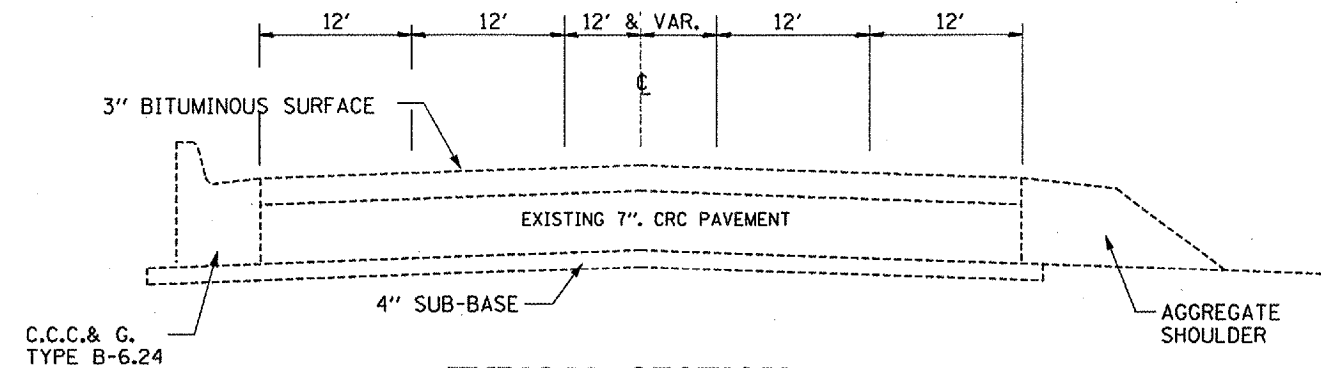

TYPICAL SECTION 4
LOG MILE 0.36 TO LOG MILE 0.39

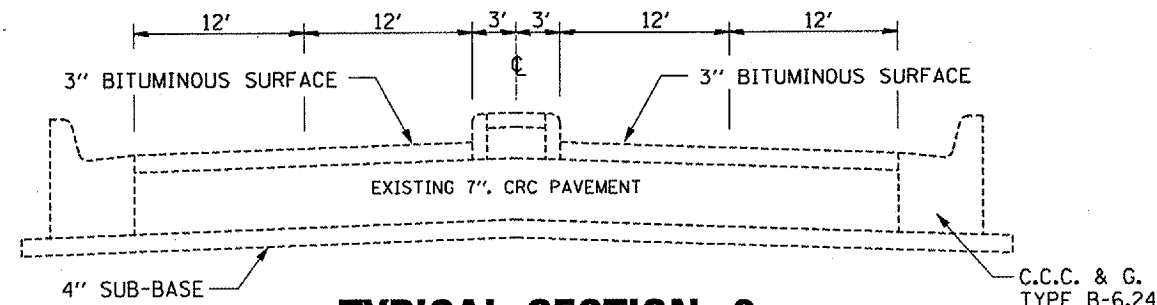

TYPICAL SECTION 2
LOG MILE 0.07 TO LOG MILE 0.22

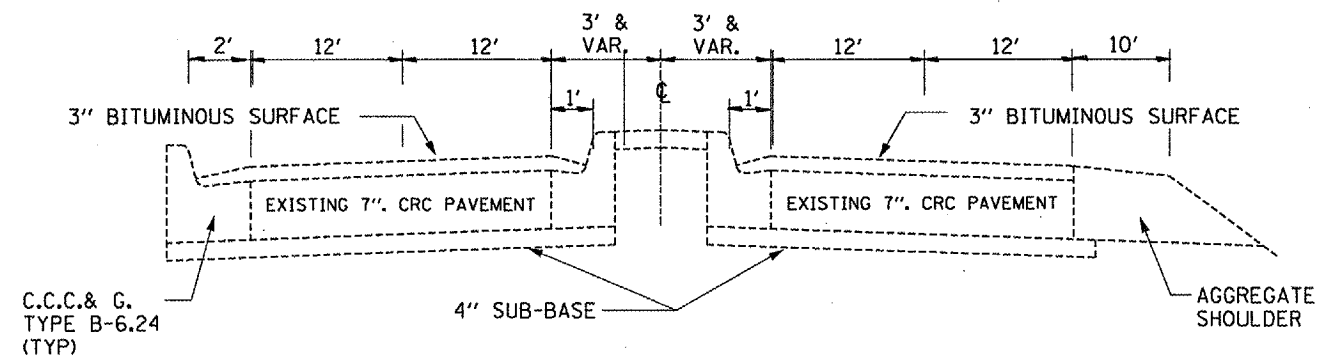

TYPICAL SECTION 5
LOG MILE 0.39 TO LOG MILE 0.43

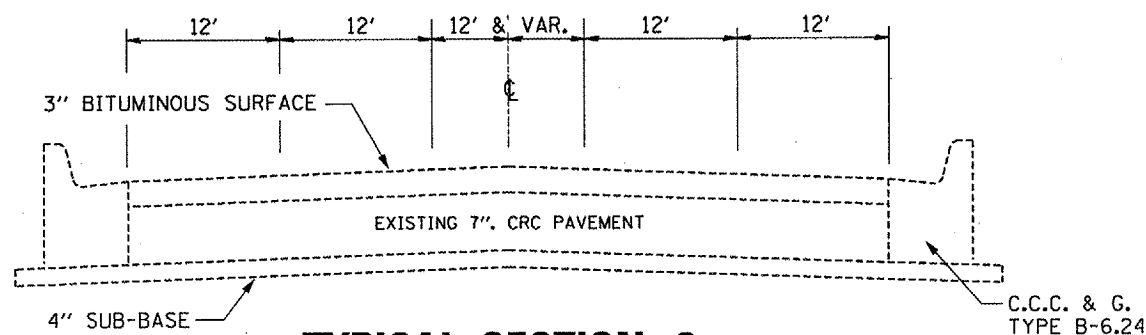

TYPICAL SECTION 3
LOG MILE 0.22 TO LOG MILE 0.36

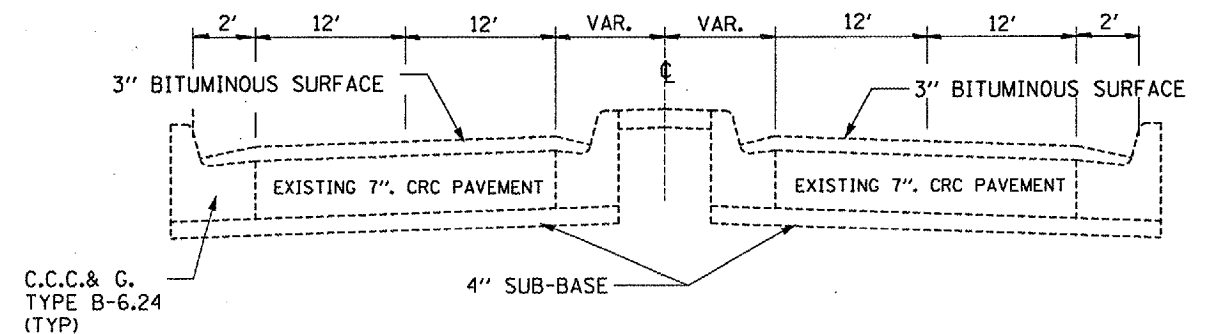

TYPICAL SECTION 6
LOG MILE 0.43 TO LOG MILE 5.78

REVISIONS	
NAME	DATE

ILLINOIS DEPARTMENT OF TRANSPORTATION

TYPICAL SECTIONS
FAP 41 (IL 17)
SECTION: (1R)
KANKAKEE COUNTY

Date: April 25, 2008
File Name: c:\p\j\genar\mamd7\con318\desult.dgn

F.A.P. RYE	SECTION	COUNTY	TOTAL SHEETS	SHEET NO.
330	(1R)I	KANKAKEE	9	5
ILLINOIS				

CLASS A PATCHING EASTBOUND LANES

LOCATION BY LOG MILE	PASSING LANE			DRIVING LANE			REMARKS
	CLASS A PATCHING TYPE II 10"	PATCHING REINFORCEMENT	SAW CUTS	CLASS A PATCHING TYPE II 10"	PATCHING REINFORCEMENT	SAW CUTS	
	SQ YD	SQ YD	FOOT	SQ YD	SQ YD	FOOT	
URBAN SECTION							
0.00				13	13	78	CENTERLINE EASTRIDGE ROAD
0.36				8	8	66	
0.43							
0.44	8	8	66	8	8	66	
0.47				8	8	66	
0.54	8	8	66	8	8	66	
0.57				8	8	66	
0.60				8	8	66	
0.66							CENTERLINE EASTGATE INDUSTRIAL PARK ROAD
0.81							CENTERLINE SPLEAR ROAD
0.82	8	8	66	8	8	66	
0.89				8	8	66	
0.95	8	8	66				
1.15	8	8	66	8	8	66	
1.20							CENTERLINE LOWE ROAD
1.44				8	8	66	
1.48				8	8	66	
1.70				13	13	78	
1.71				8	8	66	
1.95							CENTERLINE SKYLINE ROAD
SUBTOTAL	40	40	330	114	114	882	
RURAL SECTION							
2.09				8	8	66	
2.15	8	8	66	13	13	78	
2.27	8	8	66	8	8	66	
2.30	8	8	66	8	8	66	
3.25				8	8	66	
3.29	8	8	66	13	13	78	
3.44	8	8	66	8	8	66	
3.47							CENTERLINE EXLINE ROAD
3.49	8	8	66	8	8	66	
3.90				8	8	66	
3.97				8	8	66	
4.03				8	8	66	
4.10							CENTERLINE SANDBAR ROAD
4.25	8	8	66	8	8	66	
4.32	8	8	66	13	13	78	
4.56	8	8	66	8	8	66	
4.60							CENTERLINE S. HEILAND ROAD
4.61	8	8	66	8	8	66	
4.70	8	8	66	8	8	66	
4.90	8	8	66	8	8	66	
5.00							CENTERLINE N. RIVERWOOD ROAD
5.10	8	8	66				
5.13				8	8	66	
5.17	8	8	66				CENTERLINE SUNSET ROAD
5.18							
5.48	8	8	66				
5.49				8	8	66	
5.51	8	8	66	8	8	66	
5.60	8	8	66	8	8	66	
5.63	8	8	66	8	8	66	
5.71	8	8	66	8	8	66	
5.78							CENTERLINE IL ROUTE 1
SUBTOTAL	152	152	1254	199	199	1554	
TOTALS	192	192	1584	313	313	2436	

REVISIONS	
NAME	DATE

ILLINOIS DEPARTMENT OF TRANSPORTATION
PATCHING SCHEDULES
EASTBOUND LANE
FAP 41 (IL 17)
SECTION: (1R)I
KANKAKEE COUNTY

Date: Apr-11-2016 10:28:05 AM File Name: c:\p\proj\car\csm\m\87\con\330\classa.tbl.dgn

F.A.P. RTE.	SECTION	COUNTY	TOTAL SHEETS	SHEET NO.
330	(1R)	KANKAKEE	9	6
ILLINOIS				

CLASS A PATCHING WESTBOUND LANES							REMARKS
LOCATION BY LOG MILE	PASSING LANE			DRIVING LANE			
	CLASS A PATCHING TYPE II 10"	PATCHING REINFORCEMENT	SAW CUTS	CLASS A PATCHING TYPE II 10"	PATCHING REINFORCEMENT	SAW CUTS	
	SQ YD	SQ YD	FOOT	SQ YD	SQ YD	FOOT	
RURAL SECTION							
0.00							CENTERLINE IL ROUTE 1
0.01	8	8	66	8	8	66	
0.05	8	8	66				
0.11	8	8	66	8	8	66	
0.18	8	8	66				
0.19	8	8	66	8	8	66	
0.20	8	8	66	8	8	66	
0.26	8	8	66	8	8	66	CENTERLINE SUNSET ROAD
0.81							CENTERLINE N. RIVERWOOD ROAD
1.28							CENTERLINE S. HEILAND ROAD
1.38	8	8	66	8	8	66	
1.46	8	8	66	8	8	66	
1.56	8	8	66	8	8	66	
1.66				8	8	66	
1.70							CENTERLINE N. EAGLE ISLAND ROAD
1.75				8	8	66	
2.33	8	8	66	8	8	66	
2.34							CENTERLINE EXLINE ROAD
2.36				8	8	66	
2.42	8	8	66	8	8	66	
2.48	8	8	66	8	8	66	
3.08	8	8	66	8	8	66	
3.43	8	8	66	8	8	66	
3.56	8	8	66	8	8	66	
3.62	8	8	66	8	8	66	
SUBTOTAL	136	136	1122	144	144	1188	
URBAN SECTION							
3.82				8	8	66	CENTERLINE SKYLINE ROAD
4.50							AROMA PARK ROAD
4.62				8	8	66	
4.79	8	8	66	8	8	66	
4.85	8	8	66	8	8	66	
4.86				8	8	66	
5.05				8	8	66	
5.09	8	8	66	8	8	66	
5.11							CENTERLINE SPLEAR ROAD
5.33	8	8	66				
5.38	8	8	66				
5.39				8	8	66	
5.44							CENTERLINE EASTGATE INDUSTRIAL PARK ROAD
5.46	8	8	66	8	8	66	
5.48	8	8	66				
5.56				8	8	66	
5.60				8	8	66	
5.61				8	8	66	
5.65	8	8	66	8	8	66	
5.68				8	8	66	
5.78							CENTERLINE EASTRIDGE ROAD
SUBTOTAL	64	64	528	104	104	858	
TOTAL	200	200	1650	248	248	2046	

REVISIONS	
NAME	DATE

ILLINOIS DEPARTMENT OF TRANSPORTATION
PATCHING SCHEDULES
WESTBOUND LANE
 FAP 41 (IL 17)
 SECTION: (1R)
 KANKAKEE COUNTY

Date: April 25, 2006
 File Name: c:\p\cpr\as\comonp7\c0318\de\enl1.dgn

F.A.P. RTE.	SECTION	COUNTY	TOTAL SHEETS	SHEET NO.
330	(1R)1	KANKAKEE	9	7
ILLINOIS				

PAVEMENT MARKING SCHEDULE

LOCATION	PAINT PAVEMENT MARKING LINE - 4''		PAINT PAVEMENT MARKING LINE - 6''		PAINT PAVEMENT MARKING LINE - 8''	
	YELLOW	WHITE	YELLOW	WHITE	YELLOW	WHITE
	FEET	FEET	FEET	FEET	FEET	FEET
EASTGATE DRIVE TO EASTSIDE IL ROUTE 1	59136	59136	14784			800
OMMISIONS						
SPEAR ROAD	400	400	100	100		
LOWE ROAD	800	150	60	60		
FRONTAGE ROAD	240	240	60	60		
SKYLINE ROAD	240	120	60	60		
N 4000 ROAD	240	120	60	60		
PRIVATE ENTRANCE	240					
PRIVATE ENTRANCE	240					
SIDE ROAD 5500	400	200	100	100		
FIELD ENTRANCE	240					
N. EAGLE ISLAND/ SANDBAR ROAD	240	240	60	60		
HEILAND ROAD	240	240	60	60		
RIVERWOOD ROAD	240	240	60	60		
BASELINE/SUNSET ROAD	320	310	80	80		
SUBTOTALS	55056	56876	14084	14084		800
TOTALS	111932		14084		800	

REVISIONS	
NAME	DATE

ILLINOIS DEPARTMENT OF TRANSPORTATION

PAVEMENT MARKING SCHEDULE
FAP 41 (IL 17)
SECTION: (1R)1
KANKAKEE COUNTY

Date: April 25, 2005
 File: h:\mca\proj\pavm\mca\07\cm318\detail.dwg

F.A.P. RTE.	SECTION	COUNTY	TOTAL SHEETS	SHEET NO.
330	(1R)1	KANKAKEE	9	8
ILLINOIS				

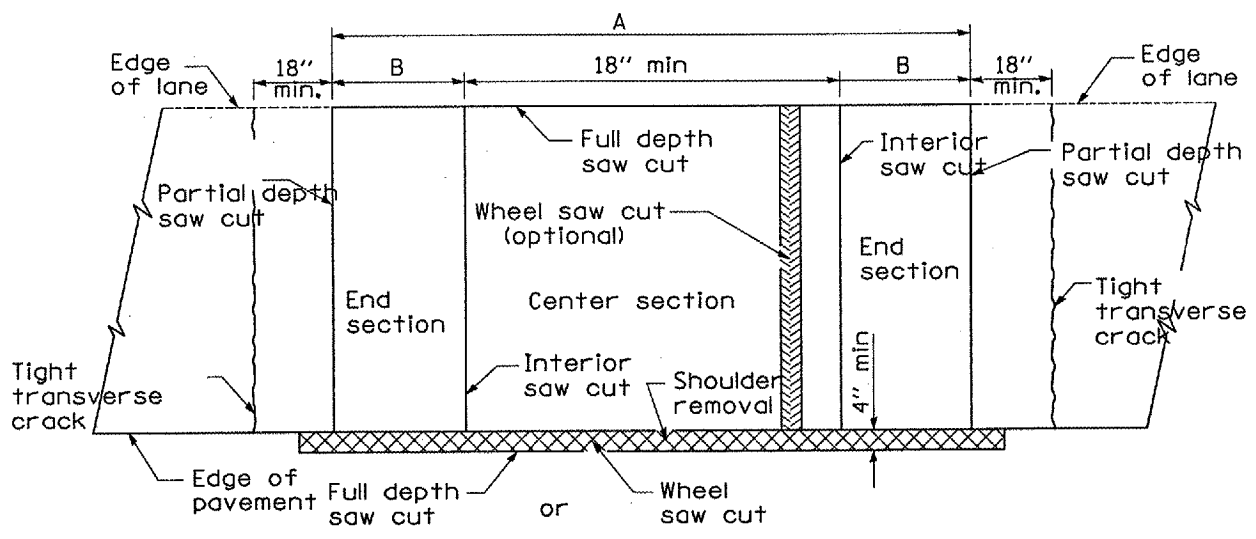

PAVEMENT SAWING DETAIL
(BITUMINOUS SHOULDER)

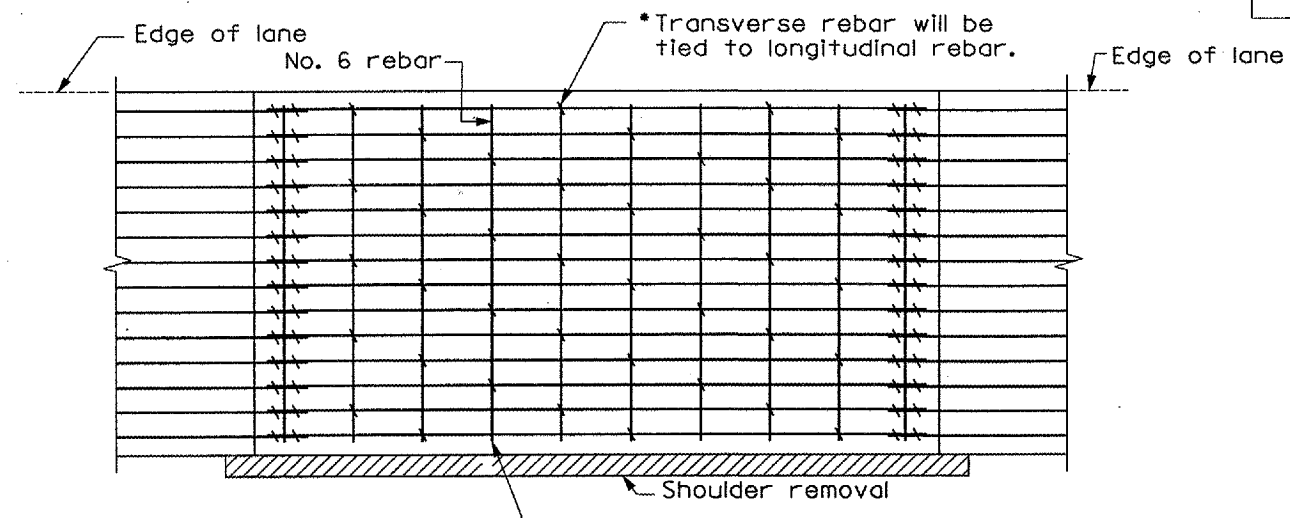

PAVEMENT REINFORCEMENT DETAIL

Transverse rebar will extend to outer longitudinal rebar while providing a minimum 3" clearance from existing pavement edge.

EXISTING LONGITUDINAL REINFORCEMENT BARS	A (min.)	B (min.)	C (min.)
No. 6	6'-0"	21"	22"

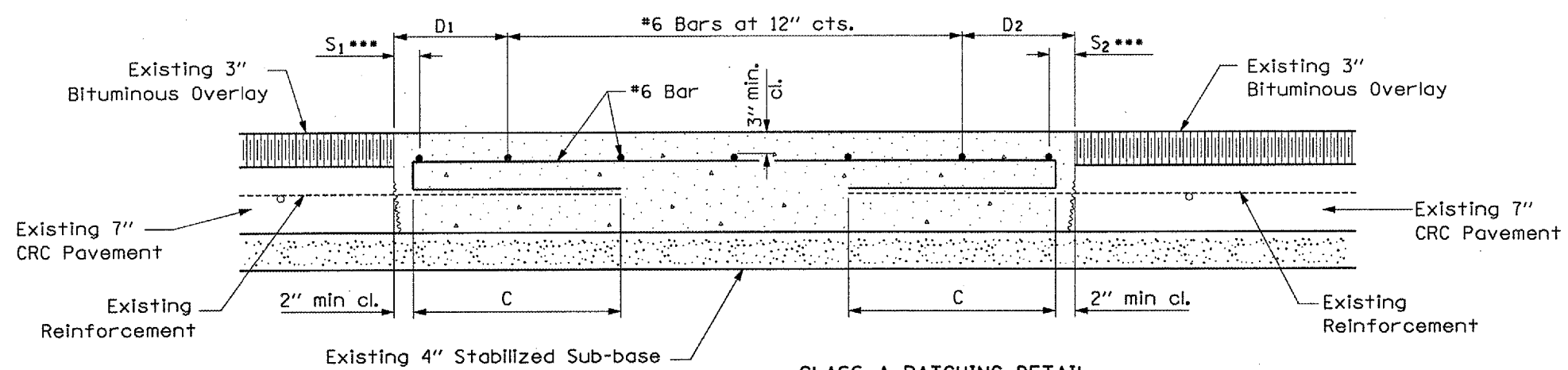

CLASS A PATCHING DETAIL

- * Every 3rd intersection must be tied.
- ** Lap new reinforcement with existing longitudinal reinforcement
- *** Variable: Where S₁ and S₂ are 2 1/2" min. and 12" max. D₁ = 2(S₁) and D₂ = 2(S₂).

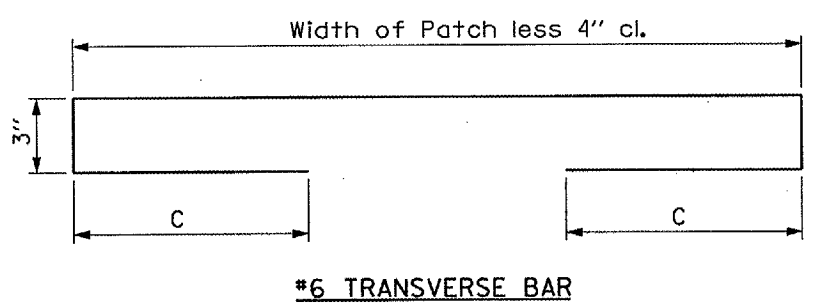

#6 TRANSVERSE BAR

GENERAL NOTES

When patching two adjacent lanes in one operation, the longitudinal joint shall be a sawed longitudinal joint as detailed on Standard 420001; however, the groove shall be either preformed or sawed. Tie bars shall only be included for patches 6.0 m (20') or longer.

REVISIONS	
NAME	DATE

ILLINOIS DEPARTMENT OF TRANSPORTATION
CLASS A PATCHING DETAIL
FAP 41 (IL 17)
SECTION: (1R)1
KANKAKEE COUNTY

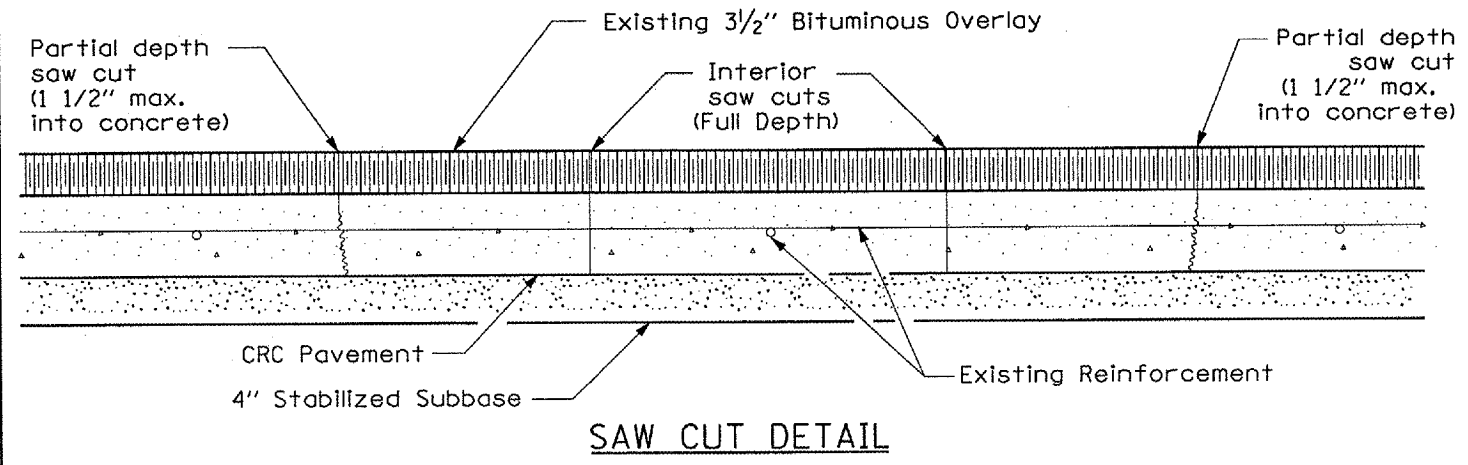

SAW CUT DETAIL

Date: April 25, 2005
 File Name: C:\pro\pav\cme\m7\con318\detail.dgn

F.A.P. RTE.	SECTION	COUNTY	TOTAL SHEETS	SHEET NO.
330	(1R)I	KANKAKEE	9	9
ILLINOIS				

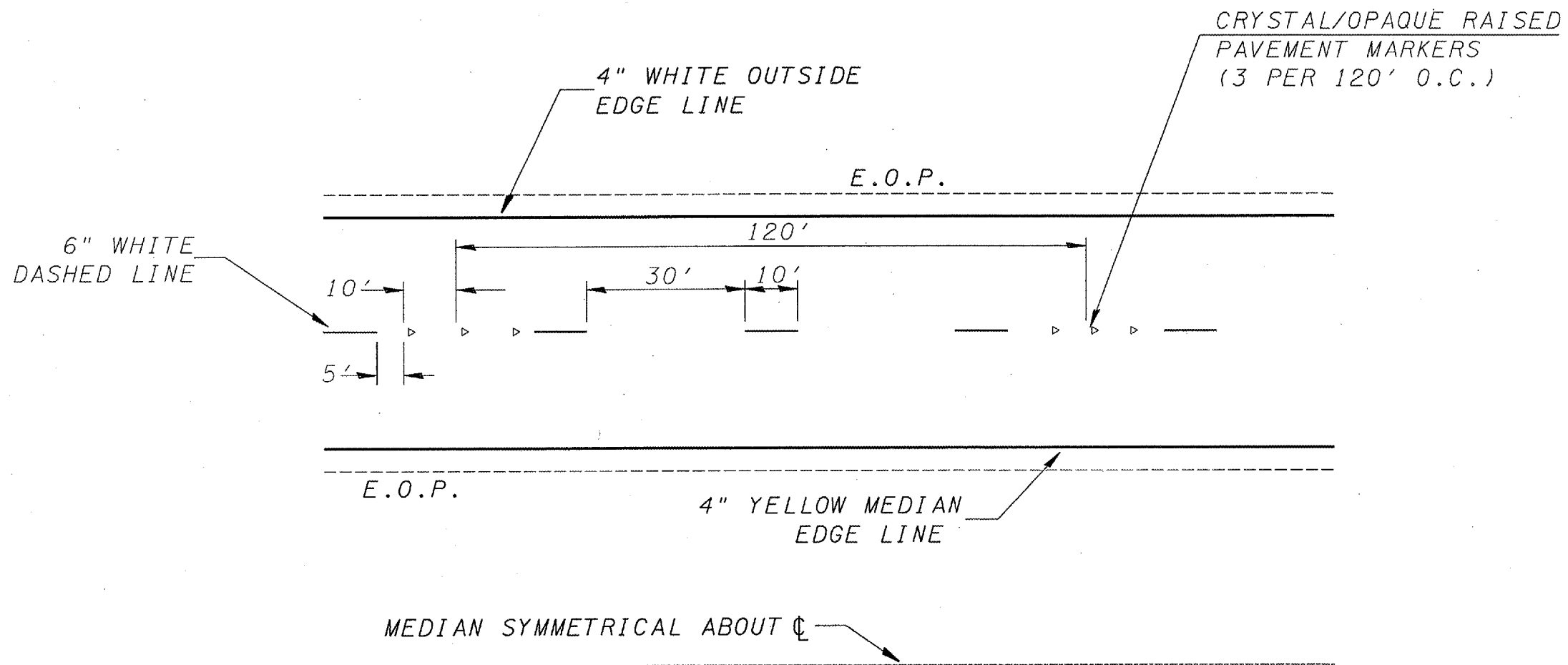

TYPICAL PAVEMENT MARKINGS

Date: April 25, 2015
 File Name: c:\projects\csm\m07\m318\ds\shldgn

REVISIONS	
NAME	DATE

ILLINOIS DEPARTMENT OF TRANSPORTATION
TYPICAL PAVEMENT MARKING
 FAP 41 (IL 17)
 SECTION: (1R)I
 KANKAKEE COUNTY