

F.A.I. RTE.	SECTION	COUNTY	TOTAL SHEETS	SHEET NO.
57	*	IROQUOIS	3	1

\*D3 TREE PLANTING 2006-2

STATE OF ILLINOIS  
DEPARTMENT OF TRANSPORTATION  
DIVISION OF HIGHWAYS

**PROPOSED  
HIGHWAY PLANS**

FAI ROUTE 57 (I-57)  
SECTION D3 TREE PLANTING 2006-2

IROQUOIS COUNTY

C - 93 - 055 - 05  
TREE PLANTING

INDEX OF SHEETS

- 1 COVER SHEET
- 2 SUMMARY OF QUANTITIES & GENERAL NOTES
- 3 PLAN VIEW

STANDARDS

- 000001-04 STANDARD SYMBOLS, ABBREVIATIONS AND PATTERNS
- 001006 DECIMAL OF AN INCH AND OF A FOOT
- 701101-01 OFF-ROAD OPERATIONS MULTILANE, 4.5 m (15') TO 600 mm (24") FROM PAVEMENT EDGE
- 701106-01 OFF-ROAD OPERATIONS, MULTILANE, MORE THAN 4.5 m (15') AWAY
- 702001-05 TRAFFIC CONTROL DEVICES

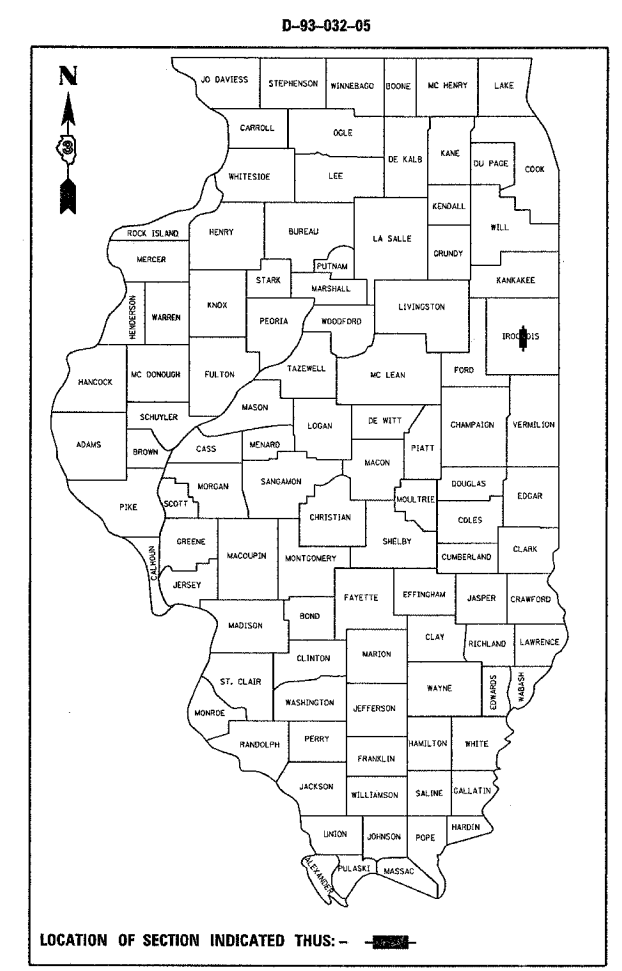

LOCATION OF SECTION INDICATED THIS: - [shaded area] -

PROJECT LOCATION

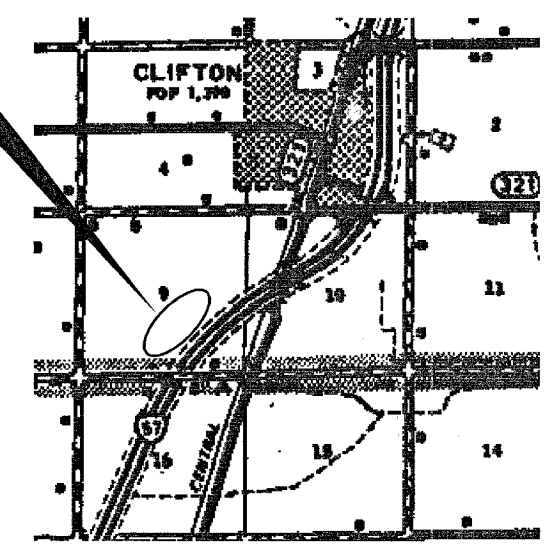

MICROFILMED \_\_\_\_\_  
REEL NUMBER \_\_\_\_\_  
AWARDED \_\_\_\_\_  
RESIDENT ENGINEER \_\_\_\_\_  
AS BUILT CHANGES WERE MADE  
ON THE FOLLOWING SHEETS \_\_\_\_\_

J.U.L.I.E.  
JOINT UTILITY LOCATION INFORMATION FOR EXCAVATION  
1-800-892-0123

DISTRICT 3 NO. (815) 434-6131

PROJECT ENGINEER: D. BROVIAK  
UNIT CHIEF: G. BERTOLINO

CONTRACT # 66664

GROSS LENGTH = 3300 FT. = 0.625 MI.  
NET LENGTH = 3300 FT. = 0.625 MI.

STATE OF ILLINOIS  
DEPARTMENT OF TRANSPORTATION  
DIVISION OF HIGHWAYS

SUBMITTED SEPT 6 20 05

*[Signature]*  
DEPUTY DIRECTOR OF HIGHWAYS, REGION ENGINEER

October 14, 20 05  
*[Signature]*  
ENGINEER OF DESIGN AND ENVIRONMENT

October 14, 20 05  
*[Signature]*  
DEPUTY DIRECTOR OF HIGHWAYS, CHIEF ENGINEER

PRINTED BY THE AUTHORITY  
OF THE STATE OF ILLINOIS

9/2/2005 c:\pro\jects\8003205\det a11.dgn