

F.A.I. RTE.	SECTION	COUNTY	TOTAL SHEETS	SHEET NO.
57	*	IRROQUOIS	3	3
STA. TO STA.				
FED. ROAD DIST. NO.	ILLINOIS	FED. AID PROJECT		
* D3 TREE PLANTING 2006				

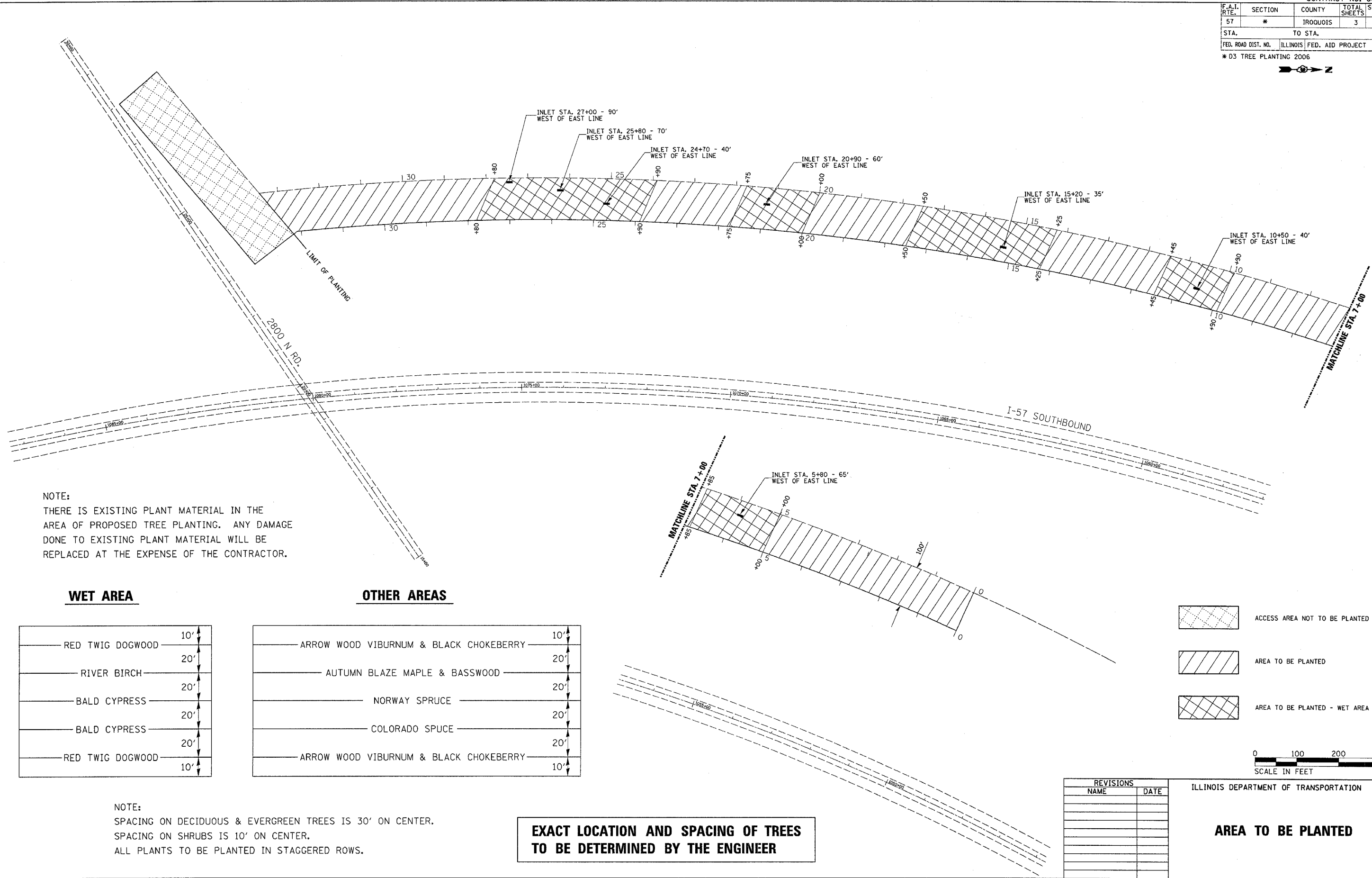

NOTE:
THERE IS EXISTING PLANT MATERIAL IN THE AREA OF PROPOSED TREE PLANTING. ANY DAMAGE DONE TO EXISTING PLANT MATERIAL WILL BE REPLACED AT THE EXPENSE OF THE CONTRACTOR.

WET AREA

RED TWIG DOGWOOD	10'
RIVER BIRCH	20'
BALD CYPRESS	20'
BALD CYPRESS	20'
RED TWIG DOGWOOD	10'

OTHER AREAS

ARROW WOOD VIBURNUM & BLACK CHOKEBERRY	10'
AUTUMN BLAZE MAPLE & BASSWOOD	20'
NORWAY SPRUCE	20'
COLORADO SPUCE	20'
ARROW WOOD VIBURNUM & BLACK CHOKEBERRY	10'

ACCESS AREA NOT TO BE PLANTED

AREA TO BE PLANTED

AREA TO BE PLANTED - WET AREA

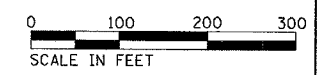

NOTE:
SPACING ON DECIDUOUS & EVERGREEN TREES IS 30' ON CENTER.
SPACING ON SHRUBS IS 10' ON CENTER.
ALL PLANTS TO BE PLANTED IN STAGGERED ROWS.

EXACT LOCATION AND SPACING OF TREES TO BE DETERMINED BY THE ENGINEER

REVISIONS	
NAME	DATE

ILLINOIS DEPARTMENT OF TRANSPORTATION

AREA TO BE PLANTED

9/2/2005 c:\p\proj\ecrs\w003205\view\011.dgn