

F.A.I. RTE.	SECTION	COUNTY	TOTAL SHEETS	SHEET NO.
57	*	IROQUOIS	3	1

*D3 TREE PLANTING 2006-2

STATE OF ILLINOIS
DEPARTMENT OF TRANSPORTATION

DIVISION OF HIGHWAYS

**PROPOSED
HIGHWAY PLANS**

FAI ROUTE 57 (I-57)
SECTION D3 TREE PLANTING 2006-2

IROQUOIS COUNTY

C - 93 - 055 - 05

TREE PLANTING

INDEX OF SHEETS

- 1 COVER SHEET
- 2 SUMMARY OF QUANTITIES & GENERAL NOTES
- 3 PLAN VIEW

STANDARDS

- 000001-04 STANDARD SYMBOLS, ABBREVIATIONS AND PATTERNS
- 001006 DECIMAL OF AN INCH AND OF A FOOT
- 701101-01 OFF-ROAD OPERATIONS MULTILANE, 4.5 m (15') TO 600 mm (24") FROM PAVEMENT EDGE
- 701106-01 OFF-ROAD OPERATIONS, MULTILANE, MORE THAN 4.5 m (15') AWAY
- 702001-05 TRAFFIC CONTROL DEVICES

MICROFILMED _____
 REEL NUMBER _____
 AWARDED _____
 RESIDENT ENGINEER _____
 AS BUILT CHANGES WERE MADE
 ON THE FOLLOWING SHEETS _____

J.U.L.I.E.
 JOINT UTILITY LOCATION INFORMATION FOR EXCAVATION
 1-800-892-0123

DISTRICT 3 NO. (815) 434-6131

PROJECT ENGINEER: D. BROVIAK
 UNIT CHIEF: G. BERTOLINO

CONTRACT # 66664

PROJECT LOCATION

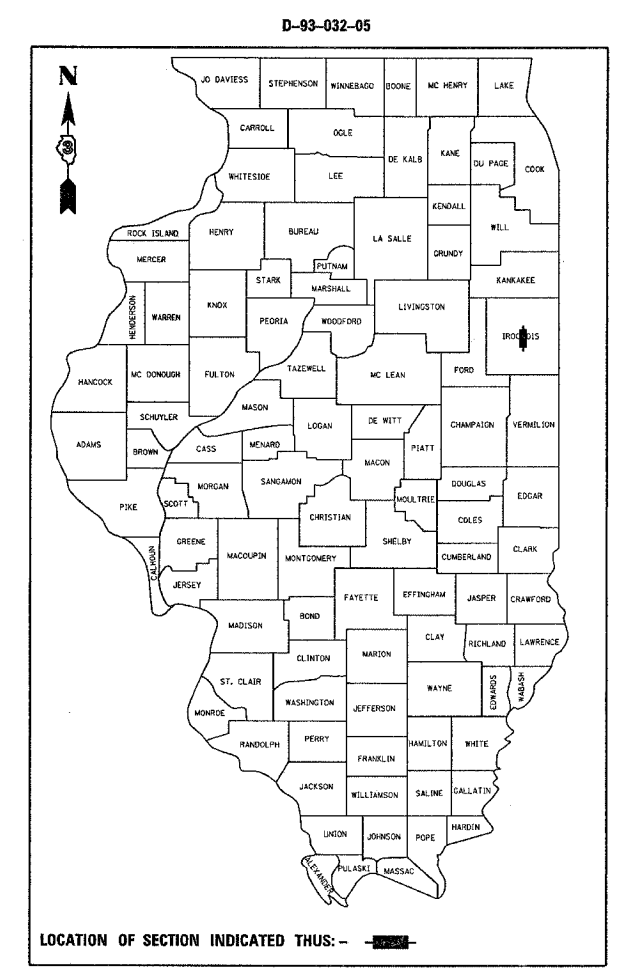
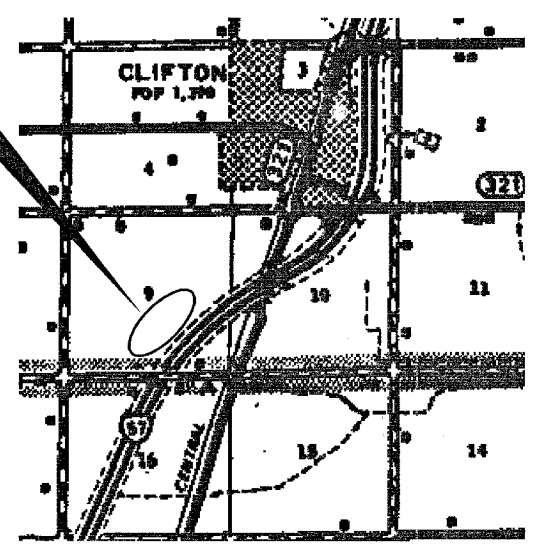

LOCATION OF SECTION INDICATED THIS: - [shaded box] -

STATE OF ILLINOIS
 DEPARTMENT OF TRANSPORTATION
 DIVISION OF HIGHWAYS

SUBMITTED SEPT 6 20 05

[Signature]
 DEPUTY DIRECTOR OF HIGHWAYS, REGION ENGINEER

October 14, 20 05
[Signature]
 ENGINEER OF DESIGN AND ENVIRONMENT

October 14, 20 05
[Signature]
 DEPUTY DIRECTOR OF HIGHWAYS, CHIEF ENGINEER

**PRINTED BY THE AUTHORITY
 OF THE STATE OF ILLINOIS**

GROSS LENGTH = 3300 FT. = 0.625 MI.
 NET LENGTH = 3300 FT. = 0.625 MI.

9/2/2005 c:\pro\jecs\8003205\det a11.dgn

F.A.I. RTE.	SECTION	COUNTY	TOTAL SHEETS	SHEET NO.
57	*	IROQUOIS	3	2
STA.		TO STA.		
FED. ROAD DIST. NO.	ILLINOIS FED. AID PROJECT			
*D3 TREE PLANTING 2006-2				

GENERAL NOTES
(Revised January 1, 2002)

SEEDING SHALL NOT BE PERMITTED AT ANY TIME WHEN THE GROUND IS FROZEN, WET, OR IN AN UNTILLABLE CONDITION. LOCATIONS TO BE SEEDD WILL BE DETERMINED BY THE ENGINEER.

ABANDONED UNDERGROUND UTILITIES THAT CONFLICT WITH CONSTRUCTION SHALL BE DISPOSED OF OUTSIDE THE LIMITS OF THE RIGHT OF WAY ACCORDING TO ARTICLE 202.03 OF THE STANDARD SPECIFICATIONS AND AS DIRECTED BY THE ENGINEER. THIS WORK WILL NOT BE PAID FOR SEPARATELY BUT SHALL BE INCLUDED IN THE COST OF MOBILIZATION

ANY REFERENCE TO A STANDARD IN THESE PLANS SHALL BE INTERPRETED TO MEAN THE EDITION AS INDICATED BY THE SUBNUMBER LISTED ON THE INDEX OF SHEETS OR THE COPY OF THE STANDARD INCLUDED IN THESE PLANS.

THE CONTRACTOR SHALL CONTACT JULIE AT LEAST 48 HOURS PRIOR TO EXCAVATION TO DETERMINE WHICH UTILITIES ARE IN THE AREA

SUMMARY OF QUANTITIES

CODE NO.	ITEM	UNIT	Y003
			TOTAL QUANTITY
A2000116	TREE, ACER X FREEMANII AUTUMN BLAZE (AUTUMN BLAZE FREEMAN MAPLE), 2" CALIPER, BALLED AND BURLAPPED	EACH	35
A2002366	TREE, BETULA NIGRA (RIVER BIRCH), 6' HEIGHT, CLUMP FORM, BALLED AND BURLAPPED	EACH	41
A2007616	TREE, TAXODIUM DISTICHUM (COMMON BALD CYPRESS), 2" CALIPER, BALLED AND BURLAPPED	EACH	82
A2007816	TREE, TILIA AMERICANA (AMERICAN LINDEN/ BASSWOOD), 2" CALIPER, BALLED AND BURLAPPED	EACH	35
C2C00524	SHRUB, ARONIA MELANOCARPA (BLACK CHOKE BERRY), 2' HEIGHT, CONTAINER	EACH	208
C2C01624	SHRUB, CORNUS SERICEA (REDOSIER DOGWOOD) 2' HEIGHT, CONTAINER	EACH	246
C2C11736	SHRUB, VIBURNUM DENTATUM (ARROWWOOD VIBURNUM), 3' HEIGHT, CONTAINER	EACH	208
D2001760	EVERGREEN, PICEA ABIES (NORWAY SPRUCE), 5' HEIGHT, BALLED AND BURLAPPED	EACH	20
D2002160	EVERGREEN, PICEA PUNGENS (COLORADO SPRUCE), 5' HEIGHT, BALLED AND BURLAPPED	EACH	70
67100100	MOBILIZATION	L.SUM	1

STATE OF ILLINOIS
DEPARTMENT OF TRANSPORTATION
DISTRICT THREE

REVIEWED BY: Steven B. Andrews
ACTING DISTRICT STUDIES & PLANS ENGINEER

DATE: SEPTEMBER 6, 2005

EXAMINED BY: Arthur K. [Signature]
DISTRICT CONSTRUCTION ENGINEER

Kenneth L. Langston
DISTRICT MATERIALS ENGINEER

James C. [Signature]
DISTRICT OPERATIONS ENGINEER

REVISIONS	
NAME	DATE

ILLINOIS DEPARTMENT OF TRANSPORTATION

**GENERAL NOTES &
SUMMARY OF QUANTITIES**

SCALE: VERT.
DATE: HORIZ.

DRAWN BY
CHECKED BY

F.A.I. RTE.	SECTION	COUNTY	TOTAL SHEETS	SHEET NO.
57	*	IRROUOIS	3	3
STA. TO STA.				
FED. ROAD DIST. NO.	ILLINOIS	FED. AID PROJECT		
* D3 TREE PLANTING 2006				

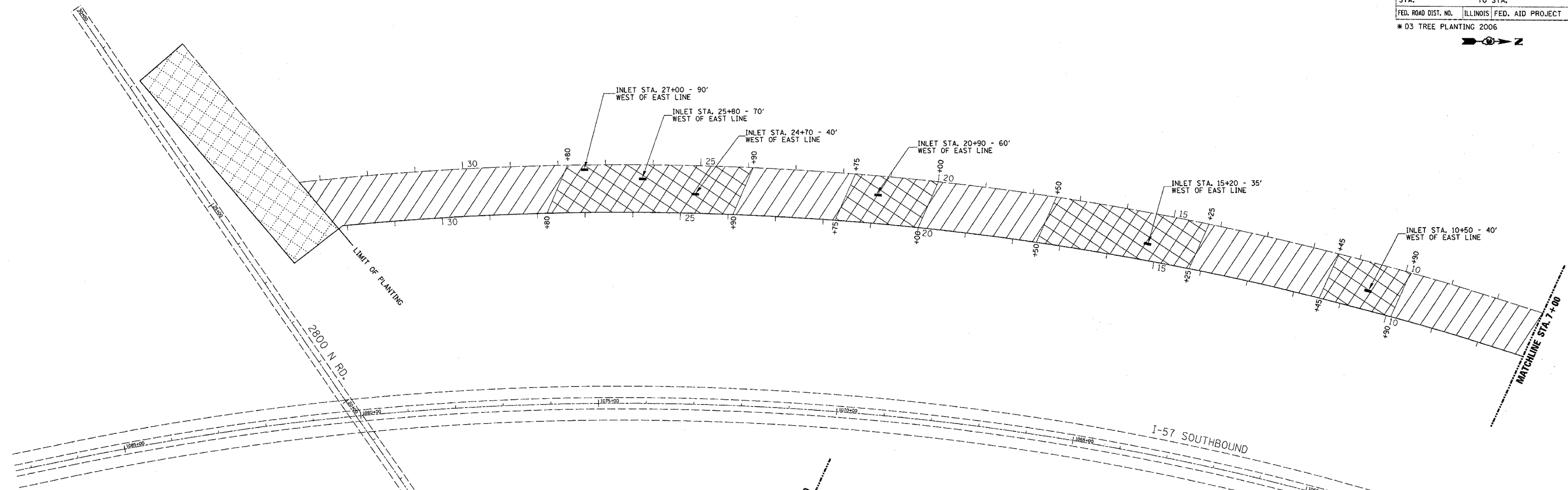
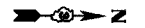

NOTE:
THERE IS EXISTING PLANT MATERIAL IN THE AREA OF PROPOSED TREE PLANTING. ANY DAMAGE DONE TO EXISTING PLANT MATERIAL WILL BE REPLACED AT THE EXPENSE OF THE CONTRACTOR.

WET AREA

RED TWIG DOGWOOD	10'
RIVER BIRCH	20'
BALD CYPRESS	20'
BALD CYPRESS	20'
RED TWIG DOGWOOD	10'

OTHER AREAS

ARROW WOOD VIBURNUM & BLACK CHOKEBERRY	10'
AUTUMN BLAZE MAPLE & BASSWOOD	20'
NORWAY SPRUCE	20'
COLORADO SPUCE	20'
ARROW WOOD VIBURNUM & BLACK CHOKEBERRY	10'

NOTE:
SPACING ON DECIDUOUS & EVERGREEN TREES IS 30' ON CENTER.
SPACING ON SHRUBS IS 10' ON CENTER.
ALL PLANTS TO BE PLANTED IN STAGGERED ROWS.

EXACT LOCATION AND SPACING OF TREES TO BE DETERMINED BY THE ENGINEER

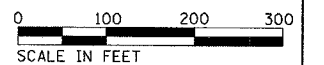
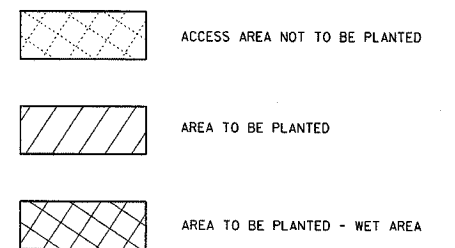

REVISIONS	
NAME	DATE

ILLINOIS DEPARTMENT OF TRANSPORTATION

AREA TO BE PLANTED