

RTE.	SECTION	COUNTY	TOTAL SHEETS	SHEET NO.
•	••	LIVINGSTON	10	1

• DWIGHT MAINTENANCE YARD
 •• (DWIGHT MAINTENANCE YARD)T

D-93-002-06



LOCATION OF SECTION INDICATED THUS: — ■ —

STATE OF ILLINOIS
 DEPARTMENT OF TRANSPORTATION
 DIVISION OF HIGHWAYS

**PROPOSED
 HIGHWAY PLANS**

O.R. 66 (OLD ROUTE 66)
 (DWIGHT MAINTENANCE YARD)T
 LIVINGSTON COUNTY
 DRAINAGE IMPROVEMENT
 C-93-080-06

INDEX OF SHEETS

1. COVER SHEET
2. GENERAL NOTES
3. SUMMARY OF QUANTITIES
4. GENERAL PLAN DETAILS
5. CROSS SECTIONS
6. SUB-BASE DETAILS
7. HEADWALL ANCHORING DETAILS
8. UPSTREAM HEADWALL DETAILS
9. DOWNSTREAM HEADWALL DETAILS
10. DECK/PAVEMENT DETAILS

STANDARDS

- | | |
|-----------|--|
| 000001-04 | STANDARD SYMBOLS, ABBREVIATIONS AND PATTERNS |
| 001001 | AREAS OF REINFORCEMENT BARS |
| 001006 | DECIMAL OF AN INCH AND OF A FOOT |
| 421001-01 | BAR REINFORCEMENT FOR CRC PAVEMENT |

PROJECT LOCATION

DWIGHT MAINTENANCE YARD
 1.1 MI. NORTH OF IL ROUTE 17 &
 ±300 FEET EAST OF O.R. 66
 (WEST EDGE CORPORATE LIMITS OF DWIGHT)
 PROPOSED S.N. 053-2041

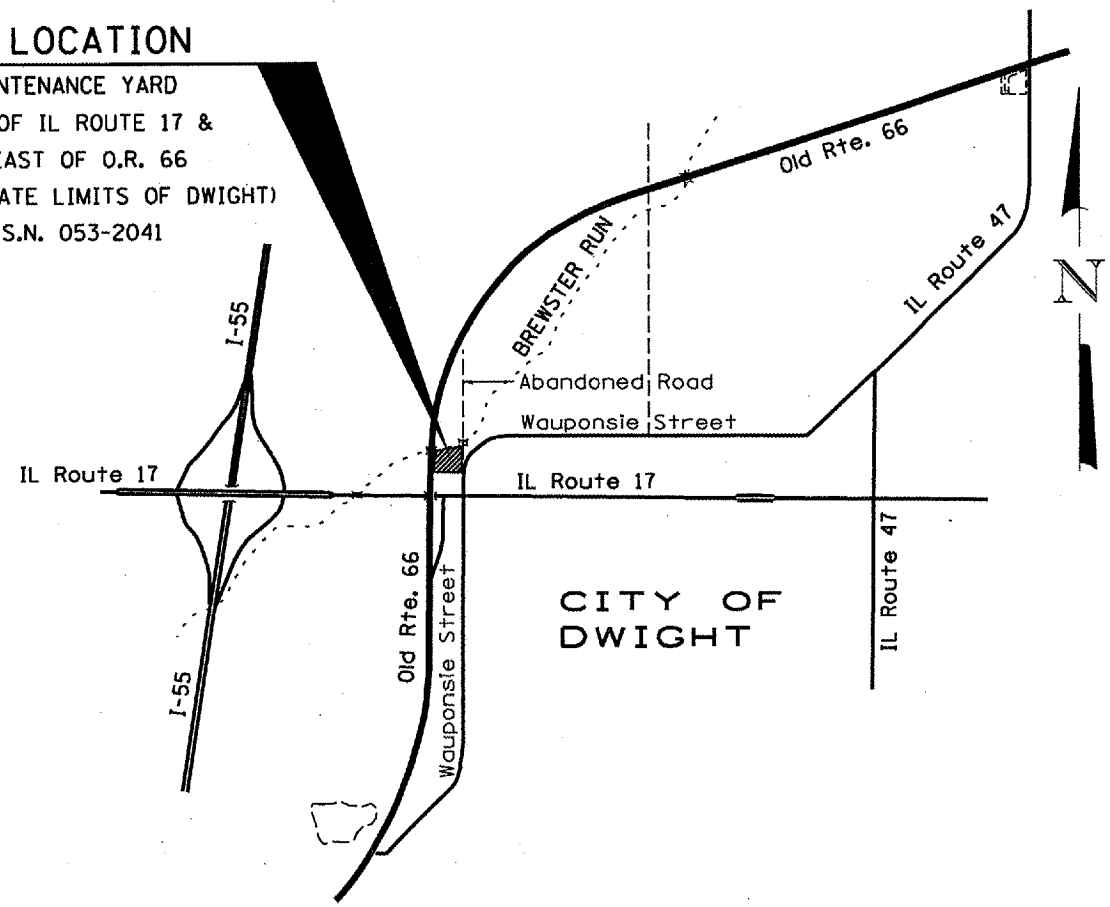

NOT TO SCALE

MICROFILMED _____
 REEL NUMBER _____
 AWARDED _____
 RESIDENT ENGINEER _____
 AS BUILT CHANGES WERE MADE
 ON THE FOLLOWING SHEETS _____

J.U.L.I.E.
 JOINT UTILITY LOCATION INFORMATION FOR EXCAVATION
 1-800-892-0123

DISTRICT 3 NO. (815) 434-6131
 PROJECT ENGINEER: JOE KANNEL (815)434-8420
 UNIT CHIEF: RON WOODSHANK (815)434-8419
 TOWNSHIP: DWIGHT

CONTRACT NO. 66673

STATE OF ILLINOIS
 DEPARTMENT OF TRANSPORTATION
 DIVISION OF HIGHWAYS

SUBMITTED 5/18 20 06
Angus Clark
 DEPUTY DIRECTOR OF HIGHWAYS, REGION ENGINEER

June 30, 20 06
Mike Hine
 ENGINEER OF DESIGN AND ENVIRONMENT

June 30, 20 06
Milton R. Sees, P.E.
 DIRECTOR OF HIGHWAYS, CHIEF ENGINEER

**PRINTED BY THE AUTHORITY
 OF THE STATE OF ILLINOIS**

DATE: March 27, 2006
 FILE: c:\projects\cma\m07\cm315\detail.s.dgn