

RTE.	SECTION	COUNTY	TOTAL SHEETS	SHEET NO.
		LIVINGSTON	10	4

- DWIGHT MAINTENANCE YARD
- (DWIGHT MAINTENANCE YARD)

GENERAL NOTES

Furnished excavation shall be placed adjacent to the concrete box culvert and behind the wingwalls, shaped and graded to match existing adjacent slopes after the concrete has been cured and the falsework removed.

All surfaces of the box and wingwalls which shall come in contact with porous granular embankment, or furnished excavation shall be waterproofed according to Article 503.18 of the Standard Specifications. Cost for this work shall be paid for according to Article 503.22 of the Standard Specifications.

BM #1 Chisled "X" in the northeast headwall of S.N. 053-C803 Elev. 100.00

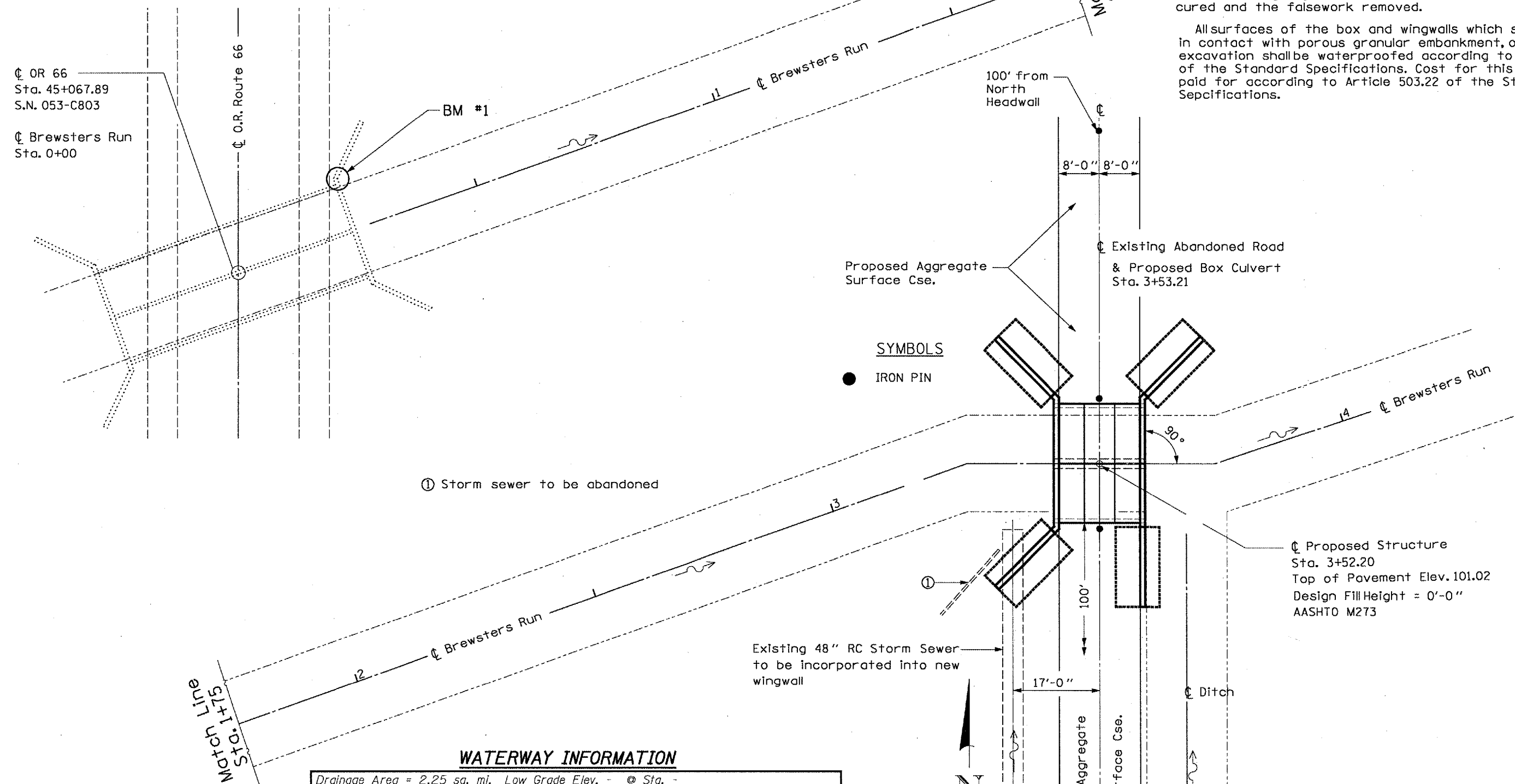

SYMBOLS

● IRON PIN

WATERWAY INFORMATION

Drainage Area = 2.25 sq. mi. Low Grade Elev. - @ Sta. -

Flood	Freq. Yr.	Q (cms)	Opening sq. m.		Nat. H.W.E.	Head - m.		Headwater El. (m.)	
			Exist.	Prop.		Exist.	Prop.	Exist.	Prop.
Design	50	10.97	-	13.23	-	192.74	0.07	-	192.81
Base	100	12.37	-	13.47	-	192.78	0.07	-	192.85
Overtopping	-	-	-	-	-	-	-	-	-
Max. Calc.	500	15.65	-	13.59	-	192.80	0.17	-	192.97

Note: Figures are in metric units

REVISIONS	
NAME	DATE

ILLINOIS DEPARTMENT OF TRANSPORTATION
GENERAL PLAN DETAILS
 (DWIGHT MAINTENANCE YARD)
 LIVINGSTON COUNTY
 S.N. 053-2041
 DATE: 02/24/2006 DRAWN BY: RW

DATE: March 27, 2006 FILE: c:\projects\cma\lno7\cm315\defal11s.dgn