

F.A. RTE.	SECTION	COUNTY	TOTAL SHEETS	SHEET NO.
FAS 1279	(6)DM	LASALLE	3	1
ILLINOIS PROJECT				

D-P3-042-06

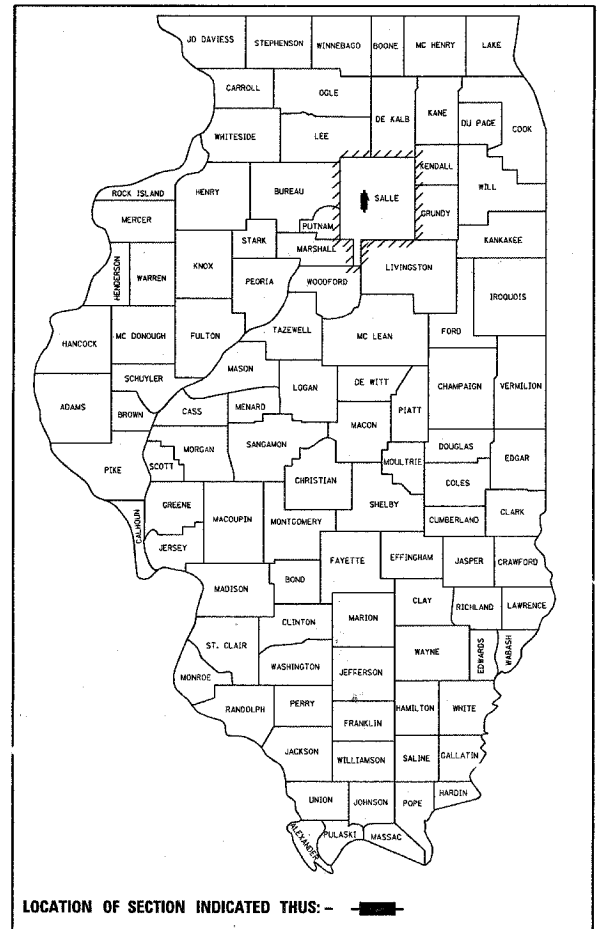

FUNCTION CLASSIFICATION  
MAJOR COLLECTOR - RURAL

2005 ADT = 4250  
P.V. = 83.5% S.U. = 10.3% M.U. = 6.2%

STATE OF ILLINOIS  
DEPARTMENT OF TRANSPORTATION  
DIVISION OF HIGHWAYS

SUBMITTED May 18 20 06  
Bruce L. Mast  
DEPUTY DIRECTOR OF HIGHWAYS, REGION ENGINEER

June 30 20 06  
Mike Lane  
ENGINEER OF DESIGN AND ENVIRONMENT

June 30 20 06  
Milton L. See, P.E.  
DIRECTOR OF HIGHWAYS, CHIEF ENGINEER

PRINTED BY THE AUTHORITY  
OF THE STATE OF ILLINOIS

STATE OF ILLINOIS  
DEPARTMENT OF TRANSPORTATION  
DIVISION OF HIGHWAYS

PROPOSED  
HIGHWAY PLANS

FAS ROUTE 1279 (IL 178)  
SECTION (6)DM  
LASALLE COUNTY  
PROJECT HD-1279(104)

C - 93 - 081 - 06

**TWO** BUILDING AND ONE FOUNDATION REMOVALS

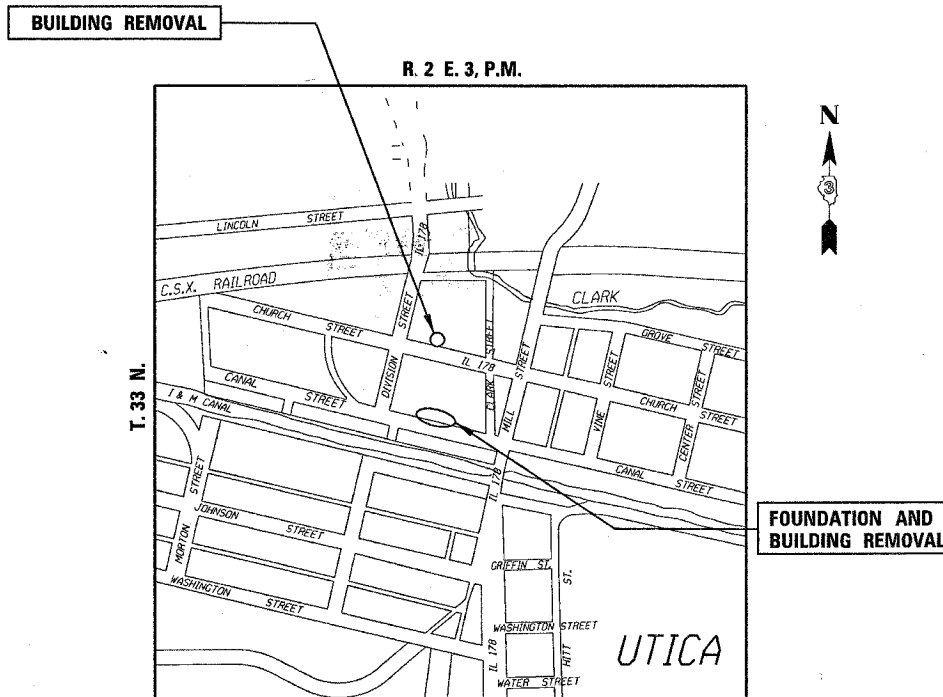

LOCATION MAP  
NOT TO SCALE

**NO REVIEW**

INDEX OF SHEETS

- 1 COVERSHEET
- 2 GENERAL NOTES, SCHEDULE & SUMMARY OF QUANTITIES
- 3 PLAN VIEW

HIGHWAY STANDARDS

- 000001-04 STANDARD SYMBOLS, ABBREVIATIONS AND PATTERNS
- 701001-01 OFF-ROAD OPERATIONS 2L, 2W, MORE THAN 4.5 m (15') AWAY
- 701006-02 OFF-ROAD OPERATIONS 2L, 2W, 4.5 m (15') TO 600 mm (24") FROM PAVEMENT EDGE
- 701301-02 LANE CLOSURE, 2L, 2W, SHORT TIME OPERATIONS
- 702001-06 TRAFFIC CONTROL DEVICES

MICROFILMED \_\_\_\_\_  
REEL NUMBER \_\_\_\_\_  
AWARDED \_\_\_\_\_  
RESIDENT ENGINEER \_\_\_\_\_  
AS BUILT CHANGES WERE MADE  
ON THE FOLLOWING SHEETS \_\_\_\_\_

JULIE 1-800-892-0123

DISTRICT 3 NO. (815) 434-6131

PROJECT ENGINEER: DAN DRAPER  
UNIT CHIEF: BRAD DUNCAN  
TOWNSHIP: UTICA

CONTRACT NO. 66674

**REVISED**  
7-19-06