

F.A.I. RTE.	SECTION	COUNTY	TOTAL SHEETS	SHEET NO.
39	150-4B1-4	LASALLE	1817	5
FED. ROAD DIST. NO.		ILLINOIS	NON-FED. AID PROJECT	

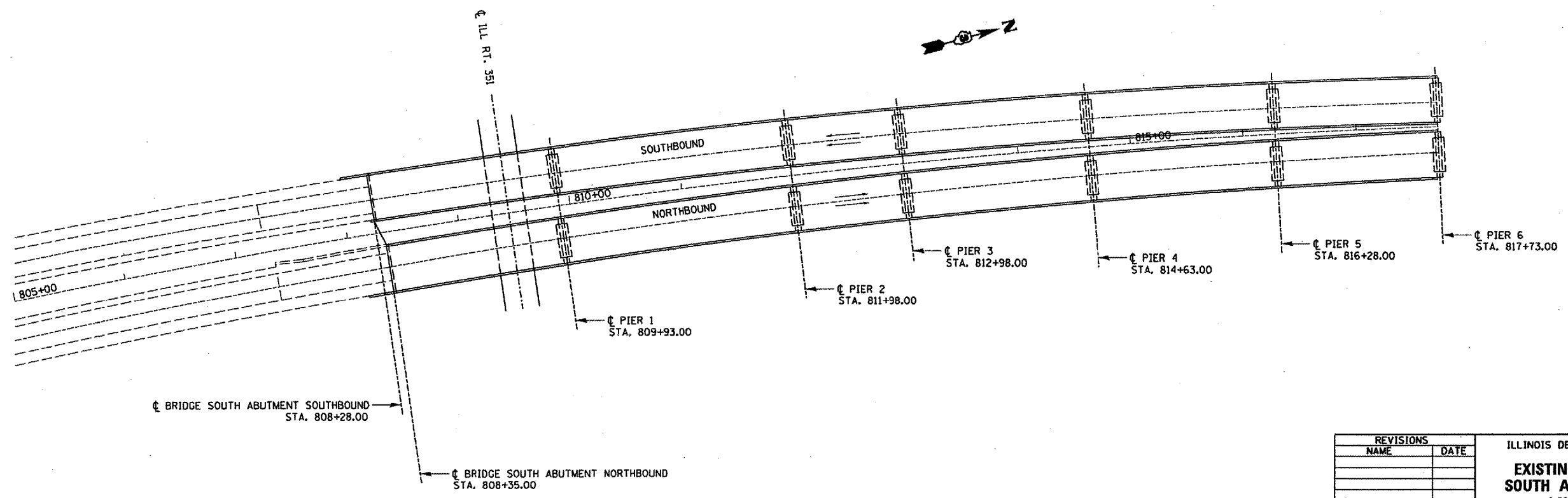
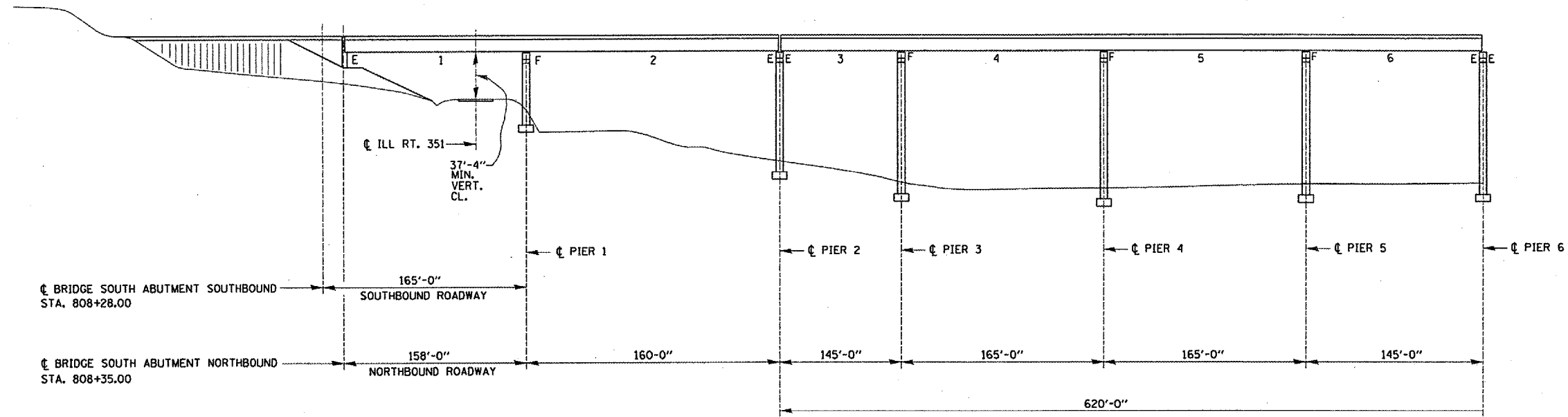

DATE: 05/01/2006
C:\PROJECTS\2005\PLAN\ABE LINCOLN\66678\DETAILS.DGN

REVISIONS	
NAME	DATE

ILLINOIS DEPARTMENT OF TRANSPORTATION
EXISTING PLAN & ELEVATION
SOUTH ABUTMENT THRU PIER 6
 I-39 OVER THE ILLINOIS RIVER
 F.A.I. ROUTE 39
 SECTION: (50-4B)1-4
 LASALLE COUNTY
 S.N. 050-0191