

F.A.P. RTE.	SECTION	COUNTY	TOTAL SHEETS	SHEET NO.
701	(128BR)I-1	TAZEWELL	30	1

STATE OF ILLINOIS  
DEPARTMENT OF TRANSPORTATION  
DIVISION OF HIGHWAYS

# PROPOSED HIGHWAY PLANS

FAP ROUTE 701 (IL 122)  
SECTION (128 BR)I-1  
TAZEWELL COUNTY  
C-94-075-05

INDEX OF SHEETS:

1. COVER SHEET
- 2-3. COMMITMENTS & GENERAL NOTES
- 4-6. SUMMARY OF QUANTITIES
7. TYPICAL SECTIONS
8. QUANTITIES NOT OTHERWISE SHOWN
9. GENERAL SITE PLAN
10. BUTT JOINT DETAIL
11. TRAFFIC STAGING & CONTROL
12. PLAN AND ELEVATION
13. STAGE CONSTRUCTION DETAIL
- 14-22. BRIDGE REPAIR DETAILS
- 23-30. SCOUR MITIGATION PLAN

STANDARDS REQUIRED:

- 420401-05 701101-01 702001-06  
515001-02 701106-01 704001-02  
630001-06 701201-02 780001-01  
631031-05 701306-01 781001-02  
631032-02 701321-08

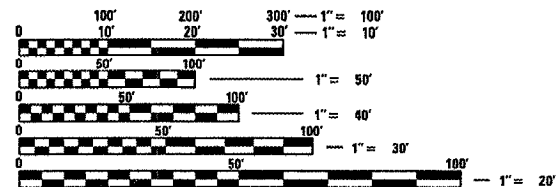

FULL SIZE PLANS HAVE BEEN PREPARED USING STANDARD ENGINEERING SCALES. REDUCED SIZED PLANS WILL NOT CONFORM TO STANDARD SCALES. IN MAKING MEASUREMENTS ON REDUCED PLANS, THE ABOVE SCALES MAY BE USED.

J.U.L.I.E.  
JOINT UTILITY LOCATION INFORMATION FOR EXCAVATION  
1-800-892-0123

CONTRACT NO. 68484 CAT. NO. 033065-00D

DESIGNER: CLARK JONES  
PHONE NO: (309) 671-3452

PROJECT ENGINEER: JIM MILLER  
PHONE NO: (309) 671-3451

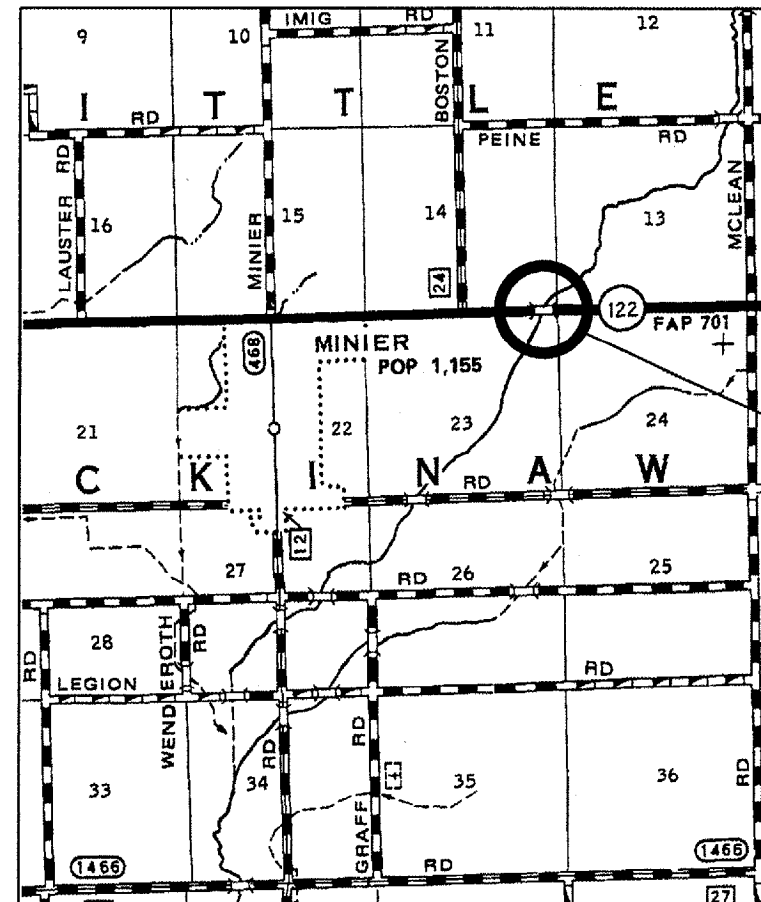

LOCATION MAP

SCOUR MITIGATION AND DECK BEAM REPLACEMENT ON STRUCTURE CARRYING IL. 122 OVER SUGAR CREEK (SN. 090-0058), 1 MILE EAST OF MINIER

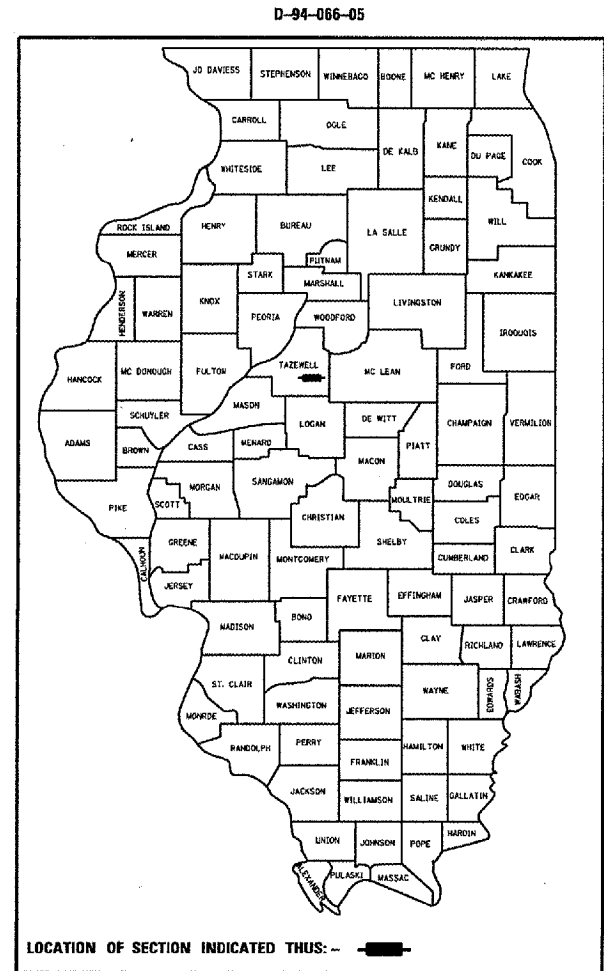

LOCATION OF SECTION INDICATED THUS: -

STATE OF ILLINOIS  
DEPARTMENT OF TRANSPORTATION  
DIVISION OF HIGHWAYS

SUBMITTED 3/31/06

*Joseph E. Crowe*  
DEPUTY DIRECTOR OF HIGHWAYS, REGION ENGINEER

May 12, 2006  
*Mike Sene*  
ENGINEER OF DESIGN AND ENVIRONMENT

May 12, 2006  
*Milton R. Sene, P.E.*  
DIRECTOR OF HIGHWAYS, CHIEF ENGINEER

PRINTED BY THE AUTHORITY  
OF THE STATE OF ILLINOIS