

F.A.S. RTE.	SECTION	COUNTY	TOTAL SHEETS	SHEET NO.
1671		DOUGLAS	181	21
STA.		TO STA.		
FED. ROAD DIST. NO.	ILLINOIS	FED. AID PROJECT		
• 1445BR-2 & 22VBR-1				

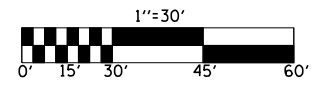

PRE-STAGE PLAN

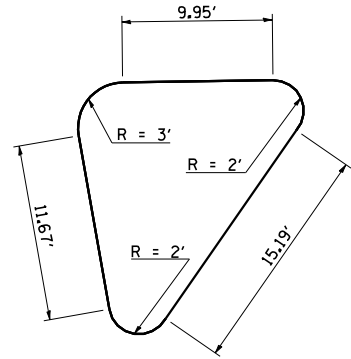

DETAIL OF CONCRETE MEDIAN TYPE SM-6 (DOWELLED)

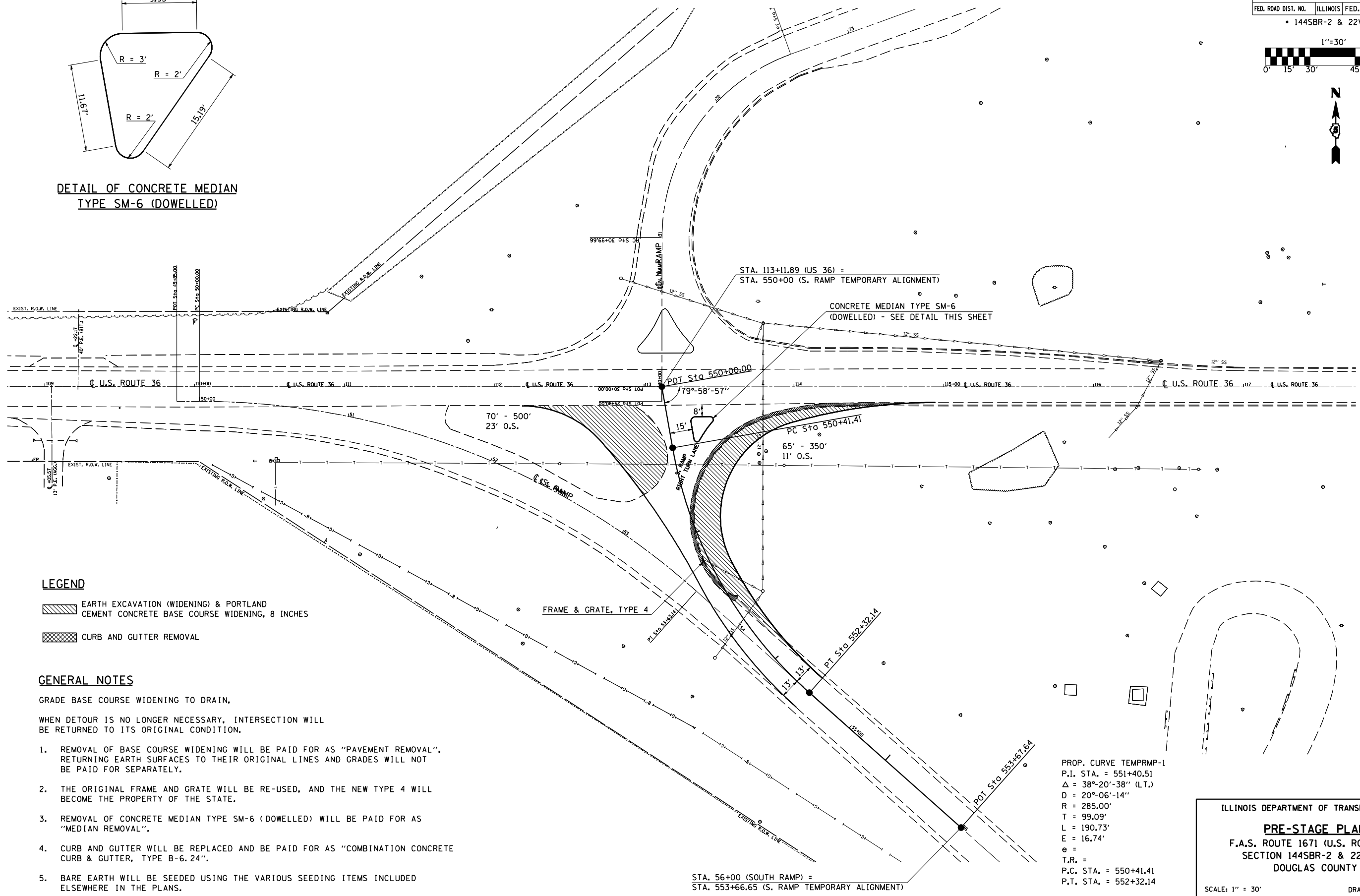

LEGEND

- EARTH EXCAVATION (WIDENING) & PORTLAND CEMENT CONCRETE BASE COURSE WIDENING, 8 INCHES
- CURB AND GUTTER REMOVAL

GENERAL NOTES

- GRADE BASE COURSE WIDENING TO DRAIN.
- WHEN DETOUR IS NO LONGER NECESSARY, INTERSECTION WILL BE RETURNED TO ITS ORIGINAL CONDITION.
1. REMOVAL OF BASE COURSE WIDENING WILL BE PAID FOR AS "PAVEMENT REMOVAL". RETURNING EARTH SURFACES TO THEIR ORIGINAL LINES AND GRADES WILL NOT BE PAID FOR SEPARATELY.
 2. THE ORIGINAL FRAME AND GRATE WILL BE RE-USED, AND THE NEW TYPE 4 WILL BECOME THE PROPERTY OF THE STATE.
 3. REMOVAL OF CONCRETE MEDIAN TYPE SM-6 (DOWELLED) WILL BE PAID FOR AS "MEDIAN REMOVAL".
 4. CURB AND GUTTER WILL BE REPLACED AND BE PAID FOR AS "COMBINATION CONCRETE CURB & GUTTER, TYPE B-6.24".
 5. BARE EARTH WILL BE SEEDING USING THE VARIOUS SEEDING ITEMS INCLUDED ELSEWHERE IN THE PLANS.

PROP. CURVE TEMPRMP-1
 P.I. STA. = 551+40.51
 $\Delta = 38^{\circ}20'38''$ (LT.)
 $D = 20^{\circ}06'14''$
 $R = 285.00'$
 $T = 99.09'$
 $L = 190.73'$
 $E = 16.74'$
 $e =$
 $T.R. =$
 P.C. STA. = 550+41.41
 P.T. STA. = 552+32.14

ILLINOIS DEPARTMENT OF TRANSPORTATION

PRE-STAGE PLAN

F.A.S. ROUTE 1671 (U.S. ROUTE 45)
 SECTION 1445BR-2 & 22VBR-1
 DOUGLAS COUNTY

SCALE: 1" = 30'
 DATE: 06/14/06

DRAWN BY: B.B.P.
 CHECKED BY: C.R.G.

PLOT DATE = 7/10/2006
 FILE NAME = c:\projects\05202 (v8)\70258tr-affr\control.dgn
 PLOT SCALE = 63.5294 / IN.
 USER NAME = piersebr