

F.A.S. RTE.	SECTION	COUNTY	TOTAL SHEETS	SHEET NO.
1671		DOUGLAS	181	33
STA. 1157+00		TO STA. 1163+00		
FED. ROAD DIST. NO.		ILLINOIS FED. AID PROJECT		
• 1445BR-2 & 22VBR-1				

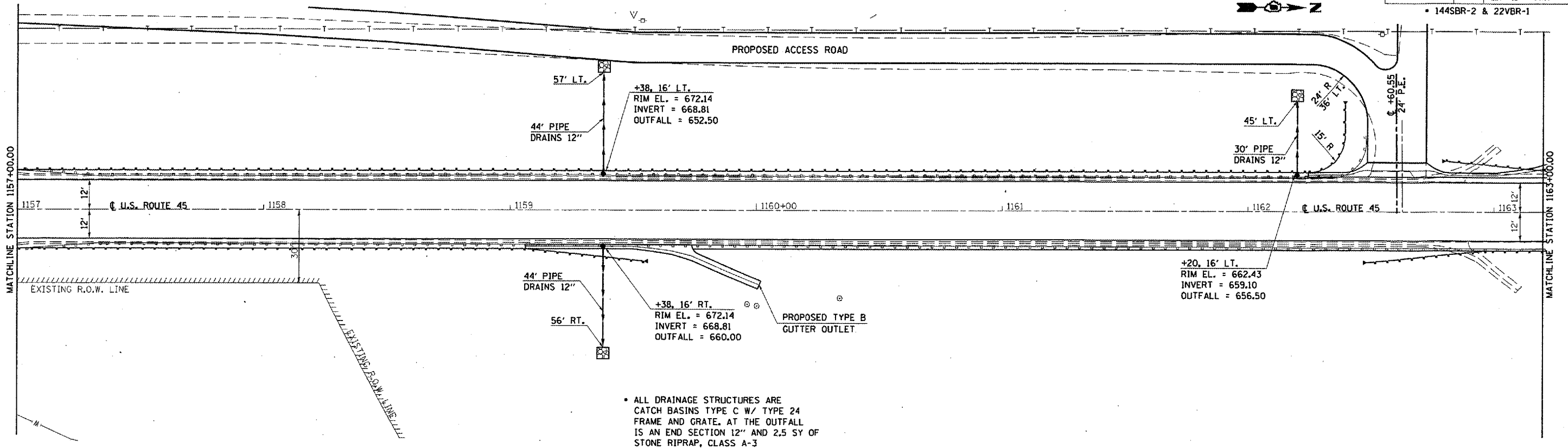
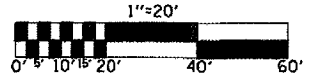

• ALL DRAINAGE STRUCTURES ARE CATCH BASINS TYPE C W/ TYPE 24 FRAME AND GRATE. AT THE OUTFALL IS AN END SECTION 12" AND 2.5 SY OF STONE RIPRAP, CLASS A-3

PLAN	SURVEYED	DATE
NO. _____	BY _____	_____
NOTE BOOK NO. _____	DATE CHECKED _____	
NO. _____	BY _____	_____
DATE _____		

PROFILE	SURVEYED	DATE
NO. _____	BY _____	_____
NOTE BOOK NO. _____	DATE CHECKED _____	
NO. _____	BY _____	_____
DATE _____		

PLOT DATE = 7/18/2006  
 FILE NAME = c:\p\projects\d995202\c9\p1&p2.dgn  
 PLOT SCALE = 42.3529 / IN.  
 USER NAME = c995202

