

F.A.S. RTE.	SECTION	COUNTY	TOTAL SHEETS	SHEET NO.
1671	*	DOUGLAS	181	41
STA. 1153+41.48		TO STA. 1157+50.00		
FED. ROAD DIST. NO.	ILLINOIS	FED. AID PROJECT		

• 144SBR-2 & 22VBR-1

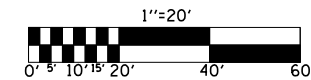

SEC. 33, T. 16 N., R. 8 E. OF THE 3rd P.M.

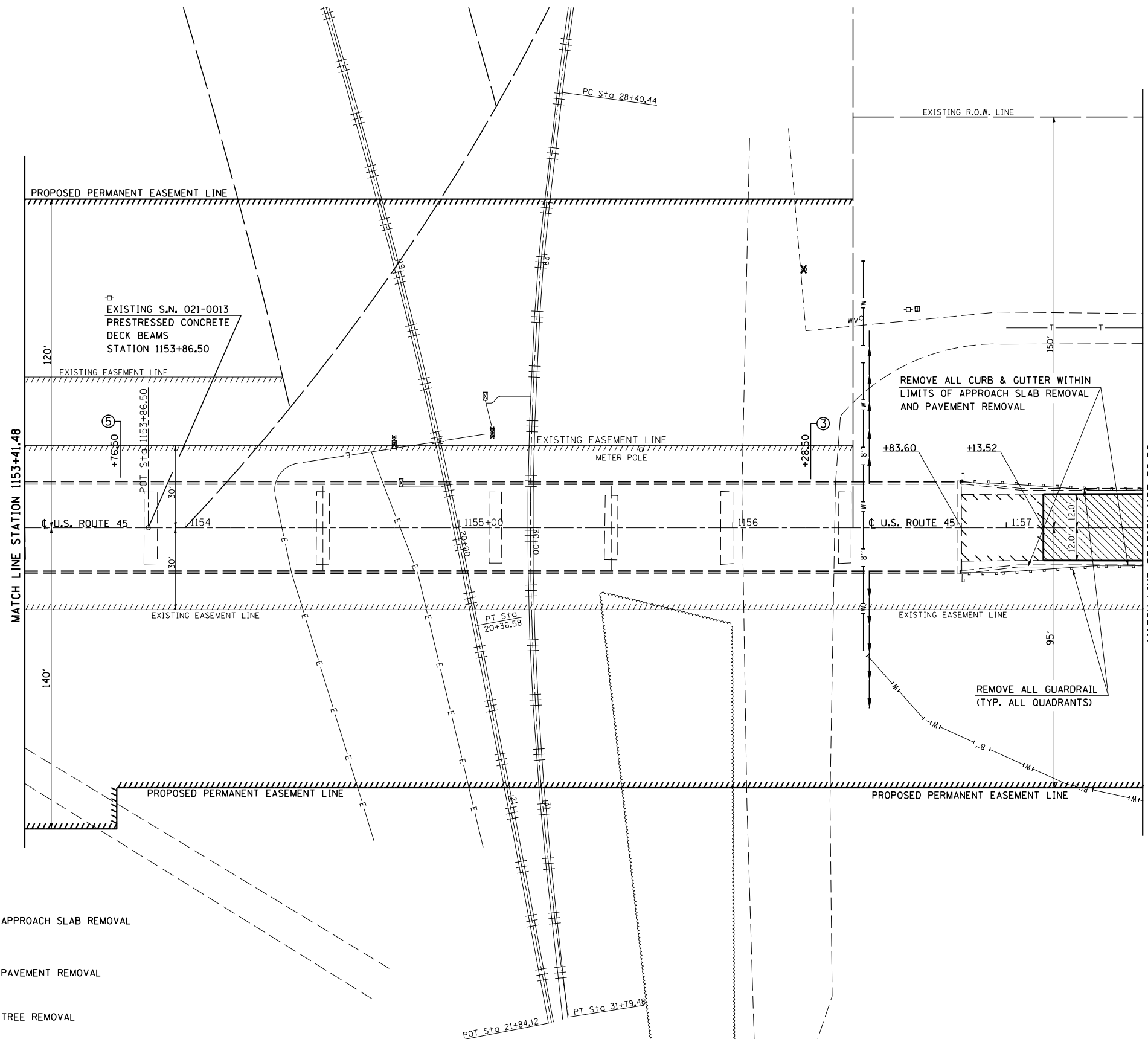

- APPROACH SLAB REMOVAL
- PAVEMENT REMOVAL
- X** TREE REMOVAL

SEC. 34, T. 16 N., R. 8 E. OF THE 3rd P.M.

ILLINOIS DEPARTMENT OF TRANSPORTATION
REMOVAL PLAN
 F.A.S. ROUTE 1671 (U.S. ROUTE 45)
 SECTION 144SBR-2 & 22VBR-1
 DOUGLAS COUNTY

SCALE: 1" = 20'-0"
 DATE: 05/31/06

DRAWN BY: B.B.P.
 CHECKED BY: C.R.G.

PLOT DATE = 7/10/2006
 FILE NAME = G:\projects\0505202 (v8)\70258removal.dgn
 PLOT SCALE = 1/4" = 1' / IN.
 USER NAME = crg