

F.A.S. RTE.	SECTION	COUNTY	TOTAL SHEETS	SHEET NO.
1671	.	DOUGLAS	181	46
STA. 1132+50.00		TO STA. 1138+50.57		
FED. ROAD DIST. NO.	ILLINOIS	FED. AID PROJECT		

• 144SBR-2 & 22VBR-1

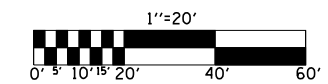

SEC. 33, T. 16 N., R. 8 E. OF THE 3rd P.M.

EXISTING CURVE
 PI STA. = 36+32.05
 Δ = 25° 26' 12" (RT)
 D = 20° 20' 19"
 R = 281.71'
 T = 63.58'
 L = 125.06'
 E = 7.09'
 P.C. STA. = 35+68.47
 P.T. STA. = 36+93.54

EXISTING CURVE DATA US 45
 PI STA. = 1137+10.26
 Δ = 6° 42' 07" (LT)
 D = 0° 49' 22"
 R = 6,964.64'
 T = 407.79'
 L = 814.65'
 E = 11.93'
 e = -----
 T.R. = -----
 S.E. RUN = -----
 P.C. STA = 1133+02.47
 P.T. STA = 1141+17.12

STATION 1134+07.97 (C U.S. 45) =
 STATION 37+99.68 (C N. RAMP)

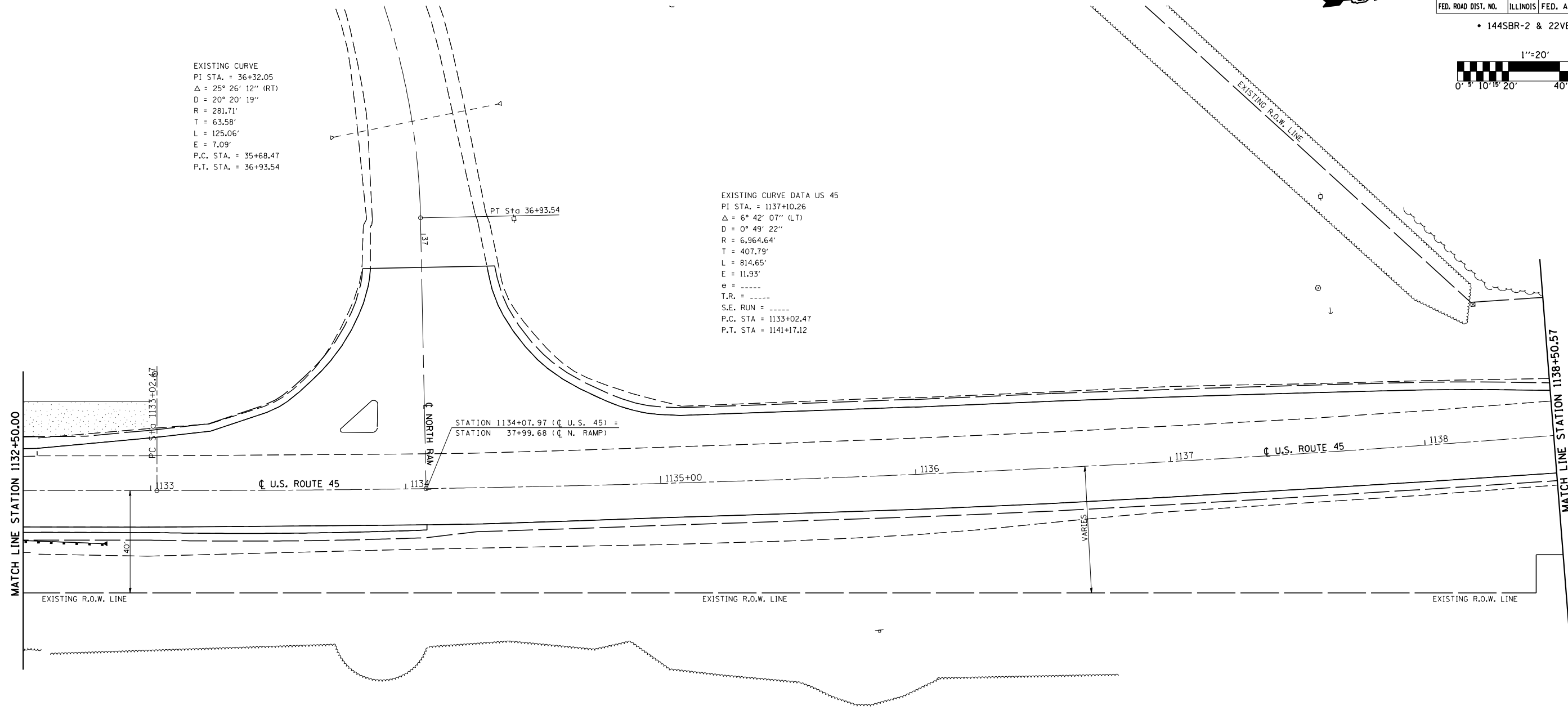

SEC. 34, T. 16 N., R. 8 E. OF THE 3rd P.M.

ILLINOIS DEPARTMENT OF TRANSPORTATION
EROSION CONTROL PLAN
 F.A.S. ROUTE 1671 (U.S. ROUTE 45)
 SECTION 144SBR-2 & 22VBR-1
 DOUGLAS COUNTY

SCALE: 1" = 20'-0"
 DATE: 06/02/06

DRAWN BY: B.B.P.
 CHECKED BY: C.R.G.

PLOT DATE = 7/10/2006
 FILE NAME = G:\projects\0505202 (v8)\70258\erosion.dgn
 DATE = 02/25/06
 USER NAME = crgre