

F.A.S. RTE.	SECTION	COUNTY	TOTAL SHEETS	SHEET NO.
1671	.	DOUGLAS	181	58
STA. 1149+50.00		TO STA. 1153+41.48		
FED. ROAD DIST. NO.	ILLINOIS	FED. AID PROJECT		

• 144SBR-2 & 22VBR-1

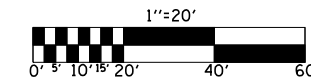

SEC. 33, T. 16 N., R. 8 E. OF THE 3rd P.M.

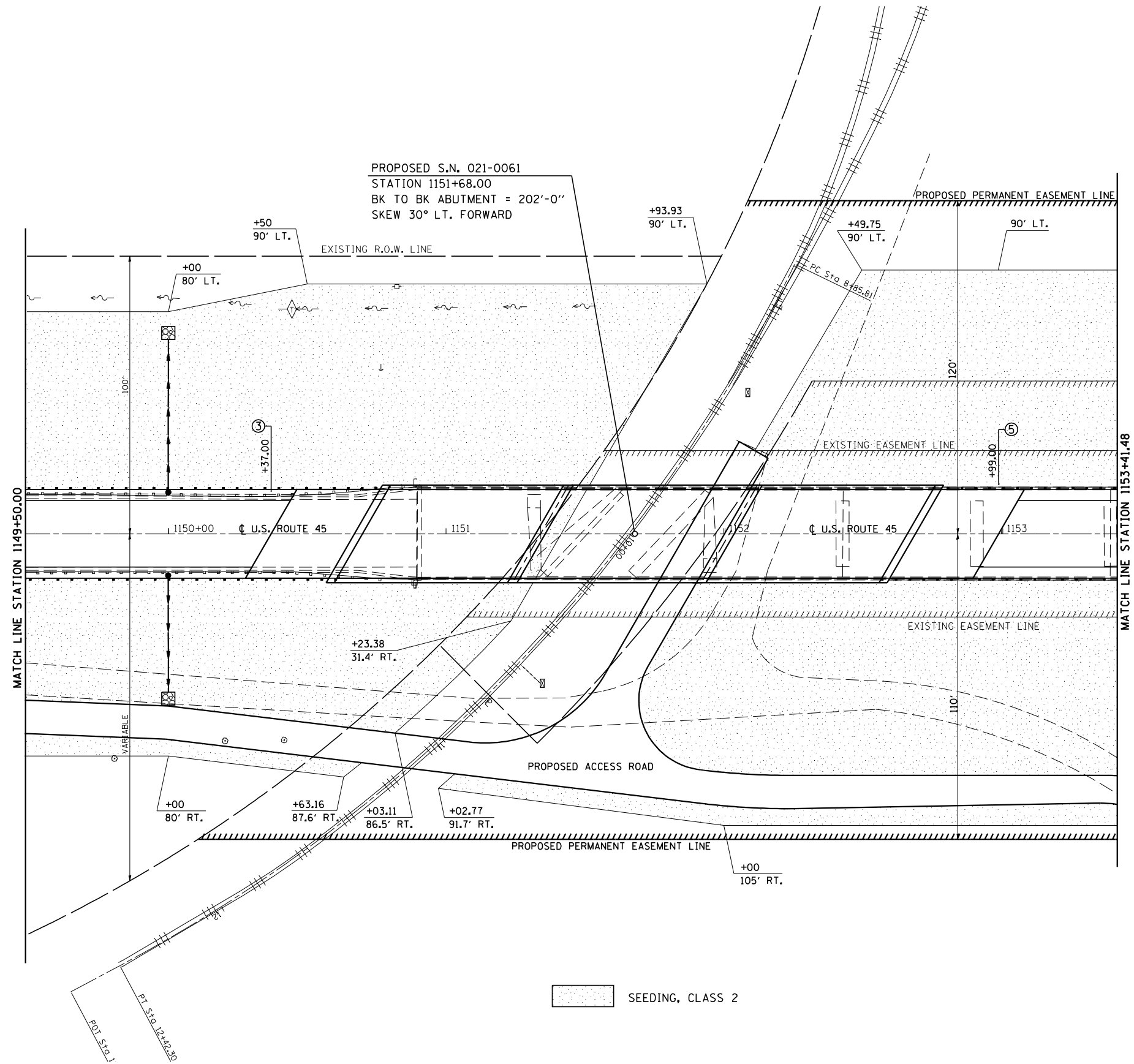

SEC. 34, T. 16 N., R. 8 E. OF THE 3rd P.M.

SEEDING, CLASS 2

PLOT DATE = 7/10/2006  
 FILE NAME = c:\projects\144SBR-2 & 22VBR-1\144SBR-2 & 22VBR-1.dgn  
 USER NAME = crg

ILLINOIS DEPARTMENT OF TRANSPORTATION  
**SEEDING PLAN**  
 F.A.S. ROUTE 1671 (U.S. ROUTE 45)  
 SECTION 144SBR-2 & 22VBR-1  
 DOUGLAS COUNTY

SCALE: 1" = 20'-0"  
 DATE: 06/05/06

DRAWN BY: B.B.P.  
 CHECKED BY: C.R.G.