

F.A.P. RTE.	SECTION	COUNTY	TOTAL SHEETS	SHEET NO.
332	48B	VERMILION	27	17

CONTRACT NO. 70462

**POROUS GRANULAR BACKFILL
PAY LIMITS DETAIL**

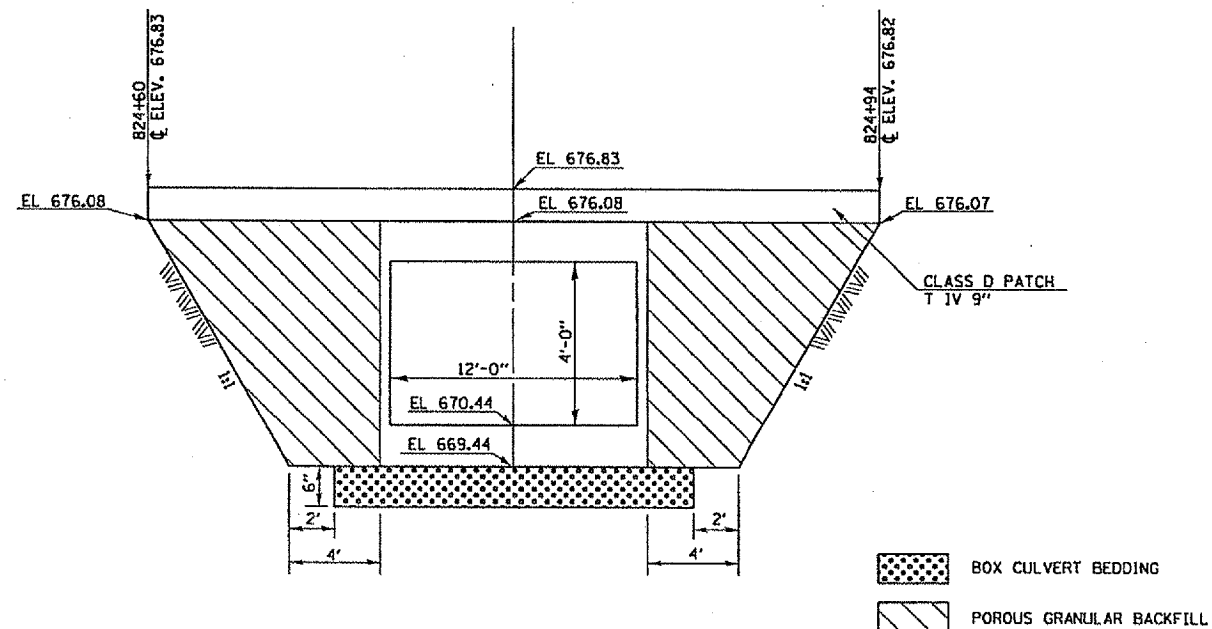

**DETAIL OF DEPRESSING GUTTER GRADE AT
INLETS, CATCH BASINS AND MANHOLES**

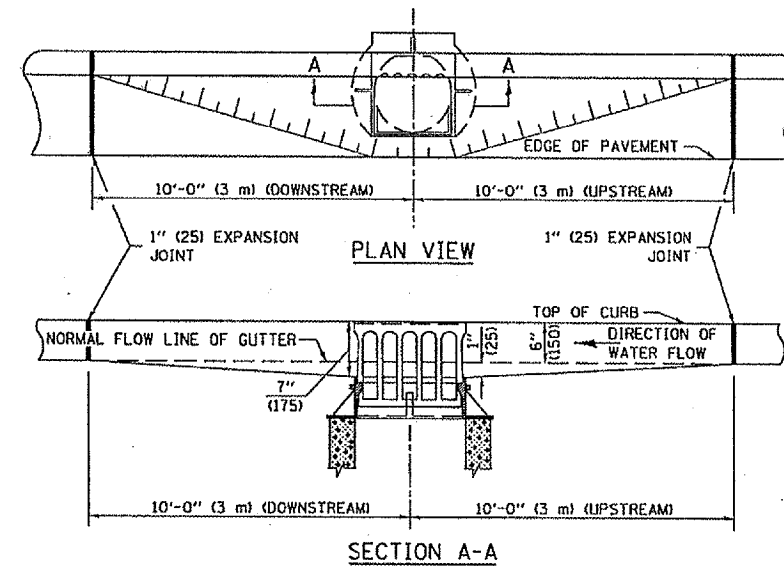

GENERAL NOTES

1. THE TWO EXPANSION JOINTS SHALL BE PLACED AS SHOWN IN STANDARD 606001.
2. THE GUTTER GRADE SHALL BE DEPRESSING AT ALL INLETS, CATCH BASINS AND MANHOLES UNLESS OTHERWISE SPECIFIED IN THE PLANS.
3. THE COST OF THIS WORK SHALL BE INCLUDED IN THE COST OF THE VARIOUS PAY ITEMS OF WORK INVOLVED.

DESIGNED	NAME	DATE	REVISIONS	DATE
J.M.H.	J.M.H.	11/87		
CHECKED	F.M.S.	11/87	D.L.P.	10/96
CADD NO.	A-1.33		R.A.G.	06/03

ALL DIMENSIONS ARE IN INCHES (MILLIMETERS) UNLESS OTHERWISE SHOWN.

CENTERLINE SKETCH

