

# SECTION CORNER AND ALIGNMENT TIES

F.A.S. RTE.	SECTION	COUNTY	TOTAL SHEETS	SHEET NO.
500	*	VERMILION	18	11

• (33,116 SPURRS-1  
CONTRACT NO. 70556

TIES TO P.T. STA. 189+34.42  
NW COR. SEC. 33-21N-11W

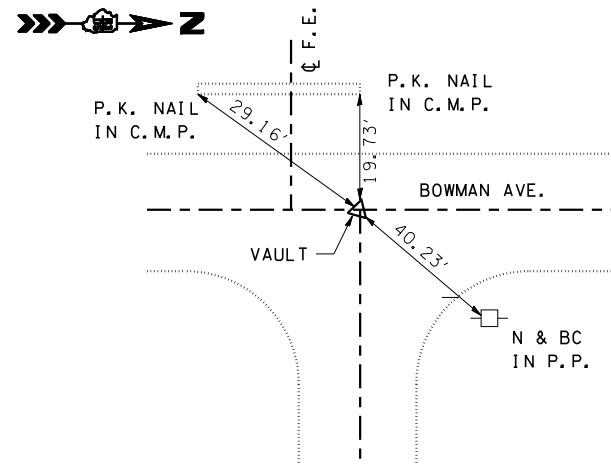

PERMANENT SURVEY MARKERS  
TO BE ADJUSTED - 1 EACH

TIES TO P.T. STA. 192+34.42

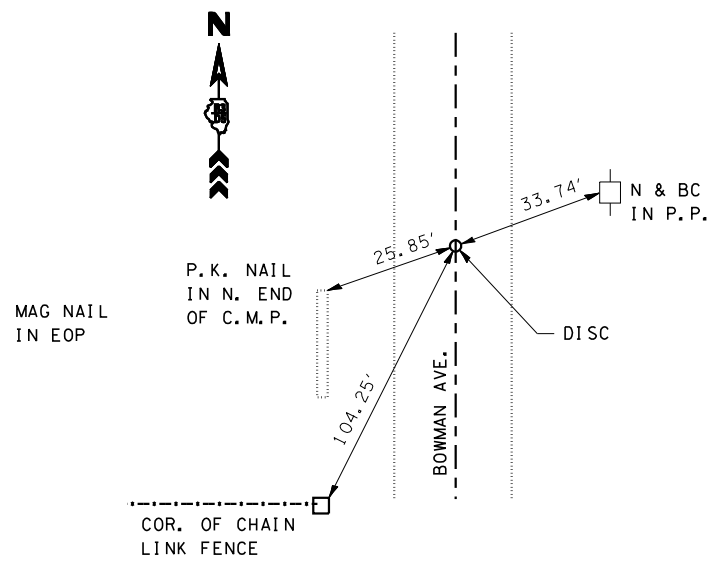

SURVEY MARKER VAULT - 1 EACH

TIES TO P.I.  
(FAS 500 & BISMARCK RD.)  
STA. 269+42.93 (BOWMAN)  
= STA. 142+32.65 (BISMARCK RD.)

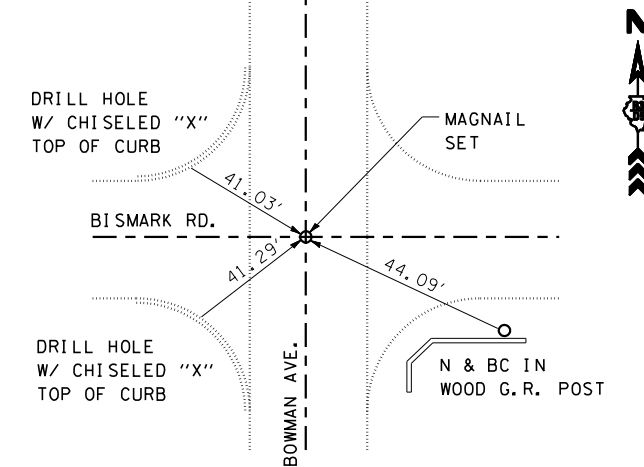

SURVEY MARKER VAULT - 1 EACH