

F.A.I. RTE.	SECTION	COUNTY	TOTAL SHEETS	SHEET NO.
72	(74-68)MRS	PIATT	10	7
STA. 1320+00		TO STA. 1351+00		
FED. ROAD DIST. NO.	ILLINOIS	FED. AID PROJECT		

EXIST. CURVE 17 (FAI 72)
 PI STA. = 1332+18.93
 $\Delta = 37^\circ 15' 37''$ (LT)
 $D = 1^\circ 30' 00''$
 $R = 3,819.71'$
 $T = 1,287.71'$
 $L = 2,484.01'$
 $E = 211.22'$
 $e = \text{-----}$
 $T.R. = \text{-----}$
 $S.E. \text{ RUN} = \text{-----}$
 $P.C. \text{ STA.} = 1319+31.22$
 $P.T. \text{ STA.} = 1344+15.23$

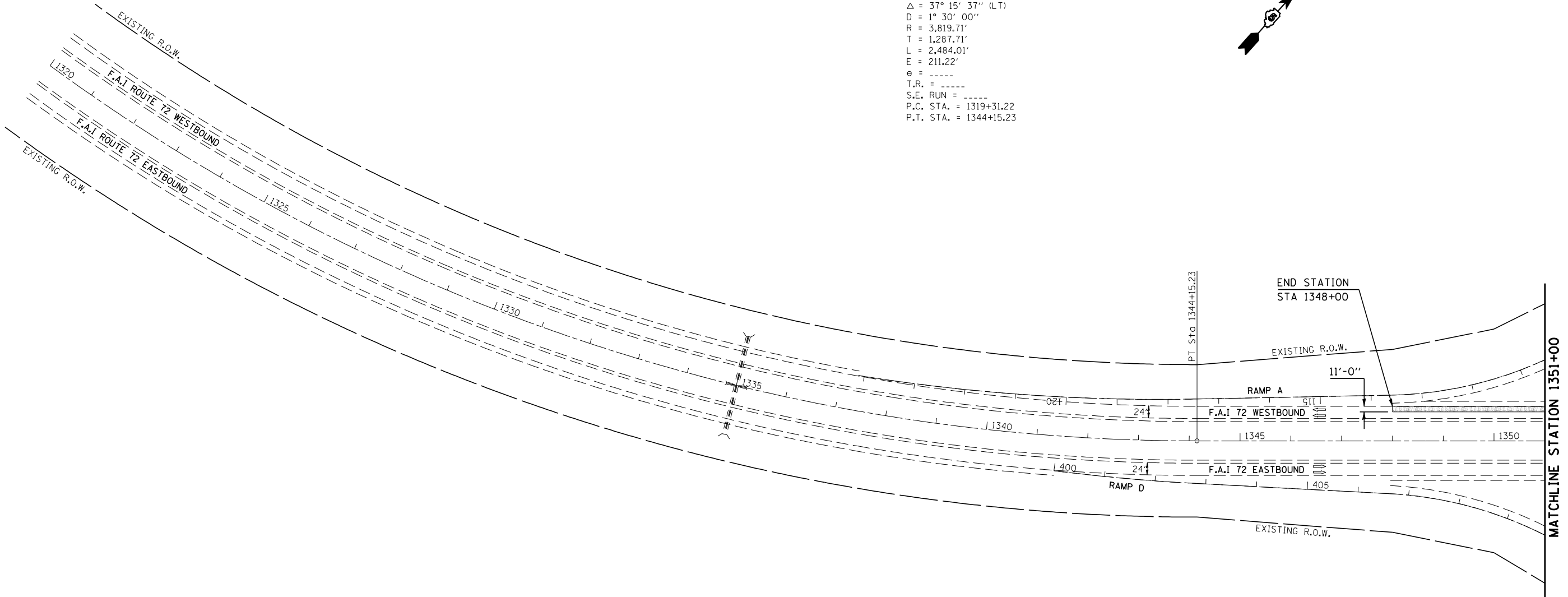

LEGEND	
	BITUMINOUS SURFACE REMOVAL 3 1/4 "

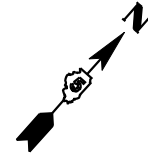
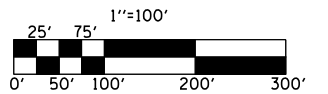

REVISIONS	
NAME	DATE

ILLINOIS DEPARTMENT OF TRANSPORTATION
PLAN VIEW
 F.A.I. ROUTE 72
 SECTION (74-68)MRS
 PIATT COUNTY
 SCALE: 1" = 100'
 DATE: 05/01/06
 DRAWN BY: CADD
 CHECKED BY:

PLOT DATE = 5/19/2006
 FILE NAME = c:\projects\view\507206\8\70558sheets.dgn
 PLOT SCALE = 211.7647 / IN.
 USER NAME = blackrt