

F.A.I. RTE.	SECTION	COUNTY	TOTAL SHEETS	SHEET NO.
72	(74-68)MRS	PIATT	10	1

STATE OF ILLINOIS  
DEPARTMENT OF TRANSPORTATION  
DIVISION OF HIGHWAYS

**PROPOSED  
HIGHWAY PLANS**

F.A.I. ROUTE 72 (I-72)  
SECTION (74-68)MRS  
PIATT COUNTY

C-95-072-06  
MAINTENANCE RESURFACING  
AT BRIDGE STREET IN MONTICELLO

FOR INDEX OF SHEETS, SEE SHEET NO. 2  
FOR SUMMARY OF QUANTITIES, SEE SHEET NO. 4

D-95-072-06

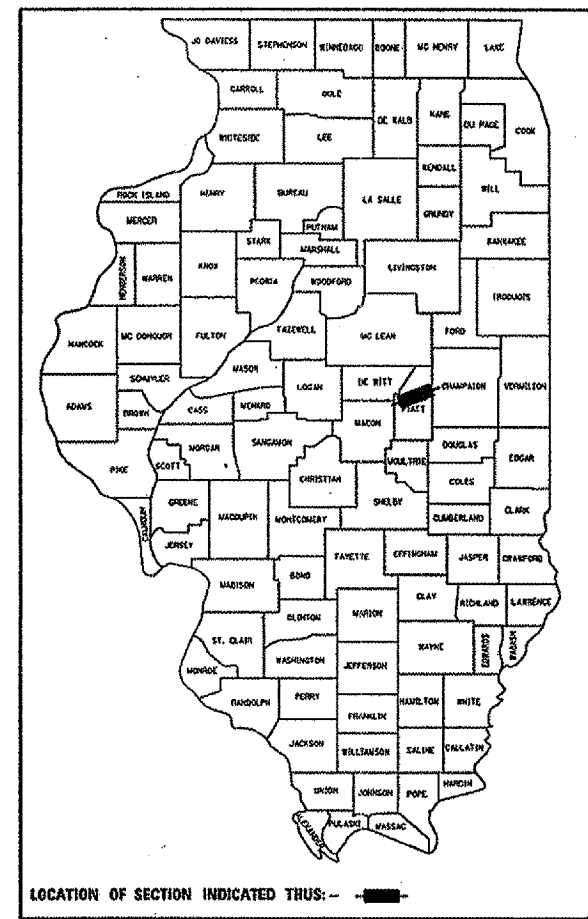

**CURRENT ADT:**

- F. A. I. 72 = 600 (RAMP A)
- 800 (RAMP B)
- 650 (RAMP C)
- 750 (RAMP D)
- 11,900 (1376+00 TO 1348+00)

BEGINNING STATION  
1376+00

OVERPASS STRUCTURE  
SN 074-0065  
BRIDGE STREET  
FAU 7531/FAP756  
STATION 1359+51.04

ENDING STATION  
1348+00

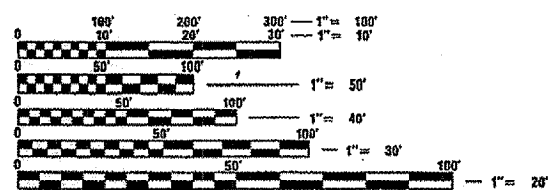
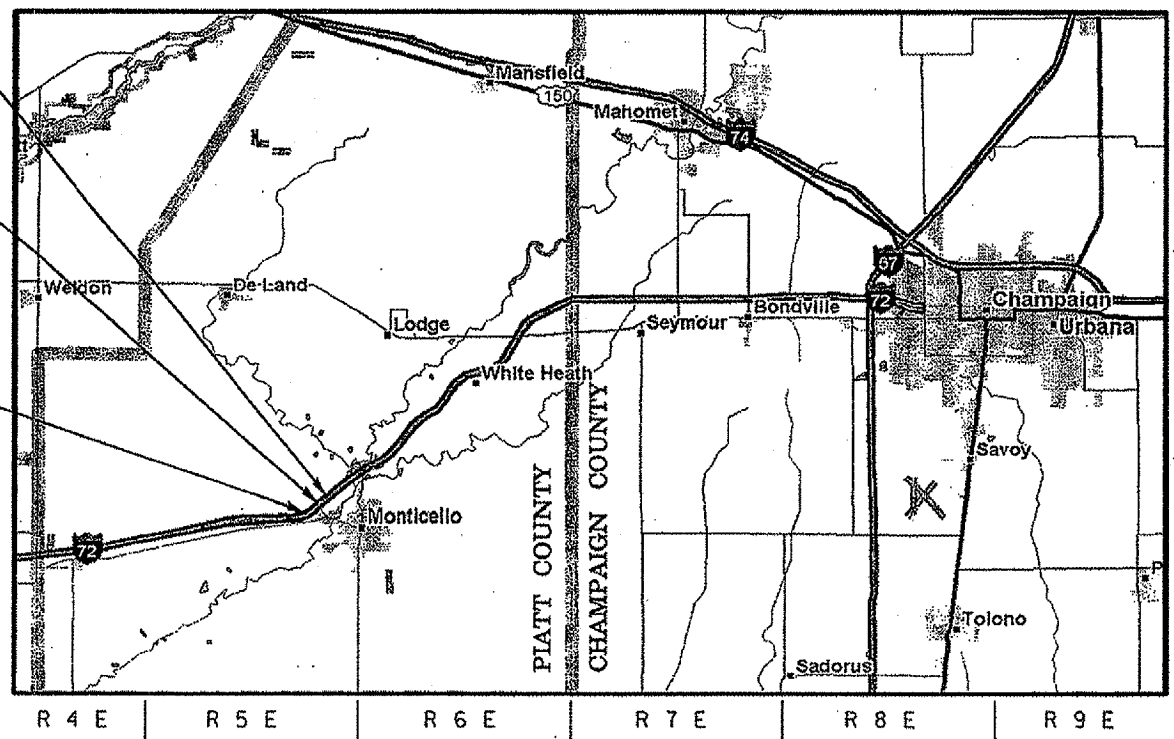

FULL SIZE PLANS HAVE BEEN PREPARED USING STANDARD ENGINEERING SCALES. REDUCED SIZED PLANS WILL NOT CONFORM TO STANDARD SCALES. IN MAKING MEASUREMENTS ON REDUCED PLANS, THE ABOVE SCALES MAY BE USED.

J.U.L.I.E.  
JOINT UTILITY LOCATION INFORMATION FOR EXCAVATION  
1-800-892-0123

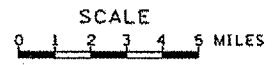

TOTAL LENGTH OF SECTION & PROJECT = 2,800 FEET = 0.530 MILES  
NET LENGTH OF SECTION & PROJECT = 2,800 FEET = 0.530 MILES

STATE OF ILLINOIS  
DEPARTMENT OF TRANSPORTATION  
DIVISION OF HIGHWAYS

SUBMITTED 5/18/2006

Joseph E. Anco  
DEPUTY DIRECTOR OF HIGHWAYS, REGION THREE ENGINEER

June 30, 2006  
Mike June  
ENGINEER OF DESIGN AND ENVIRONMENT

June 30, 2006  
Milton R. Sees, P.E.  
DIRECTOR OF HIGHWAYS, CHIEF ENGINEER

**PRINTED BY THE AUTHORITY  
OF THE STATE OF ILLINOIS**

CONTRACT NO. 70558

PROJECT ENGINEER: TIM BRANDENBURG (217)405-4181  
SQUAD LEADER: TODD BLACK



F.A.I. RTE.	SECTION	COUNTY	TOTAL SHEETS	SHEET NO.
72	(74-68)MRS	PIATT	10	3

## GENERAL NOTES

G. N. -100  
ENGLISH UNITS OF MEASUREMENT SHALL GOVERN OVER AND SUPERSEDE ANY METRIC UNITS SHOWN IN THIS CONTRACT. WHERE INCLUDED, METRIC UNITS ARE FOR INFORMATION ONLY.

G. N. -406  
THE QUANTITIES INCLUDED IN THE PLANS FOR BITUMINOUS CONCRETE RESURFACING ARE INTENDED TO GIVE THE COVERAGE SHOWN ON THE TYPICAL CROSS SECTIONS. IT IS NOT INTENDED TO INCREASE THE THICKNESS OF THE BITUMINOUS MIXTURE IN ORDER TO USE ALL OF THE QUANTITIES INCLUDED IN THE CONTRACT.

G. N. -406D  
ALL LEVELING BINDER OR BINDER SHALL BE GIVEN A FOG COAT OF PRIME BEFORE THE SURFACE COURSE IS PLACED WHEN DIRECTED BY THE ENGINEER.

THE FOG COAT WILL BE PAID FOR AT THE CONTRACT UNIT PRICE PER GALLON FOR BITUMINOUS MATERIAL (PRIME COAT) AND NO ADDITIONAL COMPENSATION WILL BE ALLOWED.

G. N. -406H  
MIXTURE REQUIREMENTS

The following mixture requirements are applicable for this project:

Location	I-72	I-72
Mixture Use	Polymer Binder	Polymer Surface
AC/PG	SBS PG 70-22	SBS PG 70-22
RAP % (Max)	0	0
Design Air Voids	4.0% @ Ndes=90	4.0% @ Ndes=90
Mixture Composition (Gradation Mixture)	IL 19.0	IL 9.5
Friction Aggregate	N. A.	Mix D

G. N. -442B -- PATCHING SCHEDULES  
THE PATCHING SCHEDULES INCLUDED IN THE PLANS REPRESENT THE BEST INFORMATION AVAILABLE AT THE TIME OF COMPLETION OF THE PLANS FOR LETTING. VARIATIONS IN LOCATION AND SIZES OF BOTH FULL-DEPTH AND PARTIAL-DEPTH PATCHES MAY OCCUR.

G. N. -703A  
SHORT TERM PAVEMENT MARKING SHALL BE APPLIED TO THE PAVEMENT AFTER ANY OF THE FOLLOWING: COLD MILLING AND/OR PLACING BITUMINOUS MATERIALS (PRIME COAT), LEVELING BINDER (MACHINE METHOD), BINDER AND SURFACE COURSES. SHORT TERM PAVEMENT MARKING PLACED ON THE SURFACE, SHALL COINCIDE WITH THE FINAL PAVEMENT STRIPING. SHORT TERM PAVEMENT MARKING PLACED PRIOR TO THE SURFACE SHALL COINCIDE WITH THE EXISTING PAVEMENT MARKINGS. USE 4 FEET PER 40 FEET (OR 10% PER STATION).

G. N. -781  
RAISED REFLECTIVE PAVEMENT MARKERS SHALL BE PLACED IN ACCORDANCE WITH STANDARD 781001, AND THE DETAILS SHOWN IN THE PLANS. IF THERE IS ANY DISCREPANCY BETWEEN THE STANDARD AND THE DETAILS IN THE PLANS, THE DETAILS IN THE PLANS SHALL GOVERN. THE FINAL PAVEMENT MARKINGS SHALL BE IN PLACE PRIOR TO PLACING THE RAISED REFLECTIVE PAVEMENT MARKERS AND THE RAISED REFLECTIVE PAVEMENT MARKERS SHALL BE PLACED MIDWAY IN THE 30 FOOT ( 9 m ) SPACE BETWEEN THE DASHED CENTERLINE STRIPES (WHEN APPLICABLE).

G. N. -1004.01  
COARSE AGGREGATE GRADATION CA-10 MAY BE USED WHENEVER COARSE AGGREGATE CA-6 IS SPECIFIED IN THE STANDARD SPECIFICATIONS.

G. N. -1004.03  
REVISE ARTICLE 1004.03 (c) NOTE 5/ OF THE STANDARD SPECIFICATIONS TO READ:

'5/ GRADATION CA-16 SHALL BE USED IN LIEU OF CA-13 WHEN THE SURFACE COURSE IS LESS THAN 1 3/4 INCHES IN THICKNESS. CA-13 OR CA-16 MAY BE USED WHEN THE SURFACE COURSE IS 1 3/4 INCHES OR MORE IN THICKNESS.'

PLOT DATE : 4/19/2006  
 FILE NAME : \\s111111\pub\70558\6170558.dgn  
 PLOT SCALE : 42.2529 / IN.  
 USER NAME : blackvt

ILLINOIS DEPARTMENT OF TRANSPORTATION	
<b>GENERAL NOTES</b>	
F.A.I. ROUTE 72	
SECTION (74-68)MRS	
PIATT COUNTY	
SCALE: NO SCALE	DRAWN BY: CADD
DATE: APRIL 21, 2006	CHECKED BY:

F.A.I. RTE.	SECTION	COUNTY	TOTAL SHEETS	SHEET NO.
72	(74-68)MRS	PIATT	10	4

# SUMMARY OF QUANTITIES

LOCATION OF WORK:

FAI -72  
Piatt County

Sta. 1348+00 to 1376+00

Rural-Multilane  
100% State  
1000  
TOTAL  
QUANTITY

CONSTRUCTION TYPE CODE:

CODE NO.	ITEM	UNIT	QUANTITY
40600100	BITUMINOUS MATERIALS (PRIME COAT)	GALLON	514.0
40600300	AGGREGATE (PRIME COAT)	TON	11.0
44200525	CLASS A PATCHES, TYPE I, 8 INCH	SQ YD	16.0
44200529	CLASS A PATCHES, TYPE II, 8 INCH	SQ YD	46.0
44200533	CLASS A PATCHES, TYPE III, 8 INCH	SQ YD	16.0
44200535	CLASS A PATCHES, TYPE IV, 8 INCH	SQ YD	27.0
44213000	PATCHING REINFORCEMENT	SQ YD	105.0
44213200	SAW CUTS	FOOT	606.0
67100100	MOBILIZATION	L SUM	1.0
70100420	TRAFFIC CONTROL AND PROTECTION, STANDARD 701411	EACH	2.0
70100800	TRAFFIC CONTROL AND PROTECTION, STANDARD 701401	L SUM	1.0
70103815	TRAFFIC CONTROL SURVEILLANCE	CAL DA	4.0
70300100	SHORT-TERM PAVEMENT MARKING	FOOT	112.0
70301000	WORK ZONE PAVEMENT MARKING REMOVAL	SQ FT	40.0
* 78000200	THERMOPLASTIC PAVEMENT MARKING - LINE 4"	FOOT	2,800.0
* 78100100	RAISED REFLECTIVE PAVEMENT MARKER	EACH	11.0
78300200	RAISED REFLECTIVE PAVEMENT MARKER REMOVAL	EACH	11.0
X4066528	POLYMERIZED BITUMINOUS CONCRETE SURFACE COURSE, SUPERPAVE, MIX "D", N90	TON	288.0
X4066658	POLYMERIZED BITUMINOUS CONCRETE BINDER COURSE, SUPERPAVE, IL-19.0, N90	TON	336.0
X4409420	BITUMINOUS SURFACE REMOVAL 3 1/4"	SQ YD	3,423.0
X7015005	CHANGEABLE MESSAGE SIGN	CAL DA	7.0
Z0075300	TIE BARS	EACH	20.0

\* SPECIALTY ITEMS

PLOT DATE : 5/19/2006  
 FILE NAME : c:\pcc\pcc\work\70558\sum.qdw  
 PLOT SCALE : 42.300' / IN.  
 USER NAME : blmclv1

ILLINOIS DEPARTMENT OF TRANSPORTATION  
**SUMMARY OF QUANTITIES**

F.A.I. ROUTE 72  
SECTION (74-68)MRS  
PIATT COUNTY

SCALE: NO SCALE  
DATE: APRIL 20, 2006

DRAWN BY: CADD  
CHECKED BY:

F.A.I. RTE.	SECTION	COUNTY	TOTAL SHEETS	SHEET NO.
72	(74-68)MRS	PIATT	10	5

## SCHEDULE OF CLASS A PATCH QUANTITIES

STATION	DIRECTION	LENGTH ( FT )	WIDTH ( FT )	TYPE 1 44200525 ( SQ. YD. )	TYPE 2 44200529 ( SQ. YD. )	TYPE 3 44200533 ( SQ. YD. )	TYPE 4 44200535 ( SQ. YD. )	SAW CUTS 44213200 ( FT )	TIE BARS Z0075300 ( EACH )	PATCH REINF 44213000 ( SQ. YD. )
1375+50	WBDL	10.0	12.0		13.30			68.00		13.30
1375+00	WBDL	6.0	6.0	4.00				36.00		4.00
1374+60	WBDL	10.0	6.0		6.70			44.00		6.70
1374+40	WBDL	6.0	12.0		8.00			60.00		8.00
1372+46	WBDL	6.0	6.0	4.00				36.00		4.00
1371+30	WBDL	12.0	12.0			16.00		72.00		16.00
1364+47	WBDL	6.0	12.0		8.00			60.00		8.00
1363+22	WBDL	40.0	6.0				26.70	104.00	20.00	26.70
1362+17	WBDL	15.0	6.0		10.00			54.00		10.00
1353+58	WBDL	6.0	6.0	4.00				36.00		4.00
1352+92	WBDL	6.0	6.0	4.00				36.00		4.00
PAGE TOTALS				16.0	46.0	16.0	26.7	606.0	20.0	104.7
CLASS A PAVEMENT PATCH - 8 INCH TOTALS				16.0	46.0	16.0	26.7	606.0	20.0	104.7
USE				16.0	46.0	16.0	27.0	606.0	20.0	105.0

**NOTES:**

CLASS A PATCHING WILL BE PERFORMED AFTER MILLING IS COMPLETED AND THE EXISTING BITUMINOUS OVERLAY IS REMOVED TO EXPOSE THE EXISTING CONCRETE PAVEMENT SURFACE. PATCH LOCATIONS AND DIMENSIONS WILL BE DETERMINED BY THE ENGINEER AFTER MILLING IS COMPLETED.

ANY ADDITIONAL QUANTITY OF BITUMINOUS MATERIAL REMOVED DURING CLASS A PATCH WORK WILL NOT BE MEASURED FOR PAYMENT AND SHALL BE INCLUDED IN THE CONTRACT UNIT PRICE FOR BITUMINOUS SURFACE REMOVAL - 3 1/4".

( CLASS A PATCHES LOCATED ADJACENT TO THE WESTBOUND TRAVELED WAY CENTERLINE WILL REQUIRE REMOVAL OF ADDITIONAL BITUMINOUS OVERLAY MATERIAL BEYOND THE 11 FOOT WIDE BITUMINOUS SURFACE REMOVAL - 3 1/4" PAY ITEM. )

ILLINOIS DEPARTMENT OF TRANSPORTATION  
**SCHEDULE OF QUANTITIES**  
 F.A.I. ROUTE 72  
 SECTION (74-68)MRS  
 PIATT COUNTY

SCALE: NO SCALE  
 DATE: APRIL 20, 2006  
 DRAWN BY: CADD  
 CHECKED BY:

F.A.I. RTE.	SECTION	COUNTY	TOTAL SHEETS	SHEET NO.
72	(74-68)MRS	PIATT	10	6

# EXISTING TYPICAL CROSS SECTION

F.A.I. 72

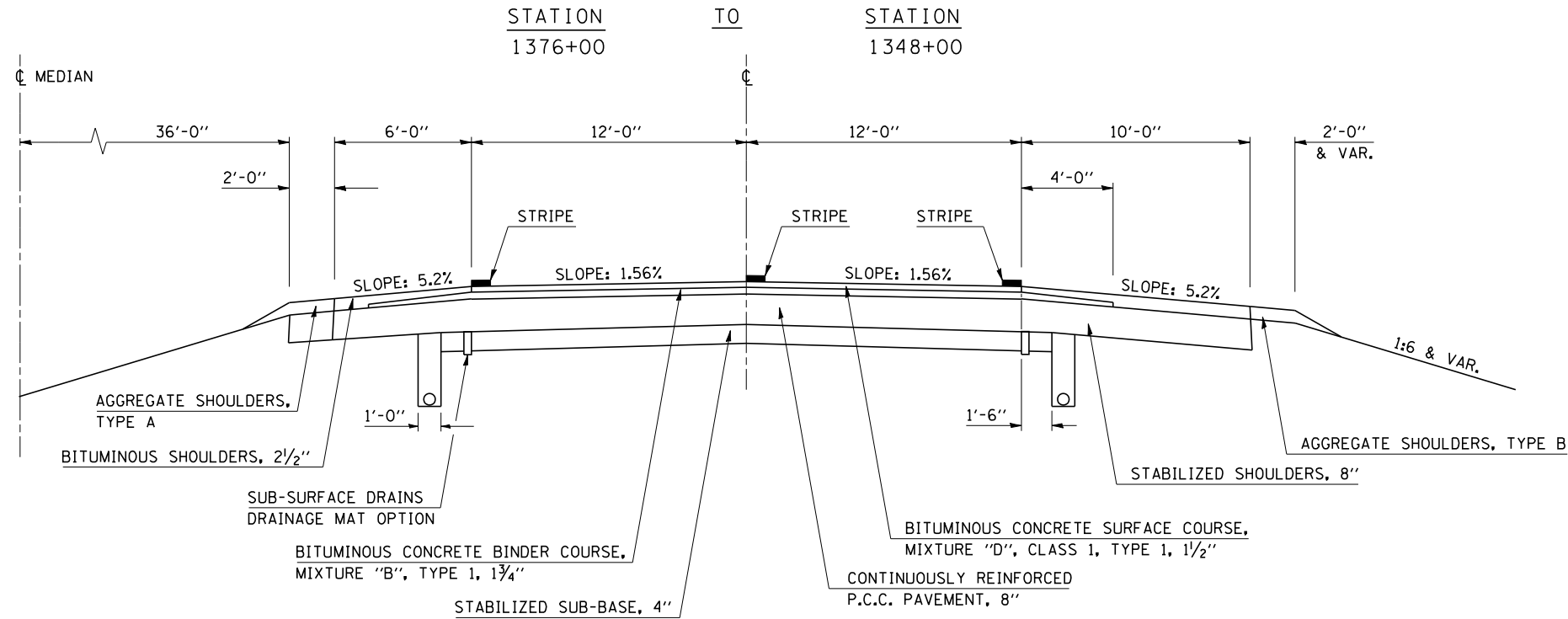

- NOTES:
1. TYPICAL WESTBOUND F.A.I. 72 SHOWN LOOKING WEST.
  2. PORTIONS OF THE WESTBOUND DRIVING LANE ARE ADJACENT TO INTERCHANGE RAMP.

# PROPOSED TYPICAL CROSS SECTION MAINTENANCE RESURFACING IN WESTBOUND DRIVING LANE ONLY

F.A.I. 72

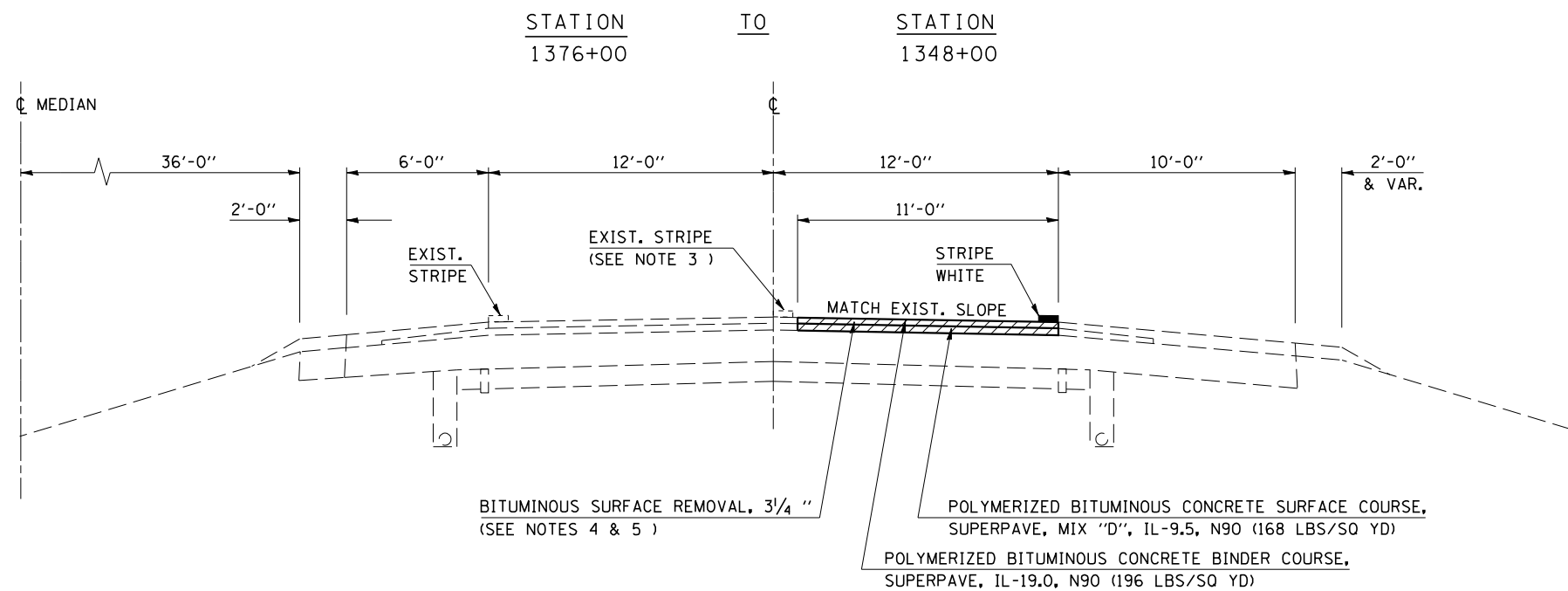

- NOTES:
1. TYPICAL WESTBOUND F.A.I. 72 SHOWN LOOKING WEST.
  2. PORTIONS OF THE WESTBOUND DRIVING LANE ARE ADJACENT TO INTERCHANGE RAMP.
  3. THE CONTRACTOR SHALL ENSURE WESTBOUND CENTERLINE PAVEMENT STRIPING AND RAISED REFLECTIVE MARKERS ARE NOT DAMAGED DURING CONSTRUCTION.
  4. THE EXISTING PAVEMENT SHALL BE COLD MILLED TO THE TOP OF THE EXISTING CONCRETE PAVEMENT. THE DEPTH SPECIFIED IS INTENDED TO ONLY REMOVE THE FULL THICKNESS OF THE EXISTING BITUMINOUS OVERLAY.
  5. ANY ADDITIONAL QUANTITY OF BITUMINOUS MATERIAL REMOVED DURING CLASS A PATCH WORK WILL NOT BE MEASURED FOR PAYMENT AND SHALL BE INCLUDED IN THE CONTRACT UNIT PRICE FOR BITUMINOUS SURFACE REMOVAL - 3 1/4".
- (CLASS A PATCHES LOCATED ADJACENT TO THE WESTBOUND TRAVELED WAY CENTERLINE WILL REQUIRE REMOVAL OF ADDITIONAL BITUMINOUS OVERLAY MATERIAL BEYOND THE 11 FOOT WIDE BITUMINOUS SURFACE REMOVAL - 3 1/4" PAY ITEM.)

PLOT DATE = 5/19/2006  
 FILE NAME = c:\projects\70558\70558.dgn  
 PLOT SCALE = 42.3525 / IN.  
 USER NAME = bleckr

ILLINOIS DEPARTMENT OF TRANSPORTATION  
**TYPICAL CROSS SECTIONS**  
 F.A.I. ROUTE 72  
 SECTION (74-68)MRS  
 PIATT COUNTY

SCALE: NO SCALE  
 DATE: APRIL 20, 2006

DRAWN BY: CADD  
 CHECKED BY:

F.A.I. RTE.	SECTION	COUNTY	TOTAL SHEETS	SHEET NO.
72	(74-68)MRS	PIATT	10	7
STA. 1320+00		TO STA. 1351+00		
FED. ROAD DIST. NO.	ILLINOIS	FED. AID PROJECT		

EXIST. CURVE 17 (FAI 72)  
 PI STA. = 1332+18.93  
 $\Delta = 37^\circ 15' 37''$  (LT)  
 $D = 1^\circ 30' 00''$   
 $R = 3,819.71'$   
 $T = 1,287.71'$   
 $L = 2,484.01'$   
 $E = 211.22'$   
 $e = \text{-----}$   
 $T.R. = \text{-----}$   
 $S.E. \text{ RUN} = \text{-----}$   
 $P.C. \text{ STA.} = 1319+31.22$   
 $P.T. \text{ STA.} = 1344+15.23$

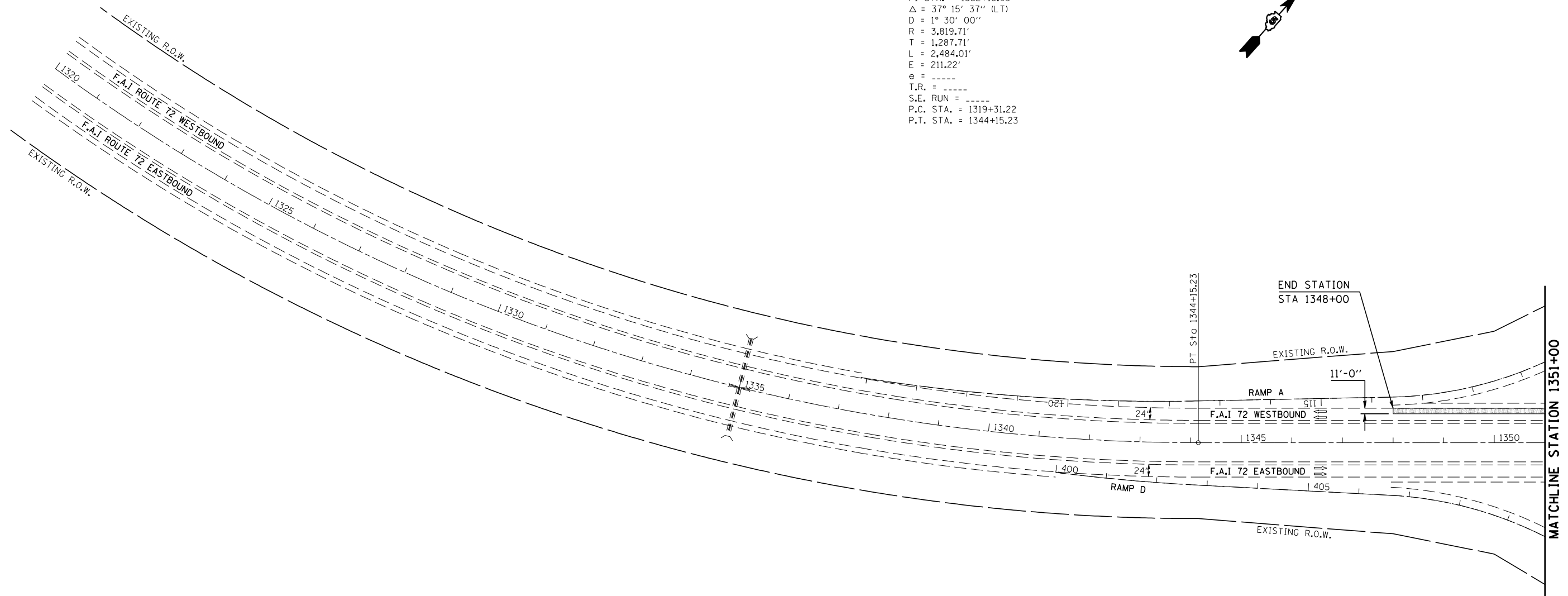
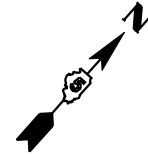

LEGEND	
	BITUMINOUS SURFACE REMOVAL 3 1/4"

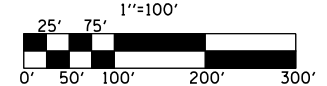

REVISIONS	
NAME	DATE

ILLINOIS DEPARTMENT OF TRANSPORTATION  
**PLAN VIEW**  
 F.A.I. ROUTE 72  
 SECTION (74-68)MRS  
 PIATT COUNTY  
 SCALE: 1" = 100'  
 DATE: 05/01/06  
 DRAWN BY: CADD  
 CHECKED BY:

PLOT DATE = 5/19/2006  
 FILE NAME = c:\projects\view\507206\8\70558sheets.dgn  
 PLOT SCALE = 211.7647 / IN.  
 USER NAME = blackrt

F.A.I. RTE.	SECTION	COUNTY	TOTAL SHEETS	SHEET NO.
72	(74-68)MRS	PIATT	10	8
STA. 1351+00		TO STA. 1381+00		
FED. ROAD DIST. NO.	ILLINOIS	FED. AID PROJECT		

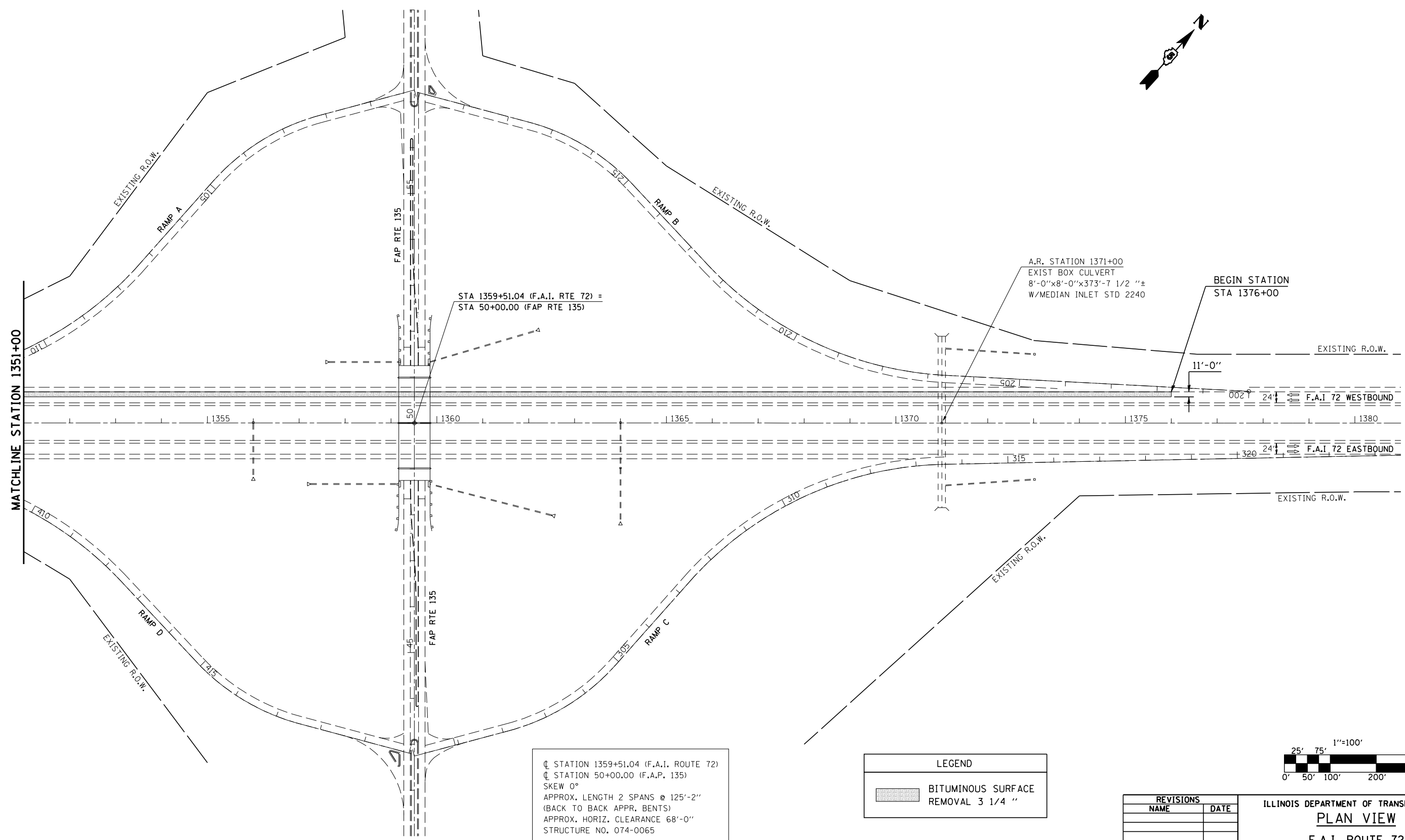
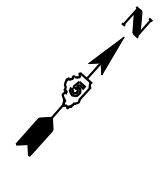

STA 1359+51.04 (F.A.I. RTE 72) =  
STA 50+00.00 (FAP RTE 135)

A.R. STATION 1371+00  
EXIST BOX CULVERT  
8'-0"x8'-0"x373'-7 1/2" ±  
W/MEDIAN INLET STD 2240

BEGIN STATION  
STA 1376+00

◊ STATION 1359+51.04 (F.A.I. ROUTE 72)  
 ◊ STATION 50+00.00 (F.A.P. 135)  
 SKEW 0°  
 APPROX. LENGTH 2 SPANS @ 125'-2"  
 (BACK TO BACK APPR. BENTS)  
 APPROX. HORIZ. CLEARANCE 68'-0"  
 STRUCTURE NO. 074-0065

LEGEND	
	BITUMINOUS SURFACE REMOVAL 3 1/4 "

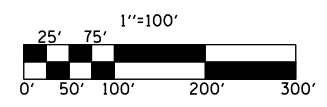

REVISIONS	
NAME	DATE

ILLINOIS DEPARTMENT OF TRANSPORTATION  
**PLAN VIEW**  
 F.A.I. ROUTE 72  
 SECTION (74-68)MRS  
 PIATT COUNTY  
 SCALE: 1" = 100'  
 DATE: 05/01/06  
 DRAWN BY: CADD  
 CHECKED BY:

PLOT DATE = 5/19/2006  
 FILE NAME = c:\projects\view\507206(v8)\70558sheets.dgn  
 PLOT SCALE = 211.7647 / IN.  
 USER NAME = blackrt



## TYPICAL APPLICATION OF PAVEMENT MARKINGS FOR INTERSTATE AND MULTI-LANE DIVIDED HIGHWAYS

### TYPICAL ENTRANCE RAMP TERMINAL

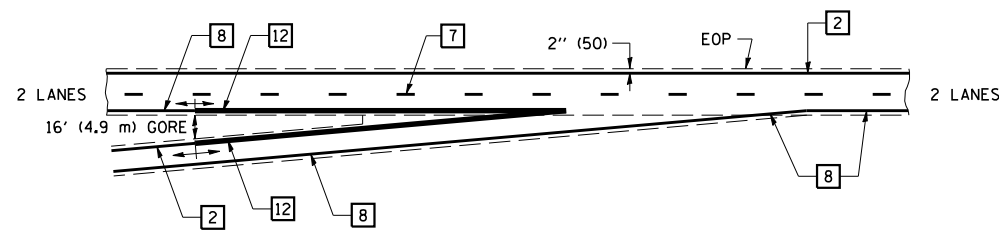

### TYPICAL EXIT RAMP TERMINAL

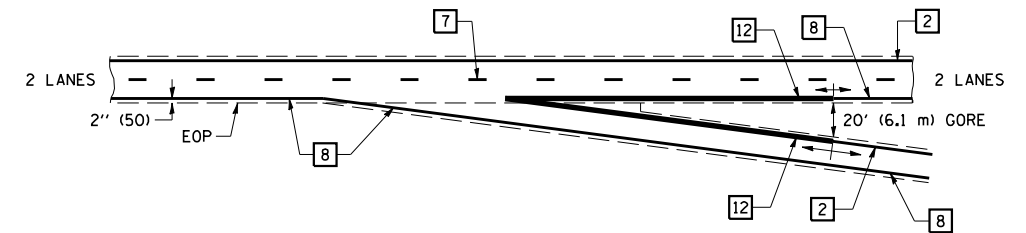

### CENTERLINE INTERSTATE OR MULTI-LANE TWO WAY DIVIDED HIGHWAY

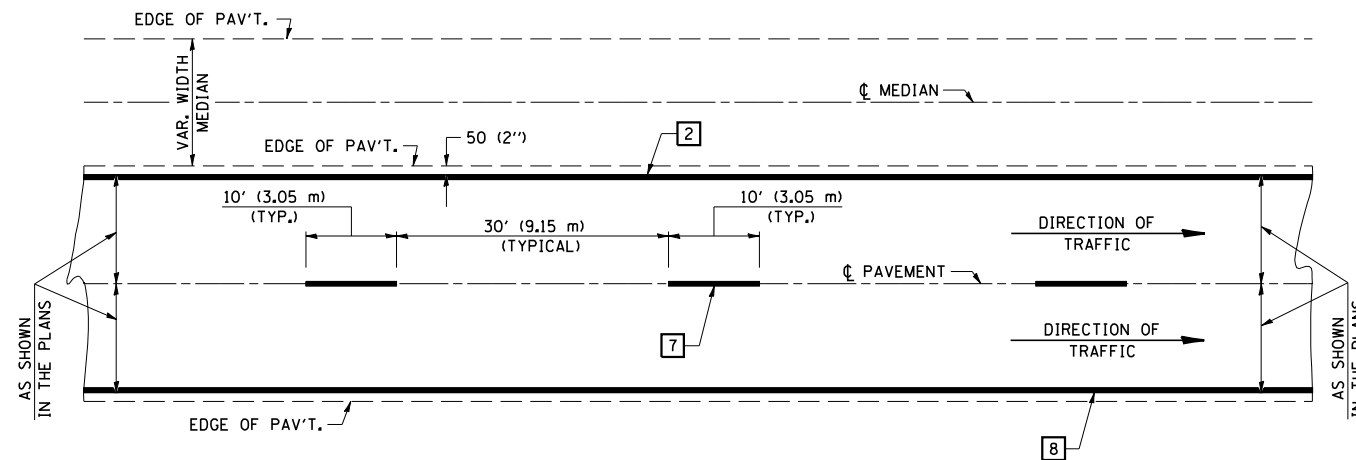

NOTE: PAVEMENT MARKINGS ARE TO BE EXTENDED THROUGH OMISSIONS WHEN APPLICABLE.

NOTE: SEE ARTICLES 780.04 & 781.03 FOR LOCATION OF STRIPES AND MARKERS RELATIVE TO EDGES OR JOINTS.

FOR RAISED REFLECTIVE PAVEMENT MARKERS, REFER TO STANDARD 781001.

### TYPICAL PAVEMENT MARKING LEGEND

- |    |                                       |  |
|----|---------------------------------------|--|
| 1  | 4" (100) SKIP-DASH (YELLOW)           |  |
| 2  | 4" (100) SOLID (YELLOW)               |  |
| 3  | 12" (300) DIAGONAL (YELLOW)           |  |
| 4  | 4" (100) DOUBLE YELLOW (NARROW)       |  |
| 5  | 4" (100) DOUBLE YELLOW (WIDE)         |  |
| 6  | RESERVED                              |  |
| 7  | 4" (100) SKIP-DASH (WHITE)            |  |
| 8  | 4" (100) SOLID (WHITE)                |  |
| 9  | 12" (300) DIAGONAL (WHITE)            |  |
| 10 | 6" (150) CROSS WALK (WHITE)           |  |
| 11 | 24" (600) STOP BAR (WHITE)            |  |
| 12 | 8" (200) SOLID (WHITE)                |  |
| 13 | 4" (100) LANE LINE EXTENSIONS (WHITE) |  |
| 14 | RESERVED                              |  |

### ENTRANCE RAMP TERMINAL with EXCLUSIVE LANE

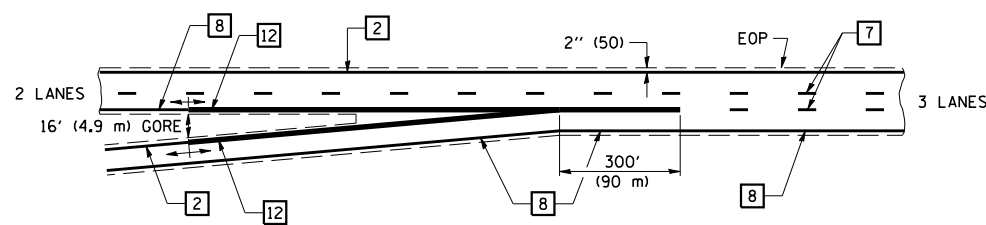

### EXIT RAMP TERMINAL with EXCLUSIVE (auxiliary) LANE

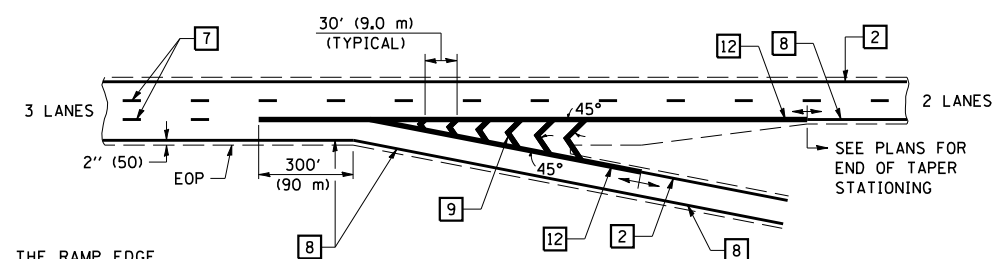

WHEN RAMPS ARE SURFACED, THE RAMP EDGE LINES SHALL BE AS SHOWN IN THE PLANS.

PLOT DATE = 5/19/2006  
 FILE NAME = c:\projects\mrs\70558\81\70558.dgn  
 PLOT SCALE = 42.3525 / IN.  
 USER NAME = bleckr

	NAME	DATE	REVISIONS	NAME	DATE
DESIGNED	P.E.E.	03/89			
CHECKED	C.T.D.	04/89		D.L.P.	08/97
CADD NO.	F-5.22			K.A.G.	08/04

ALL DIMENSIONS ARE IN INCHES (MILLIMETERS) UNLESS OTHERWISE SHOWN.

F.A.I. RTE.	SECTION	COUNTY	TOTAL SHEETS	SHEET NO.
72	(74-68)MRS	PIATT	10	10

## TRAFFIC CONTROL FOR INLAYS

DRIVING LANE INLAYS WITHIN STD. 701401 SET-UP

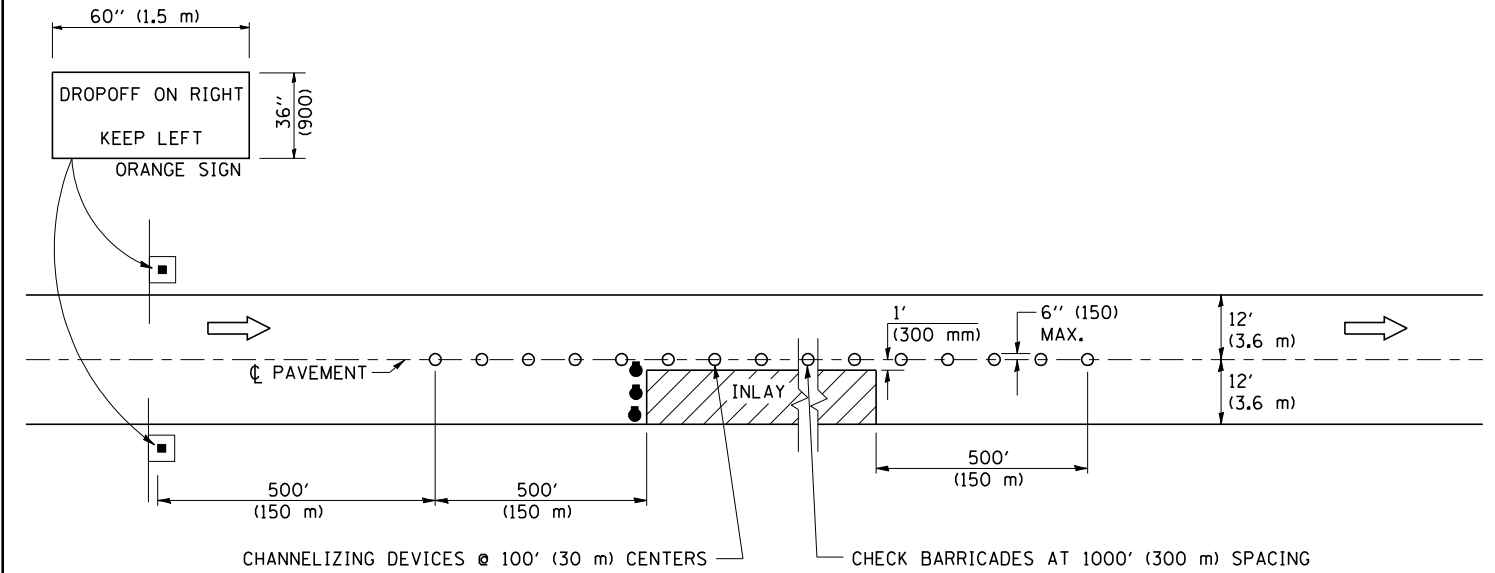

**NOTES:**

TRAFFIC CONTROL DETAILS NOT SHOWN SHALL BE ACCORDING TO TRAFFIC CONTROL STANDARD 701401.

AT RAMP, THE INLAY WORK AREA SHALL BE STAGED TO COORDINATE WITH STANDARD 701411. TEMPORARY RAMP THROUGH THE INLAY AREA TO MAINTAIN RAMP TRAFFIC IN LIEU OF STAGING WILL NOT BE ALLOWED.

THE DETAILS SHOWN ON THIS SHEET ARE TO SUPPLEMENT TRAFFIC CONTROL AND PROTECTION 701401. THESE ITEMS WILL NOT BE PAID FOR SEPARATELY BUT SHALL BE CONSIDERED AS INCLUDED IN THE CONTRACT UNIT PRICE PER LUMP SUM FOR TRAFFIC CONTROL AND PROTECTION 701401.

**SYMBOLS**

- DIRECTION OF TRAVEL
- DRUMS WITH FLASHING LIGHTS
- 42" (1.07 m) HIGH INTENSITY REFLECTORIZED CONE, DRUMS OR VERTICAL BARRICADES

ALL DIMENSIONS ARE IN INCHES (MILLIMETERS) UNLESS OTHERWISE SHOWN.