

FOR INDEX OF SHEETS AND HIGHWAY
STANDARDS, SEE SHEET 2.

STATE OF ILLINOIS
DEPARTMENT OF TRANSPORTATION
DIVISION OF HIGHWAYS

**PLANS FOR PROPOSED
CONTRACT MAINTENANCE
FAP ROUTE 317 (US 24)
SECTION 5(RS-5,I)
ADAMS/BROWN COUNTY
C96-008-07 / D96-022-06**

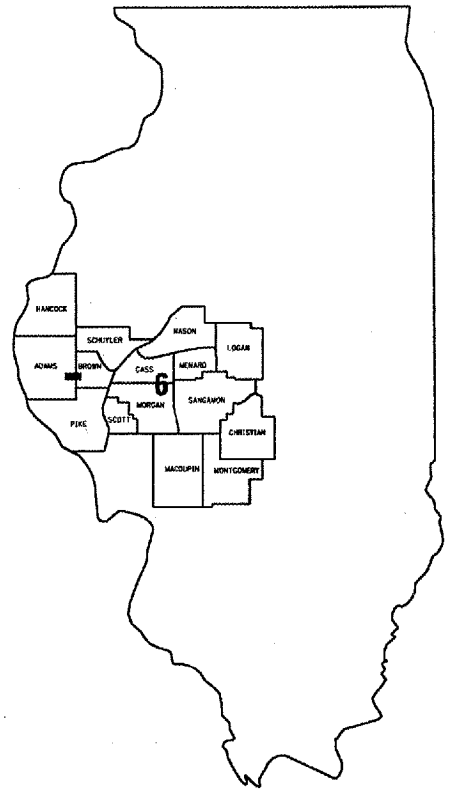

LOCATION OF SECTION INDICATED THUS: ■

BEGIN PROJECT
STA. 140+53

END PROJECT
STA. 214+55

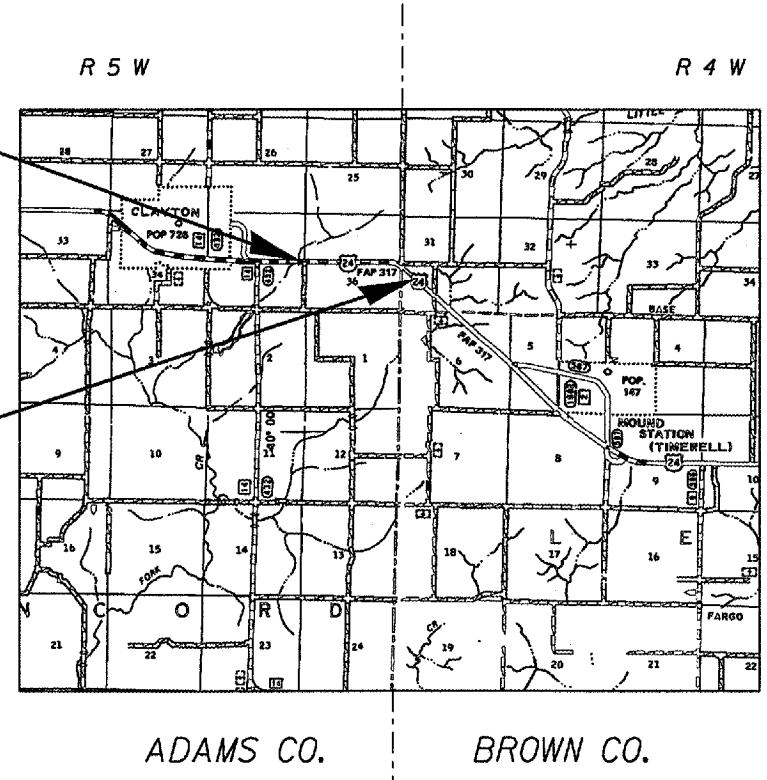

J. U. L. I. E.
JOINT UTILITY LOCATION INFORMATION FOR EXCAVATION
1-800-892-0123

PLANS & CONTRACT TECHNICIAN: TIMOTHY SHARP
PHONE: (217) 782-7743

NET LENGTH OF SECTION - 7,402 FT = 1.402 MILES

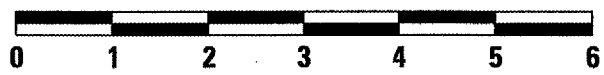

SCALE: 1" = 2 MILES

STATE OF ILLINOIS
DEPARTMENT OF TRANSPORTATION
DIVISION OF HIGHWAYS

SUBMITTED May 18 2006
Christ H Reed
DEPUTY DIRECTOR OF HIGHWAYS, REGION FOUR ENGINEER

June 30 2006
Mike Hine
ENGINEER OF DESIGN AND ENVIRONMENT

June 30 2006
Milton L. Sees, P.E.
DIRECTOR, DIVISION OF HIGHWAYS

CONTRACT NO. 72A50

INDEX

- 1 COVER
- 2 INDEX / STDS / SIGNATURES
- 3-4 QUANTITIES
- 5 TYPICAL SECTIONS
- 6 SCHEDULES
- 7 BUTT JOINT DETAILS
- 8 ENTRANCE AND SIDEROAD DETAILS
- 9 CULVERT DETAILS

STANDARDS

- 406201
- 630301-03
- 701001-01
- 701006-02
- 701011-01
- 701201-02
- 701306-01
- 701311-02
- 702001-05
- 780001-01

STATE OF ILLINOIS DEPARTMENT OF TRANSPORTATION DIVISION OF HIGHWAYS DISTRICT 6	
EXAMINED <u>May 18</u>	20 <u>06</u>
<u>Louis J. Harris</u> ENGINEER OF OPERATIONS	
EXAMINED <u>May 3</u>	20 <u>06</u>
<u>W. R. Jung</u> ENGINEER OF PROGRAM IMPLEMENTATION	
EXAMINED <u>May 11</u>	20 <u>06</u>
<u>William E. Mente</u> ENGINEER OF PROGRAM DEVELOPMENT	

INDEX / STDS / SIGNATURES
FAP 317 (US 24)
SECTION 5(RS-5,I)
ADAMS/BROWN COUNTY

S U M M A R Y O F Q U A N T I T I E S

CODE NO.	ITEM	UNIT	100% STATE		
			1000		
			ADAMS	BROWN	TOTAL QTY
31101100	SUB-BASE GRANULAR MATERIAL, TYPE B	CU YD	8.9		8.9
35800100	PREPARATION OF BASE	SQ YD	270.3	66.7	337
40600200	BITUMINOUS MATERALS (PRIME COAT)	TON	6.2	1.7	7.9
40600300	AGGREGATE (PRIME COAT)	TON	32.3	8.8	41.1
40600895	CONSTRUCTING TEST STRIP	EACH	0.8	0.2	1
40600980	BITUMINOUS SURFACE REMOVAL (BUTT JOINT)	SQ YD	193.5	150	343.5
40600990	TEMPORARY RAMP	SQ YD	13.9	13.9	27.8
40800020	BITUMINOUS MATERIALS (PRIME COAT)	TON	0.23	0.03	0.26
40800030	AGGREGATE (PRIME COAT)	TON	0.53	0.13	0.66
40800040	INCIDENTAL BITUMINOUS SURFACE	TON	32.7	5.6	38.3
44200144	PAVEMENT PATCHING, TYPE II, 12 INCH	SQ YD	250		250
44200148	PAVEMENT PATCHING, TYPE III, 12 INCH	SQ YD	150		150
44200150	PAVEMENT PATCHING, TYPE IV, 12 INCH	SQ YD	125		125
48101200	AGGREGATE SHOULDERS, TYPE B	TON	331.5	90	421.5
50100100	REMOVAL OF EXISTING STRUCTURES	EACH	1		1

QUANTITIES
FAP 317 (US 24)
SECTION 5(RS-5.1)
ADAMS/BROWN COUNTY

S U M M A R Y O F Q U A N T I T I E S

CODE NO.	ITEM	UNIT	100% STATE		
			I 0 0 0		
			ADAMS	BROWN	TOTAL QTY
54010402	PRECAST CONCRETE BOX CULVERT 4' x 2'	FOOT	46		46
67100100	MOBILIZATION	L SUM	0.8	0.2	1
70100450	TRAFFIC CONTROL AND PROTECTION, STANDARD 701201	L SUM	0.8	0.2	1
70100460	TRAFFIC CONTROL AND PROTECTION, STANDARD 701306	L SUM	0.8	0.2	1
70300100	SHORT-TERM PAVEMENT MARKING	FOOT	1,164	316	1,480
70300230	TEMPORARY PAINT PAVEMENT MARKING - LINE 5"	FOOT	15,329.3	3,485	18,814.3
70301000	WORK ZONE PAVEMENT MARKING REMOVAL	SQ FT	193.8	52.6	246.4
78001120	PAINT PAVEMENT MARKING - LINE 5"	FOOT	15,329.3	3,485	18,814.3
78100100	RAISED REFLECTIVE PAVEMENT MARKER	EACH	73	20	93
78300200	RAISED REFLECTIVE PAVEMENT MARKER REMOVAL	EACH	73	20	93
X0324118	GRANULAR CULVERT BACKFILL	CU YD	21.6		21.6
X0914300	PRECAST CONCRETE BOX CULVERT END SECTION 4' x 2'	EACH	2		2
X4066414	BITUMINOUS CONCRETE SURFACE COURSE, SUPERPAVE, MIX C, N50	TON	1,358.5	368.7	1,727.2
X4066765	LEVELING BINDER, SUPERPAVE N50	TON	678.5	183.5	862

QUANTITIES
FAP 317 (US 24)
SECTION 5(RS-5.1)
ADAMS/BROWN COUNTY

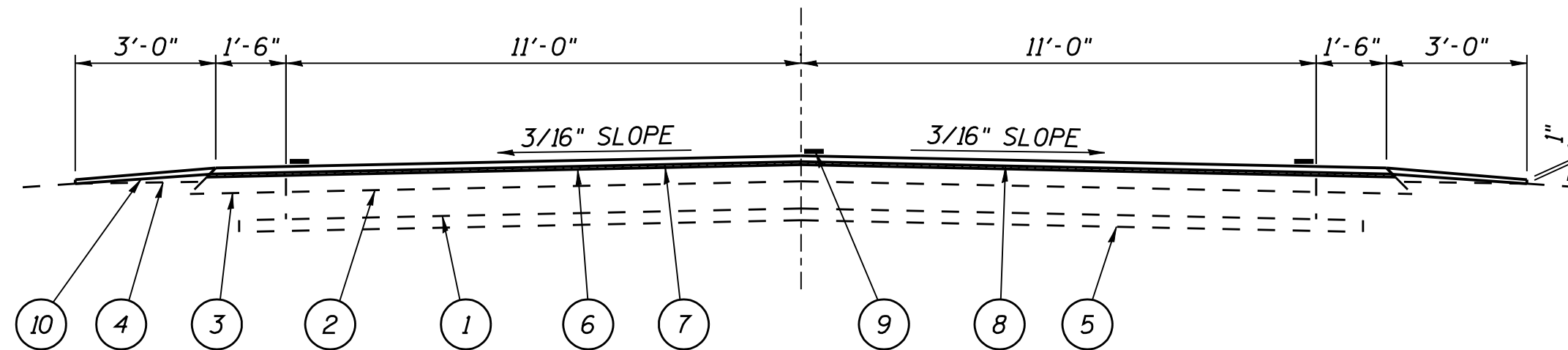

LEGEND

- 1 EXIST. P.C.C. PAVEMENT 7"
- 2 EXIST. BITUMINOUS SURFACE 5"
- 3 EXIST. BITUMINOUS SHOULDERS
- 4 EXIST. AGGREGATE SHOULDERS, TYPE B
- 5 EXIST. SUB BASE GRANULAR MATERIAL 4"
- 6 PROP. BITUMINOUS SURFACE REMOVAL (VARIABLE DEPTH), 3/4" AT CENTER LINE
- 7 PROP. LEVELING BINDER, SUPERPAVE N50, 3/4"
- 8 PROP. BITUMINOUS SURFACE COURSE, SUPERPAVE, MIX C, N50, 1 1/2"
- 9 PROP. PAVEMENT MARKING - LINE 5"
- 10 PROP. AGGREGATE SHOULDERS, TYPE B

QUANTITIES
FAP 317 (US 24)
SECTION 5(RS-5.1)
ADAMS/BROWN COUNTY

ENTRANCE & SIDEROAD SCHEDULE			
STATION	TYPE	INC BIT SURFACING	SECTION
RT 144+71	BITUMINOUS SIDEROAD	3.7 TON	B-B
LT 149+15	BIT. P.E.	3.1 TON	B-B
RT 149+35	AGG. M.B.T.O.	6.9 TON	C-C
LT 154+85	AGG. P.E.	6.3 TON	A-A
RT 154+85	AGG. M.B.T.O.	6.9 TON	C-C
RT 186+03	BIT. M.B.T.O.	3.4 TON	D-D
LT 186+25	BIT. P.E.	2.4 TON	A-A
LT 199+40	BITUMINOUS SIDEROAD	5.6 TON	B-B

PAVEMENT MARKING SCHEDULE			
STATION	TYPE	PAINT PVT MK LINE 5"	
		WHITE	YELLOW
LT & RT 140+53 TO 214+55	EDGE LINE	14,804 FT	
LT & 140+53 TO 147+90	NO PASS		1,474 FT
LT 147+90 TO 157+80	NO PASS		990 FT
RT 147+90 TO 157+80	SKIP DASH		247.5 FT
157+80 TO 214+55	SKIP DASH		1,418.8 FT
DEDUCT FOR SIDEROADS		(120 FT)	
TOTALS		14,684 FT	4,130.3 FT

BOX CULVERT REMOVAL AND REPLACEMENT			
STATION	REM. OF EXIST. STRUCTURES	PRECAST BOX CULVERT 4' x 2'	PRECAST BOX CULVERT END SECTION
STA. 163+15	1 EACH	46 FOOT	2 EACH

NOTES:

ENTRANCES AND SIDEROADS SHALL BE CONSTRUCTED ACCORDING TO THE SECTION INDICATED AS SHOWN ON SHEET 8.

MAILBOX TURNOUTS SHALL BE CONSTRUCTED ACCORDING TO HIGHWAY STANDARD 406201, SECTION 406 OF THE STANDARD SPECIFICATIONS AND THE SECTION INDICATED ON SHEET 8.

STATIONS ARE APPROXIMATE.

MIXTURE REQUIREMENTS			
THE FOLLOWING MIXTURE REQUIREMENTS ARE APPLICABLE FOR THIS PROJECT			
MIXTURE USE(S):	B.C. S.C., SUPER, MIX C, N50	LEV. BIND. (M.M), SUPER, N50	INC. BIT. SURF.
AC/PG	PG 64-22	PG 64-22	PG 64-22
RAP %: (MAX)	15%	20%	15%
DESIGN AIR VOIDS:	4.0% @ N DESIGN = 50	4.0% @ N DESIGN = 50	4.0% @ N DESIGN = 50
MIXTURE COMP:	IL 9.5 OR 12.5	IL 9.5	IL 9.5 OR 12.5
FRICTION AGG:	MIX "C"	N/A	MIX "C"

SCHEDULES
FAP 317 (US 24)
SECTION 5(RS-5.1)
ADAMS/BROWN COUNTY

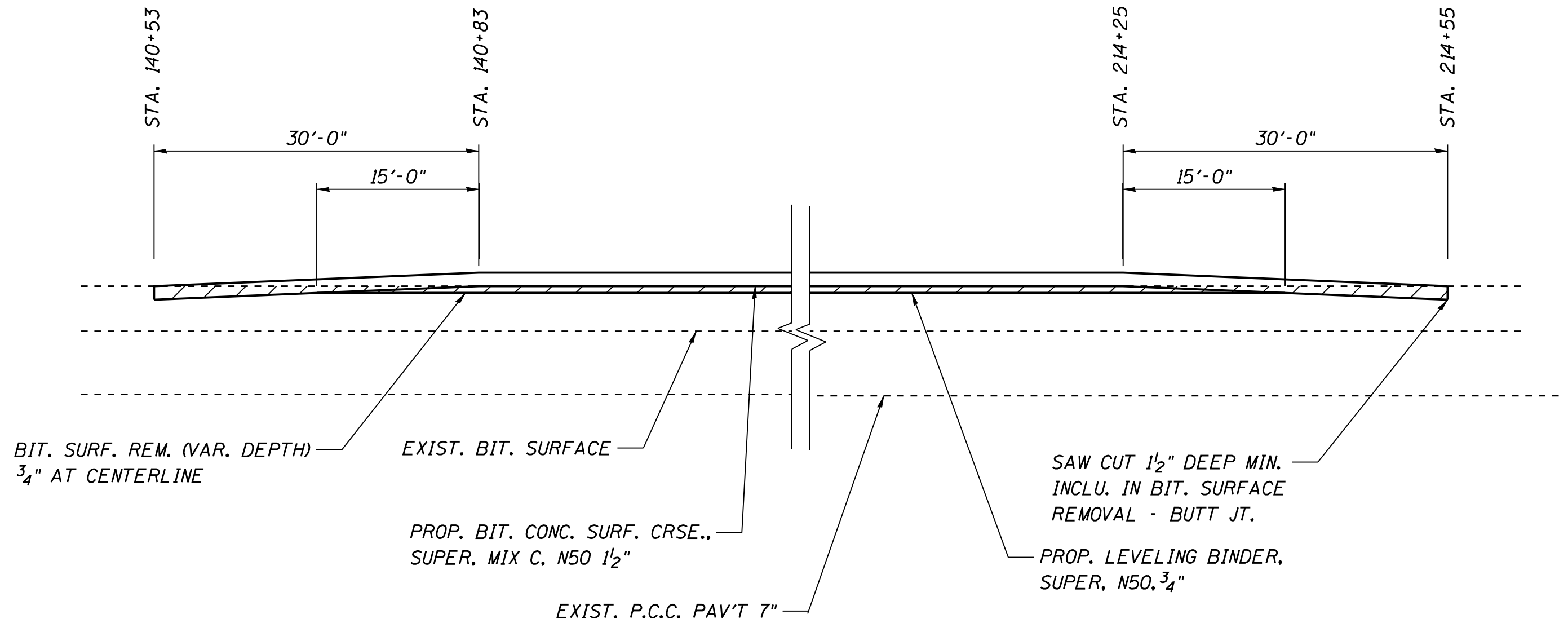

BUTT JOINT DETAIL
FAP 317 (US 24)
SECTION 5(RS5,1)
ADAMS/BROWN COUNTY

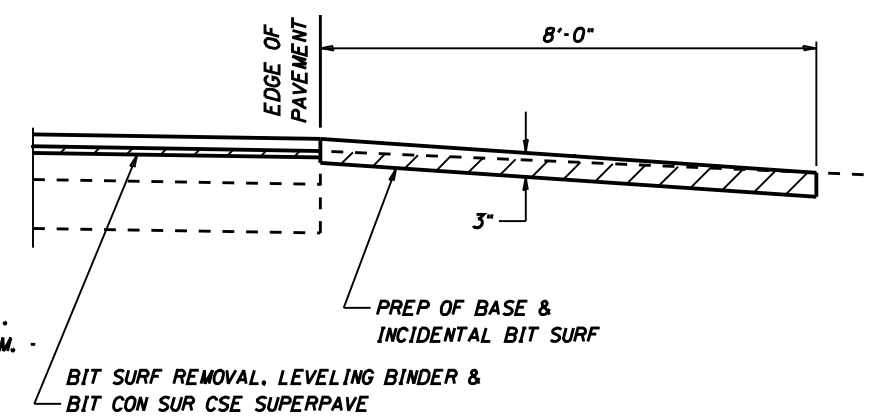
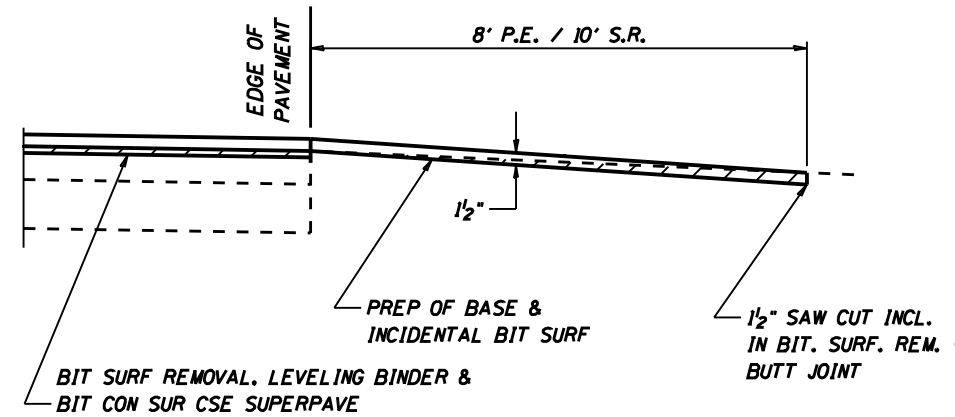
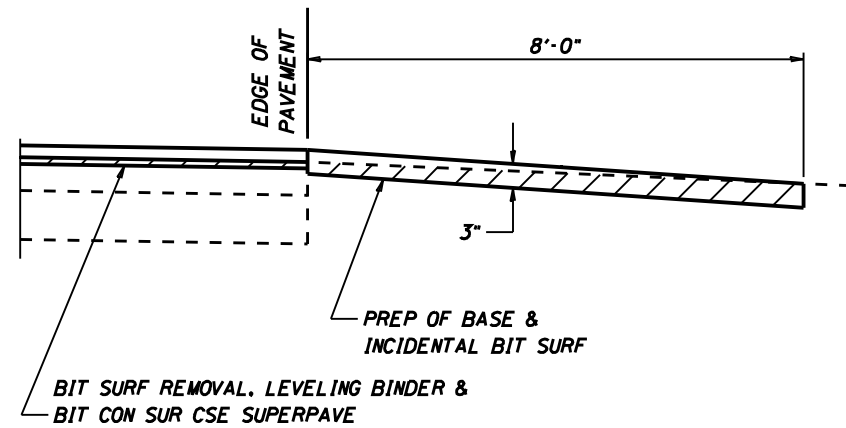
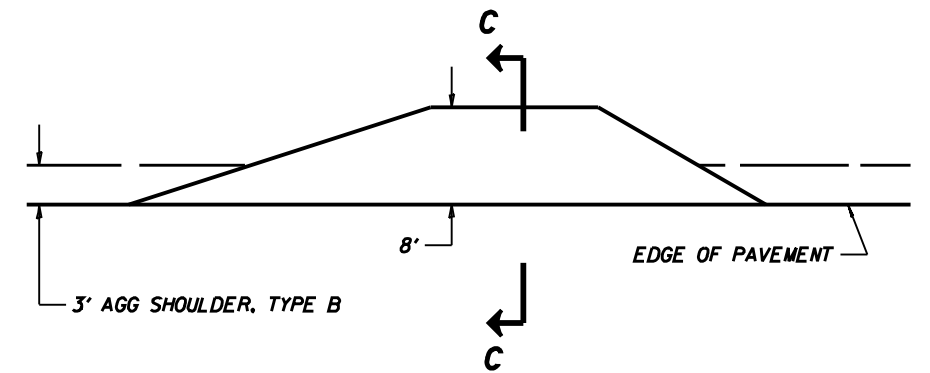
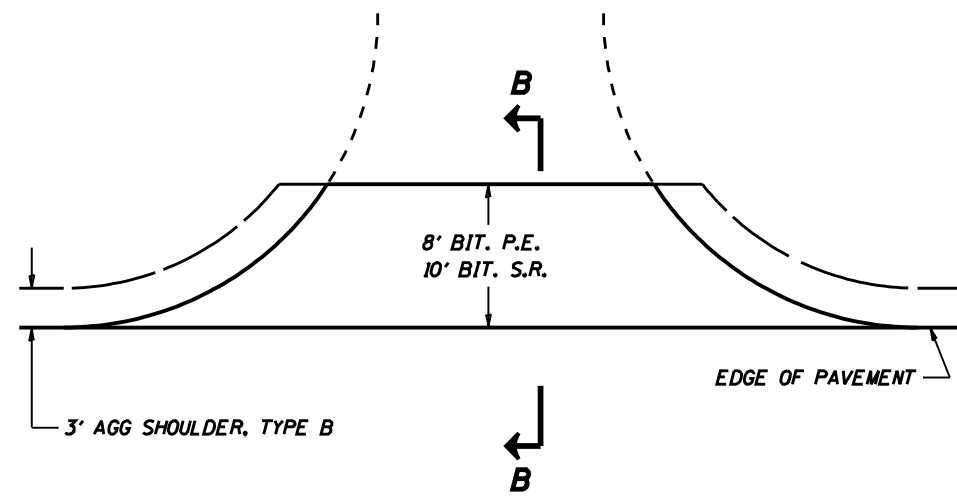
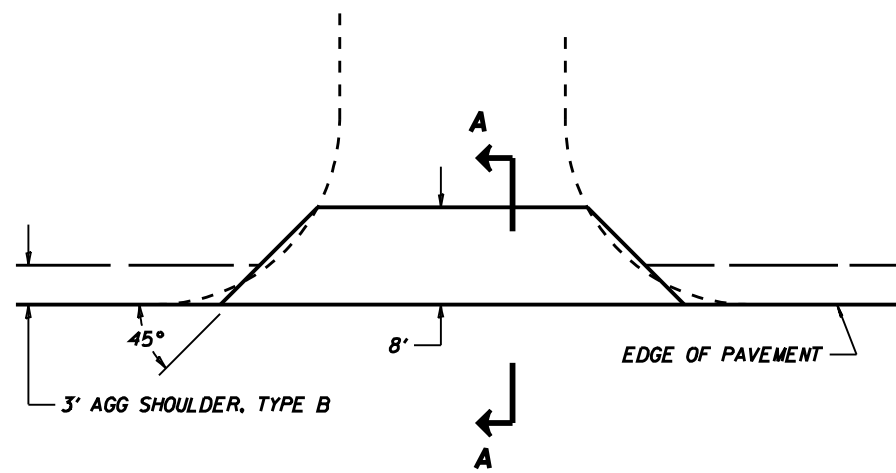

SECTION A-A FOR AGGREGATE P.E.

SECTION B-B FOR BIT. P.E. & SIDEROAD

SECTION C-C FOR AGG. MAILBOX TURNOUT

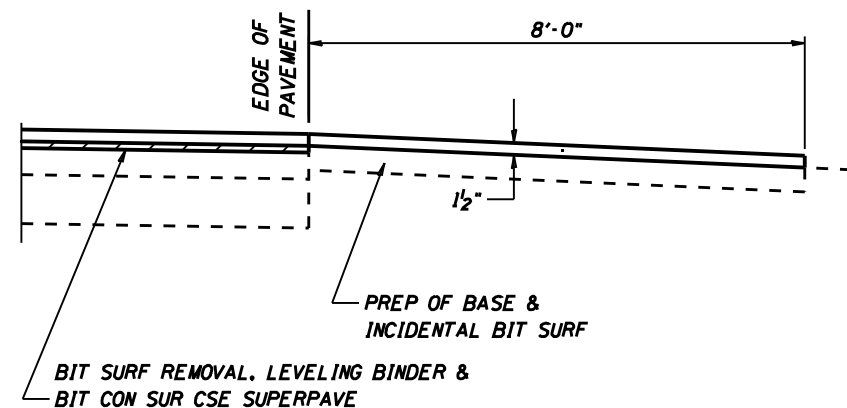
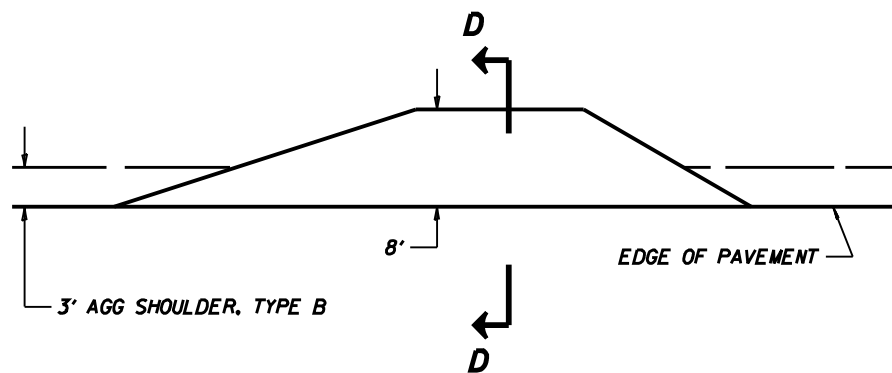

SECTION D-D FOR BIT. MAILBOX TURNOUT

ENTRANCE AND S.R. DETAILS
FAP 317 (US 24)
SECTION 5(RS-5.1)
ADAMS/BROWN COUNTY

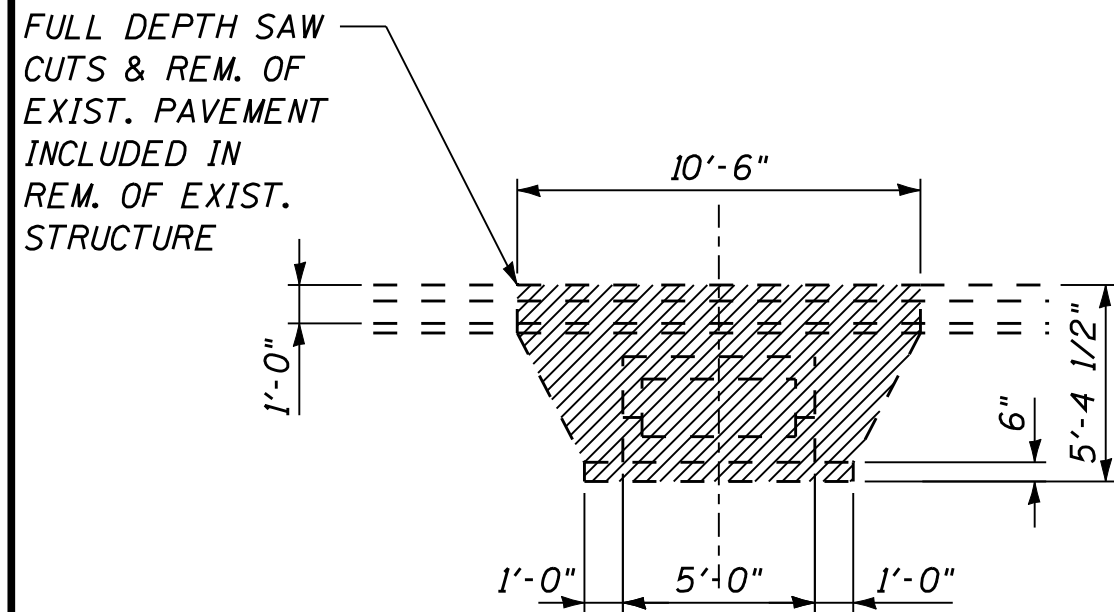
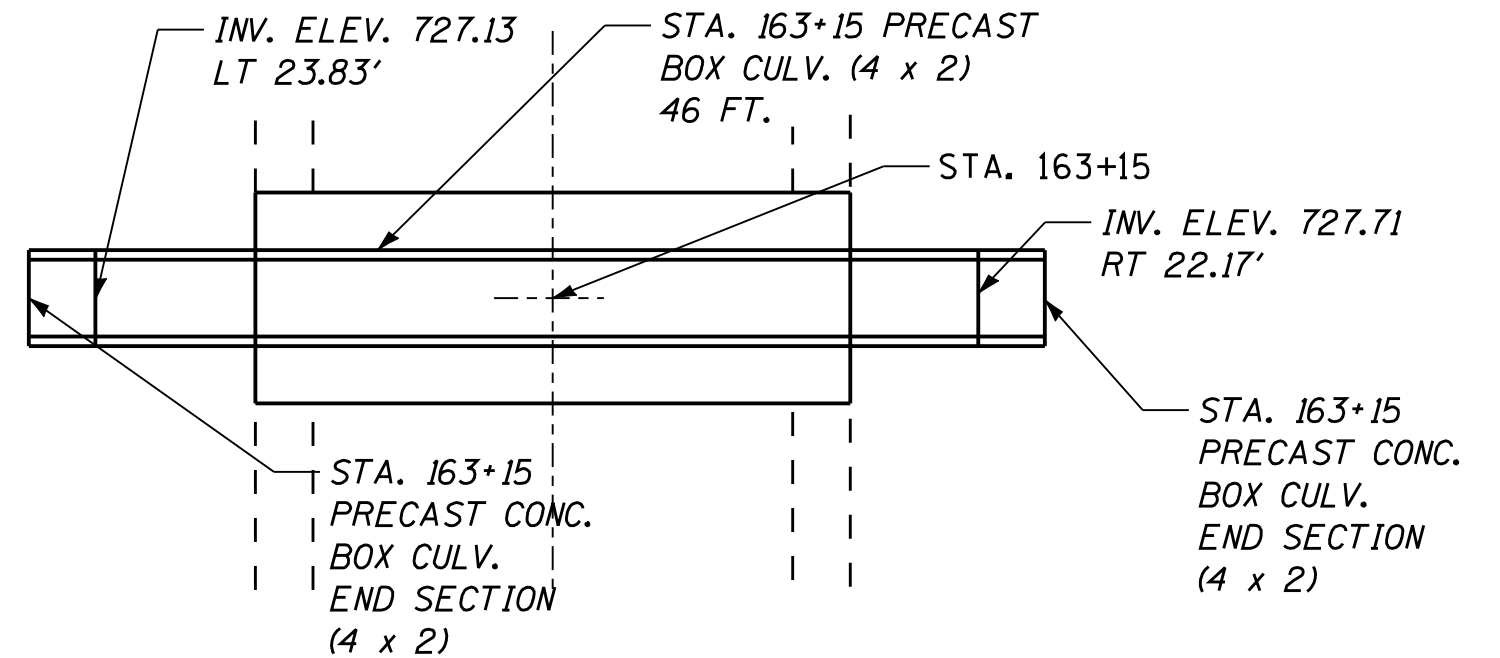
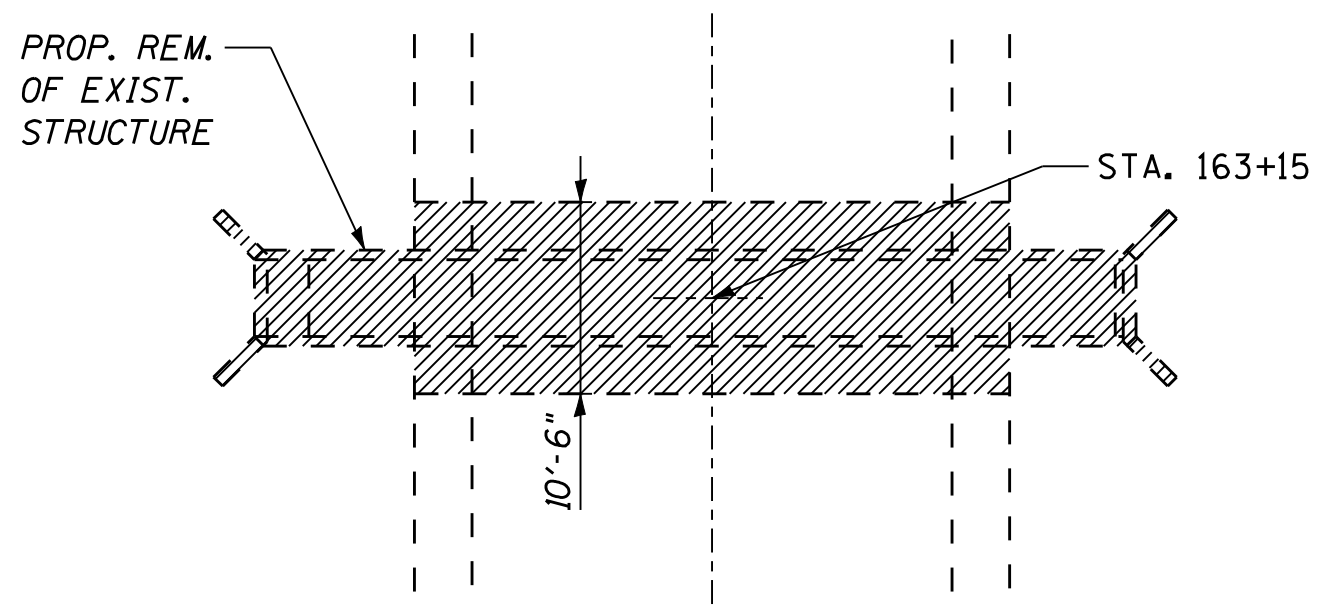

EXISTING CULVERT REMOVAL

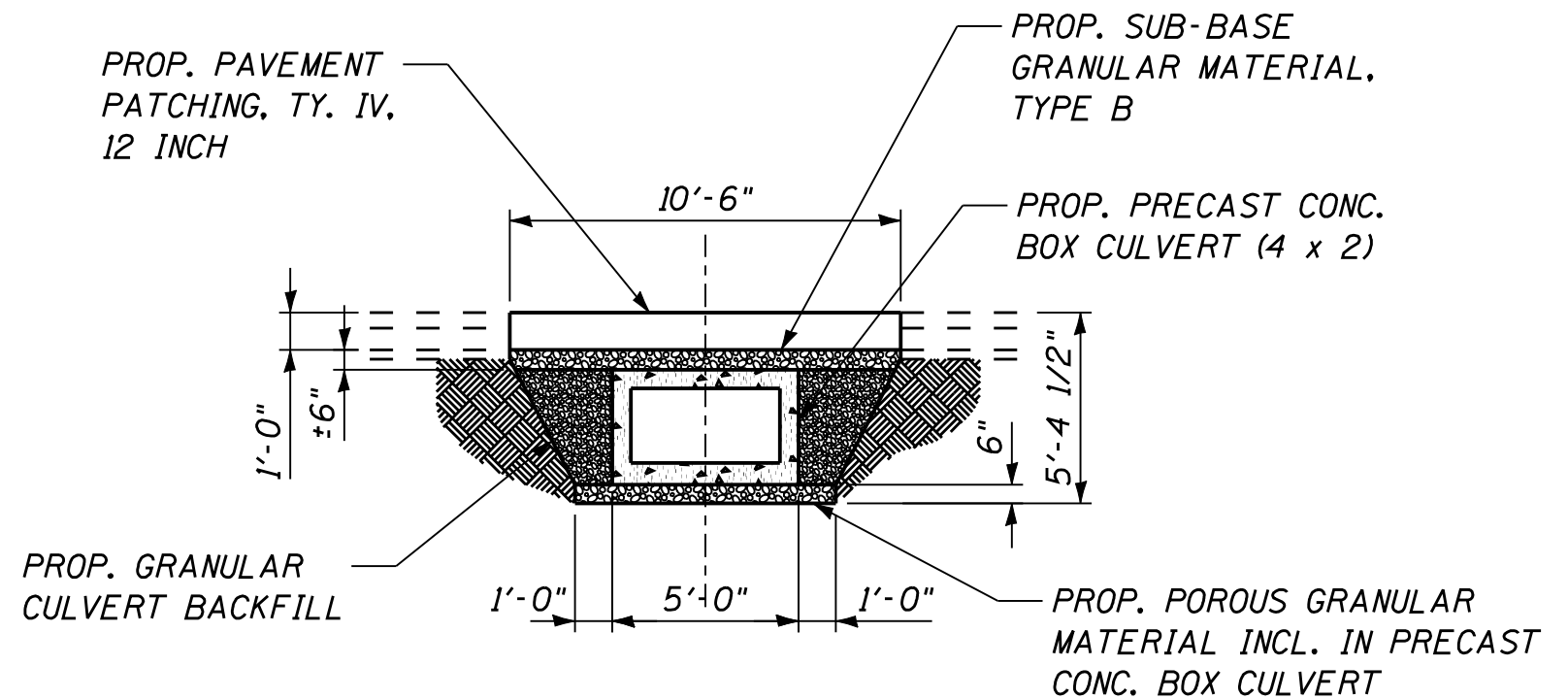

PROP. PRECAST CONC. BOX CULVERT (4 x 2)

CULVERT DETAILS
FAP 317 (US 24)
SECTION 5(RS-5.1)
ADAMS/BROWN COUNTY