

F.A. RTE.	SECTION	COUNTY	TOTAL SHEETS	SHEET NO.
.	.	.	12	4

STA.	TO STA.
FED. ROAD DIST. NO.	ILLINOIS FED. AID PROJECT

VARIOUS
D6 TRAFFIC SIGNAL MOD 2007
SANGAMON/MONTGOMERY



TRAFFIC SIGNAL QUANTITIES
LOCATION: IL 29 & MAIN ST.

QUANTITY	UNIT	ITEM
22.5	SQ FT	SIGN PANEL, TYPE II
38.0	FOOT	CONDUIT IN TRENCH, 2" DIA., PVC
29.0	FOOT	CONDUIT, AUGERED 2" DIA., PVC
38.0	FOOT	TRENCH AND BACKFILL FOR ELECTRICAL WORK
1	EACH	MAINTENANCE OF EXISTING TRAFFIC SIGNAL INSTALLATION
393.0	FOOT	ELECTRIC CABLE IN CONDUIT, SIGNAL NO. 14, 5C
2	EACH	STEEL MAST ARM ASSEMBLY AND POLE, 18'
20.0	FOOT	CONCRETE FOUNDATION, TYPE E, 30" DIA.
2	EACH	DRILL EXISTING HANDHOLE
8	EACH	TRAFFIC SIGNAL BACKPLATE
1336.0	FOOT	ELECTRIC CABLE IN CONDUIT, GROUND, #6 1/C (GREEN)
2	EACH	SIGNAL HEAD, POLYCARBONATE, LED, 1-FACE, 4-SECTION, MAST ARM MOUNTED
6	EACH	MODIFY EXISTING TRAFFIC SIGNAL BACKPLATE

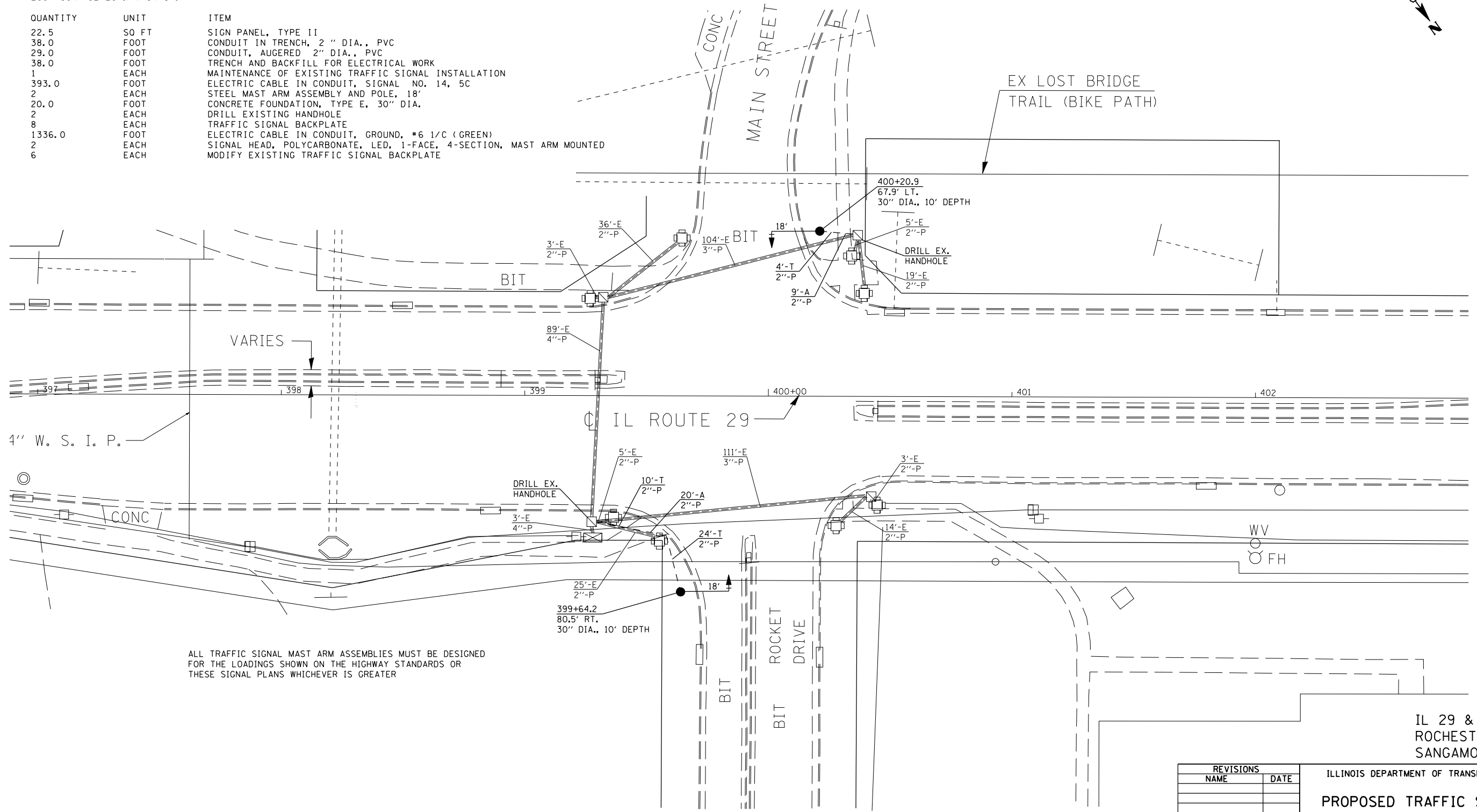

ALL TRAFFIC SIGNAL MAST ARM ASSEMBLIES MUST BE DESIGNED FOR THE LOADINGS SHOWN ON THE HIGHWAY STANDARDS OR THESE SIGNAL PLANS WHICHEVER IS GREATER

IL 29 & MAIN ST.
ROCHESTER
SANGAMON COUNTY

REVISIONS	
NAME	DATE

ILLINOIS DEPARTMENT OF TRANSPORTATION
PROPOSED TRAFFIC SIGNALS
VARIOUS ROUTES
SECTION D-6 TRAFFIC SIGNAL MOD 2007
MONTGOMERY / SANGAMON COUNTIES
SCALE: VERT. 1" = 20'
 HORIZ. 1" = 40'
DATE: MAY '06
DRAWN BY: KDA
CHECKED BY:

PLOT DATE = 5/25/2006
FILE NAME = c:\projects\652506\rochester\ts\sheet.dgn
PLOT SCALE = 42.3525 / IN.
USER NAME = brenhamme