

F.A. RTE.	SECTION	COUNTY	TOTAL SHEETS	SHEET NO.
.	.	.	12	9

STA. _____ TO STA. _____
 FED. ROAD DIST. NO. _____ ILLINOIS FED. AID PROJECT

- VARIOUS
- D6 TRAFFIC SIGNAL MOD 2007
- SANGAMON/MONTGOMERY

TRAFFIC SIGNAL QUANTITIES

LOCATION: IL 16 & IL 127

QUANTITY	UNIT	ITEM
8.0	SQ FT	SIGN PANEL, TYPE 1
3.0	FOOT	CONDUIT IN TRENCH, 2" DIA., PVC
11.0	FOOT	CONDUIT, AUGERED 2" DIA., PVC
3.0	FOOT	TRENCH AND BACKFILL FOR ELECTRICAL WORK
1	EACH	MAINTENANCE OF EXISTING TRAFFIC SIGNAL INSTALLATION
248.5	FOOT	ELECTRIC CABLE IN CONDUIT, SIGNAL NO. 14, 5C
1	EACH	STEEL MAST ARM ASSEMBLY AND POLE, 16'
10.0	FOOT	CONCRETE FOUNDATION, TYPE E, 30" DIA.
1	EACH	DRILL EXISTING HANDHOLE
3	EACH	TRAFFIC SIGNAL BACKPLATE
933.0	FOOT	ELECTRIC CABLE IN CONDUIT, GROUND, #6 1/C (GREEN)
1	EACH	SIGNAL HEAD, POLYCARBONATE, LED, 1-FACE, 3-SECTION, MAST ARM MOUNTED
6	EACH	MODIFY EXISTING TRAFFIC SIGNAL BACKPLATE

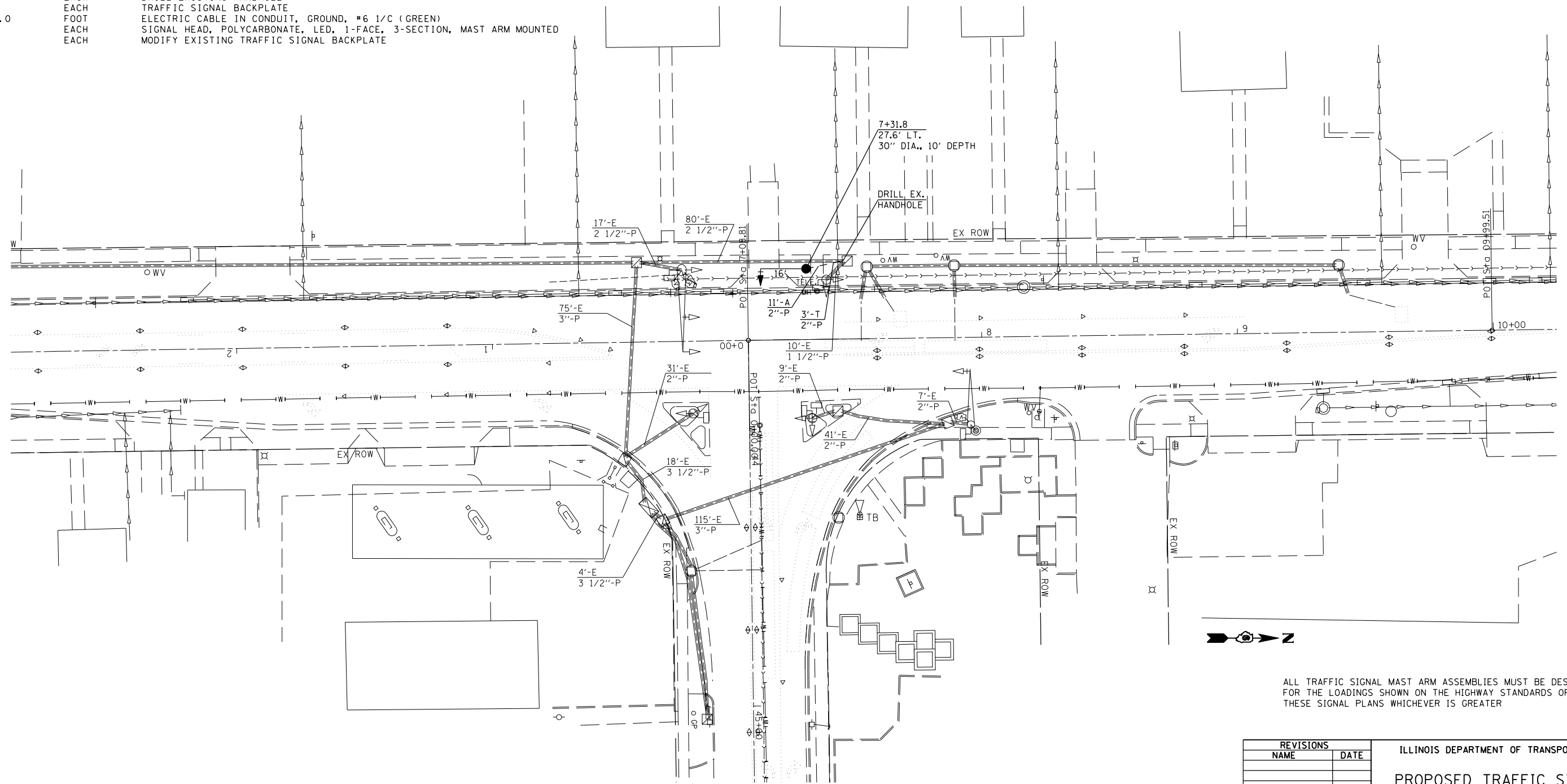

ALL TRAFFIC SIGNAL MAST ARM ASSEMBLIES MUST BE DESIGNED FOR THE LOADINGS SHOWN ON THE HIGHWAY STANDARDS OR THESE SIGNAL PLANS WHICHEVER IS GREATER

REVISIONS	
NAME	DATE

ILLINOIS DEPARTMENT OF TRANSPORTATION
PROPOSED TRAFFIC SIGNALS
 MAIN ST. (IL 127) & SCHOOL ST. (IL 16)
 MONTGOMERY COUNTY
 SCALE: VERT. 1" = 20'
 HORIZ. 1" = 40'
 DATE: MAY '06
 DRAWN BY: KDA
 CHECKED BY: _____

PLOT DATE = 5/25/2006
 FILE NAME = c:\projects\652506\h11\borov\ts_sheets.dgn
 PLOT SCALE = 42.3525 / IN.
 USER NAME = brenhamme