

STATE OF ILLINOIS
DEPARTMENT OF TRANSPORTATION

ROUTE NO.	SECTION	COUNTY	TOTAL SHEETS	SHEET NO.
FAI 64		WAYNE	//	//
FED. ROAD DIST. NO. 7	ILLINOIS	FED. AID PROJECT		

SHEET NO. 3
3 SHEETS

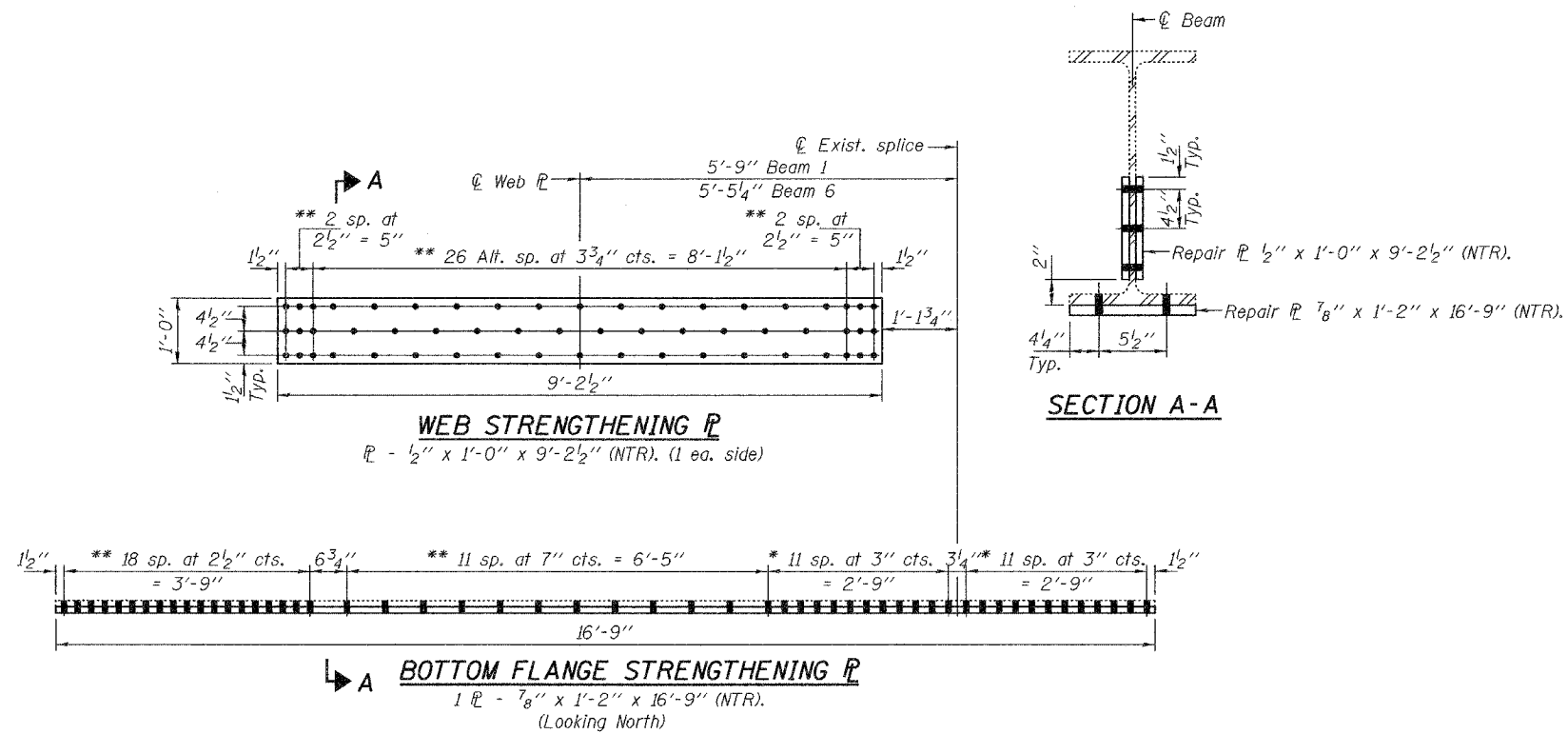

* Remove existing splice plate. Use existing holes in bottom flange as template to field drill holes in new plate.
 ** Use holes in new plate as template to field drill holes in beam.
 Fasteners for beam strengthening shall be 3/4" high strength bolts, in 15/16" holes.
 Cost of removal of existing bottom flange splice plate is included with Structural Steel Repair.
 Existing bolts shall not be re-used.
 The cost of the strengthening plates and field drilling required for installation of the steel members is included with Structural Steel Repair.
 Traffic shall be maintained at least one beam spacing away from Girder 1 and 6 while splice plate is being replaced.

DESIGNED	MJT
CHECKED	ATH
DRAWN	baliva
CHECKED	MJT ATH

JUNE 6, 2006
 EXAMINED *John A. Morris*
 ENGINEER OF STRUCTURAL SERVICES
 PASSED *Ralph E. Anderson*
 ENGINEER OF BRIDGES AND STRUCTURES

STRUCTURAL STEEL REPAIR
FAI 64 (EB) OVER US 45
WAYNE COUNTY
SN 096-0059 (EB)