

F.A. RTE.	SECTION	COUNTY	TOTAL SHEETS	SHEET NO.
*	**	***	310	36

CONTRACT NO. 74155

- * PARK ROADS
- ** SFWA PARK ROADS 2003-1
- *** MOULTRIE AND SHELBY

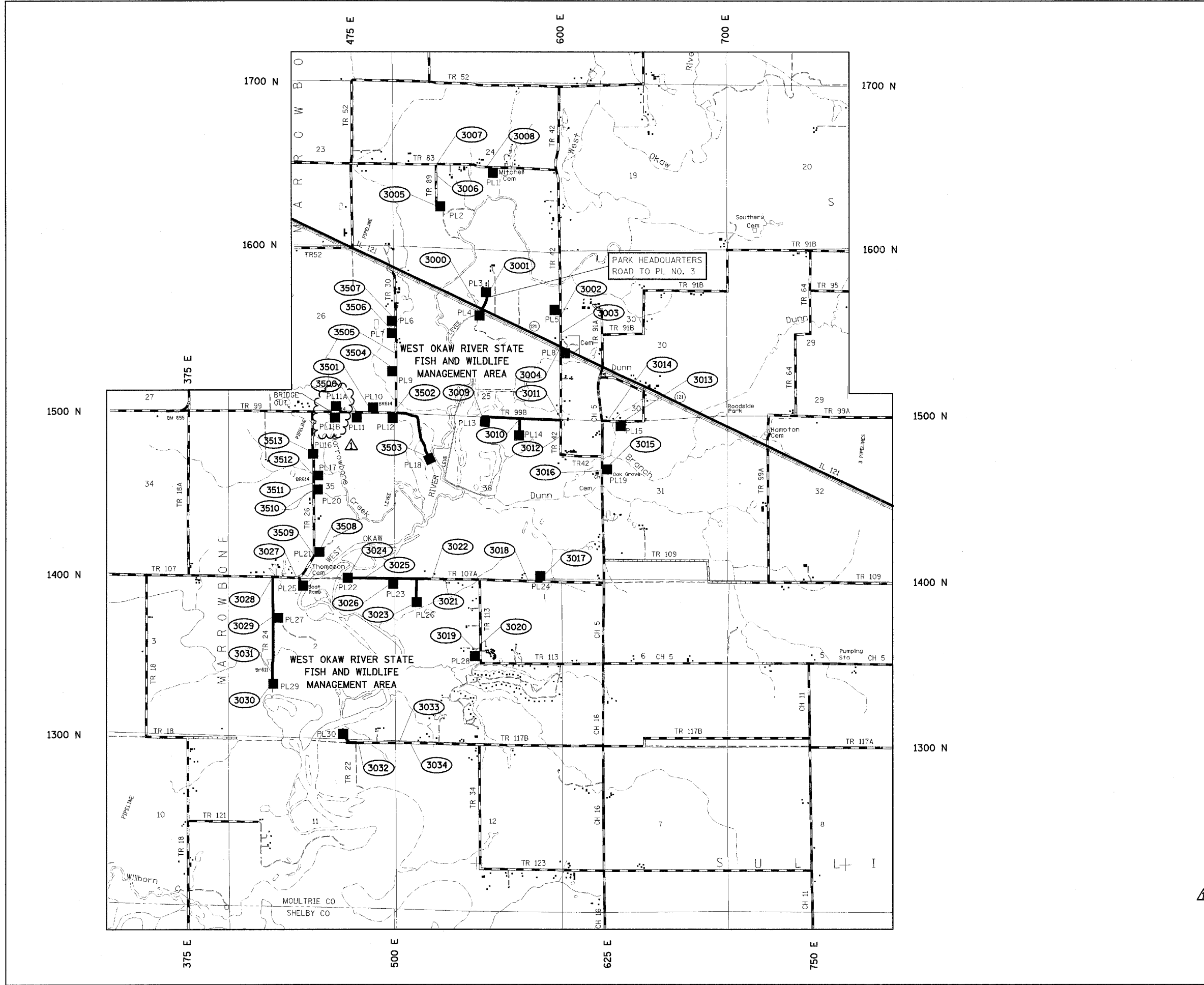

LEGEND

- PL = PARKING LOT
- TR = TOWNSHIP ROAD
- (1234) = TIE POINT LOCATION

REVISIONS	
NAME	DATE
FGI	11/23/2005

ILLINOIS DEPARTMENT OF TRANSPORTATION

TIE POINT LOCATION PLAN
WEST OKAW FISH & WILDLIFE UNIT

SCALE: _____

DATE _____

DRAWN BY BANDY

CHECKED BY STEUART