

F.A. RTE.	SECTION	COUNTY	TOTAL SHEETS	SHEET NO.
*	**	***	310	80

STA. TO STA.
CONTRACT NO. 74155

- * PARK ROADS
- ** SFWA PARK ROADS 2003-1
- *** MOULTRIE AND SHELBY

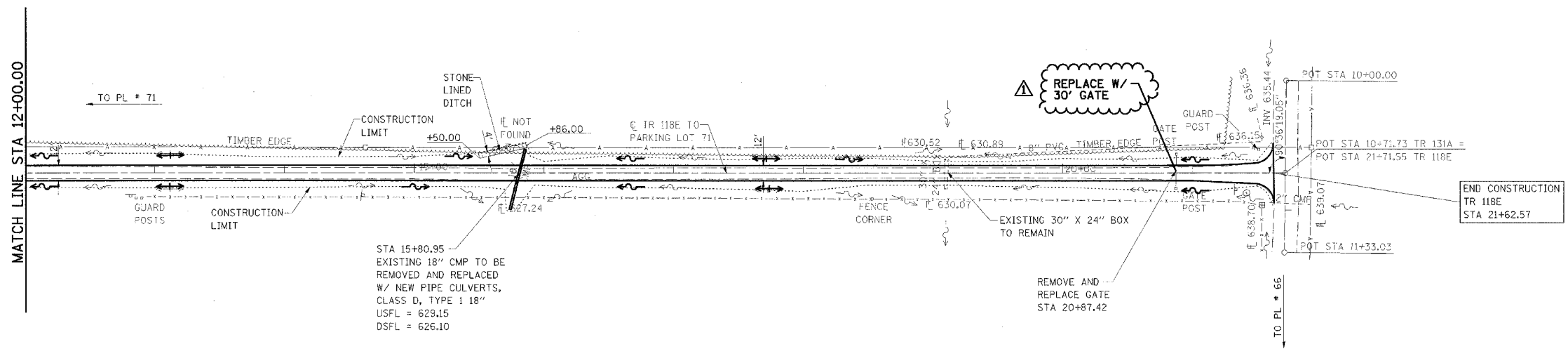

NOTE:
TR 118E
STA 1+48.42 TO STA 21+62.57
SURFACE IMPROVEMENTS,
ADD 3" AGGREGATE

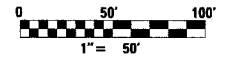

△ - REVISED BY FGI 11/23/2005

DATE	BY

PLAN
NO. _____
DATE _____
BY _____
CHECKED _____
DATE _____
BY _____

DATE	BY

PROFILE
NO. _____
DATE _____
BY _____
CHECKED _____
DATE _____
BY _____

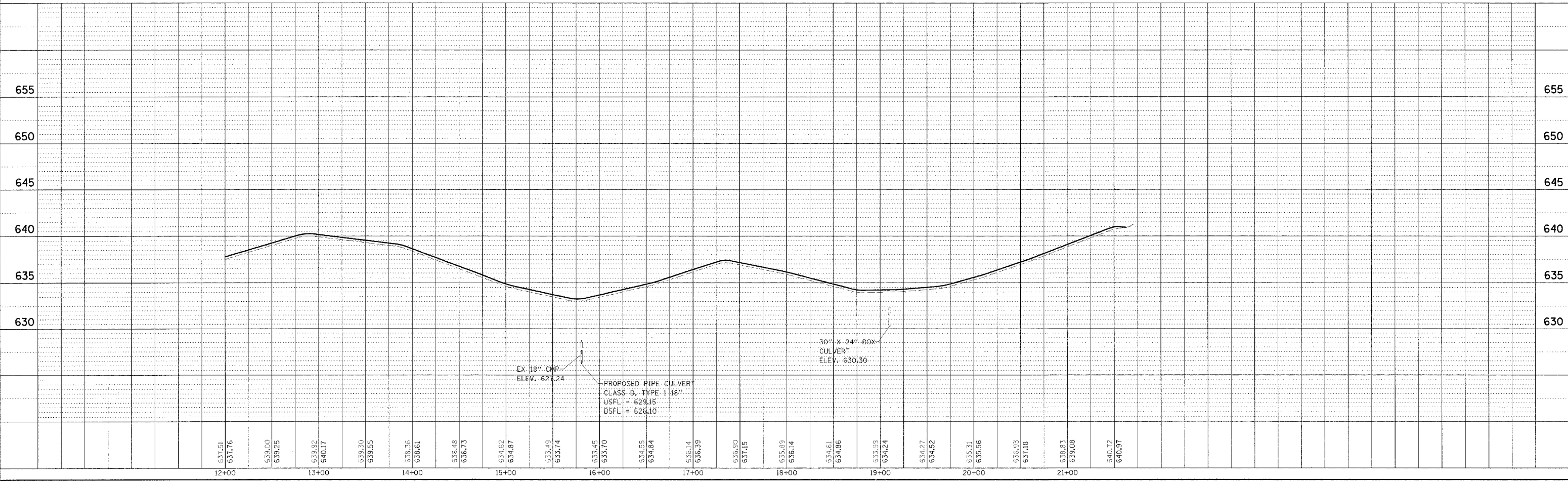

KASKASKIA FISH & WILDLIFE UNIT PLAN AND PROFILE, TR 118E TO PARKING LOT 71