

F.A. RTE.	SECTION	COUNTY	TOTAL SHEETS	SHEET NO.
*	**	***	310	123
STA. TO STA.				
CONTRACT NO. 74155				
* PARK ROADS				
** SFWA PARK ROADS 2003-1				
*** MOULTRIE AND SHELBY				

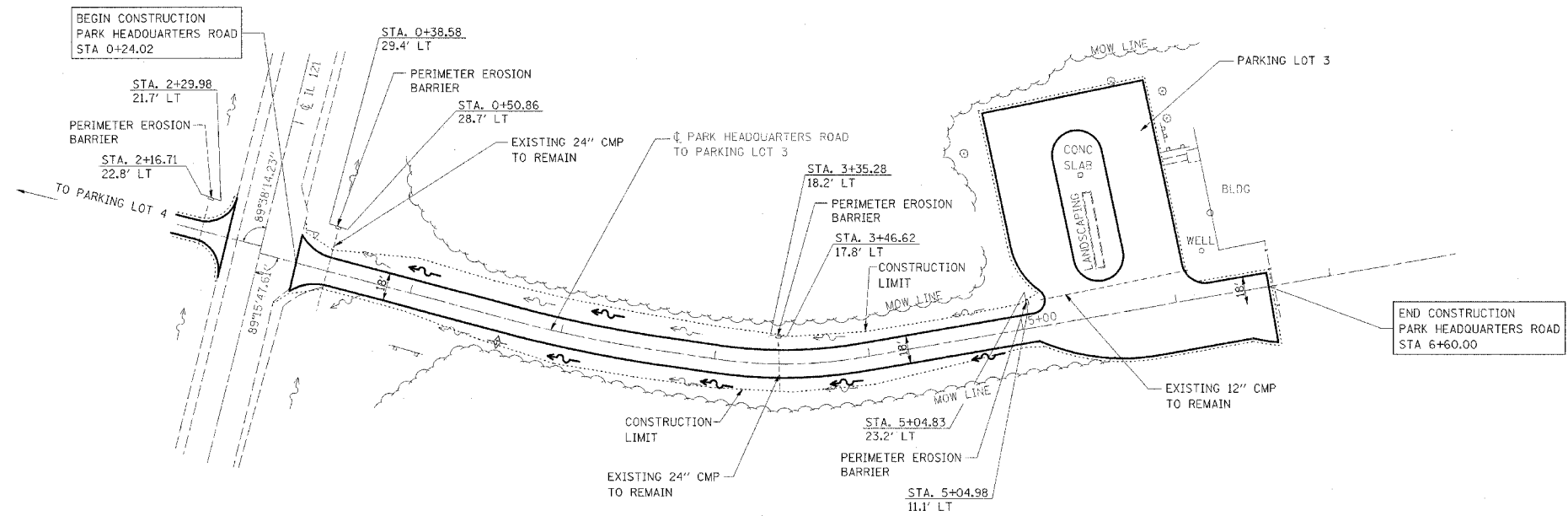

NOTE:
 PARK HEADQUARTERS ROAD
 STA 0+24.02 TO STA 6+60.00
 SCARIFY ROAD, ADD 3\"/>

REVISIONS TO PARK ROADS AND PARKING LOTS SHOWN ON PREVIOUS PLAN SHEETS THAT DO NOT IMPACT EROSION CONTROL ARE NOT BALLOONED OR NOTED AS REVISIONS TO ELIMINATE CLUTTER AND CROWDING ON THE EROSION CONTROL SHEETS

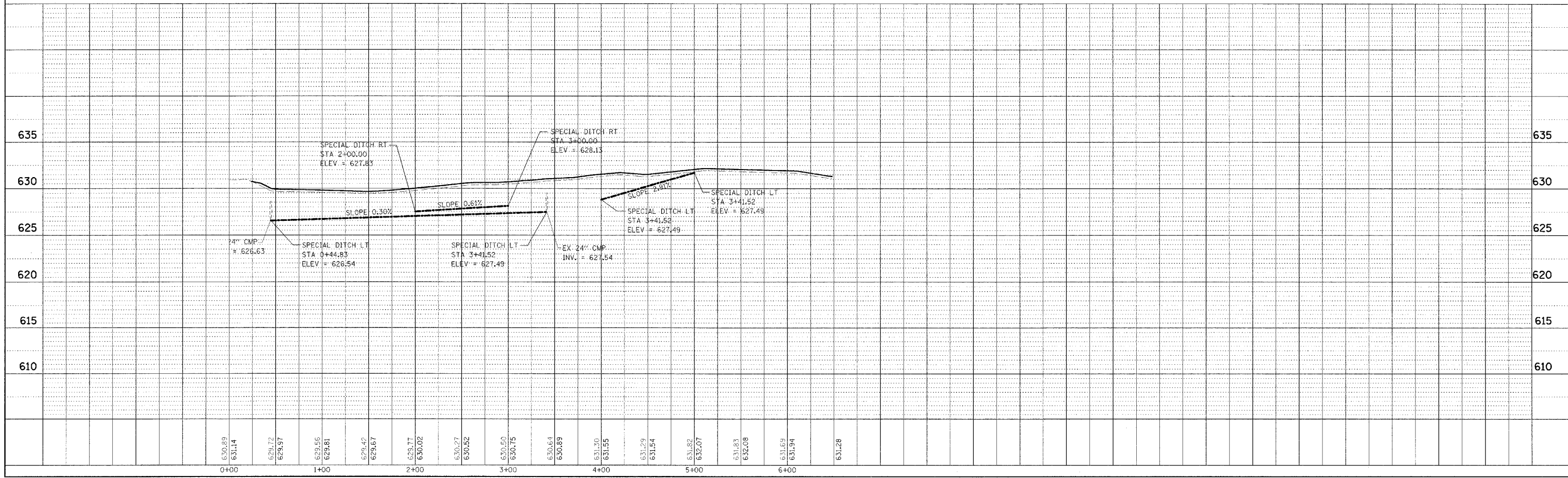
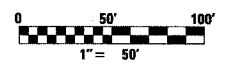

WEST OKAW FISH & WILDLIFE UNIT EROSION CONTROL PLAN AND PROFILE, PARK HEADQUARTERS RD. TO PARKING LOT 3

PLAN	REVISIONS	DATE

PROFILE	REVISIONS	DATE