

F.A. RTE.	SECTION	COUNTY	TOTAL SHEETS	SHEET NO.
*	**	***	310	126
STA. TO STA.		CONTRACT NO. 74155		
<ul style="list-style-type: none"> <li>* PARK ROADS</li> <li>** SFWA PARK ROADS 2003-1</li> <li>*** MOULTRIE AND SHELBY</li> </ul>				

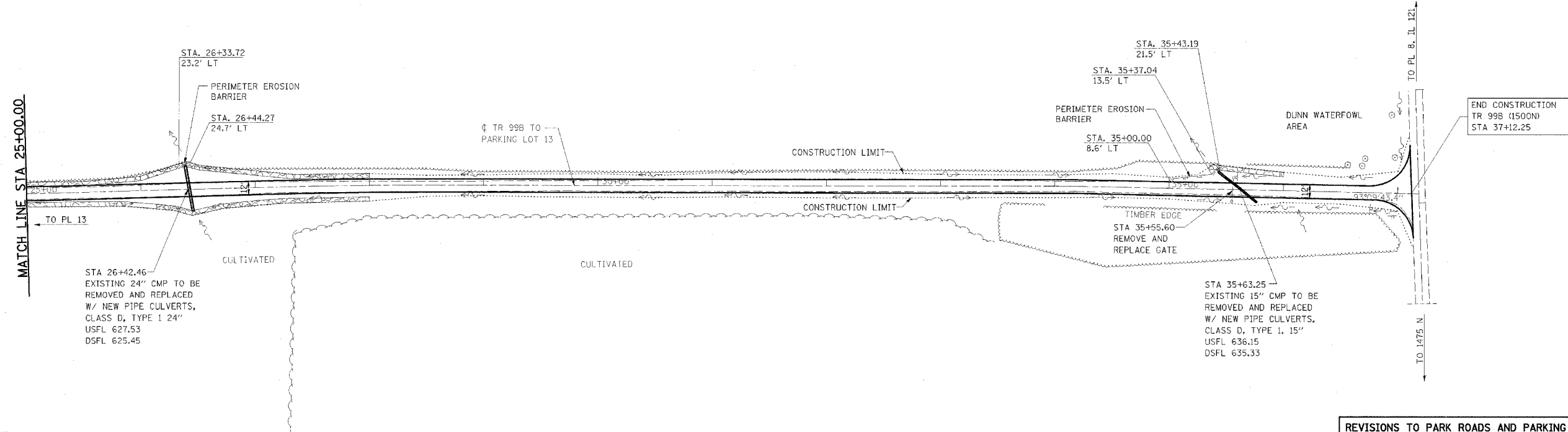

NOTE:  
 TR 99B  
 STA 12+04.34 TO STA 37+12.25  
 SURFACE IMPROVEMENTS,  
 ADD 3" AGGREGATE

REVISIONS TO PARK ROADS AND PARKING LOTS SHOWN ON PREVIOUS PLAN SHEETS THAT DO NOT IMPACT EROSION CONTROL ARE NOT BALLOONED OR NOTED AS REVISIONS TO ELIMINATE CLUTTER AND CROWDING ON THE EROSION CONTROL SHEETS

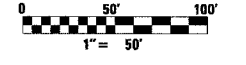

DATE	BY

REVISIONS  
 CHECKED  
 PLOTTED  
 NOTE BOOK  
 NO.

DATE	BY

PROFILE  
 CHECKED  
 PLOTTED  
 NOTE BOOK  
 NO.

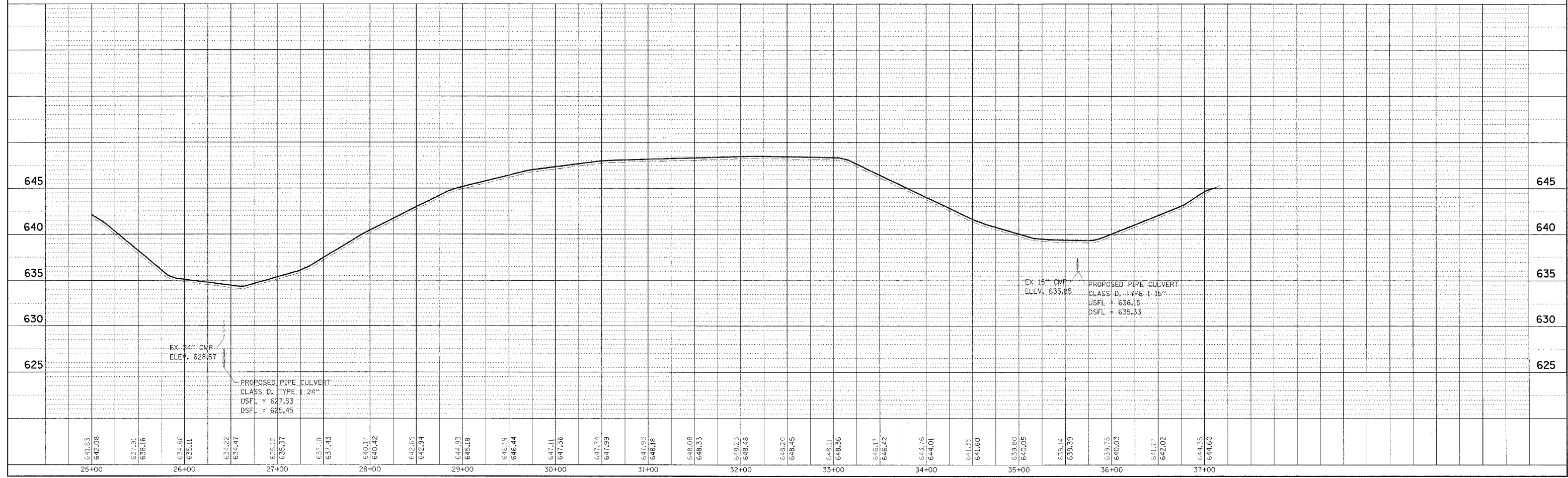

WEST OKAW FISH & WILDLIFE UNIT EROSION CONTROL PLAN AND PROFILE, TR 99B TO PARKING LOT 13