

F.A. RTE.	SECTION	COUNTY	TOTAL SHEETS	SHEET NO.
*	**	***	310	129

STA. \_\_\_\_\_ TO STA. \_\_\_\_\_

CONTRACT NO. 74155

- \* PARK ROADS
- \*\* SFWA PARK ROADS 2003-1
- \*\*\* MOULTRIE AND SHELBY

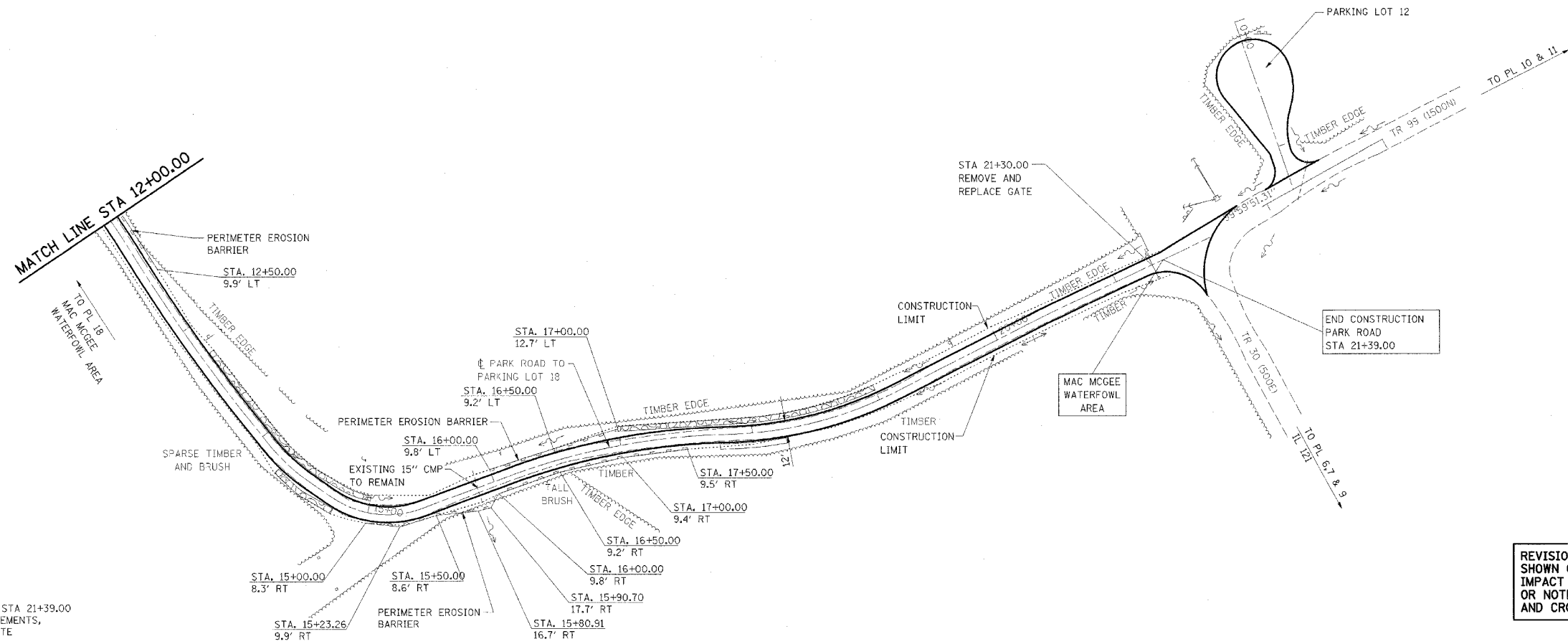

NOTE:  
PARK ROAD  
STA 2+11.60 TO STA 21+39.00  
SURFACE IMPROVEMENTS,  
ADD 3" AGGREGATE

REVISIONS TO PARK ROADS AND PARKING LOTS SHOWN ON PREVIOUS PLAN SHEETS THAT DO NOT IMPACT EROSION CONTROL ARE NOT BALLOONED OR NOTED AS REVISIONS TO ELIMINATE CLUTTER AND CROWDING ON THE EROSION CONTROL SHEETS

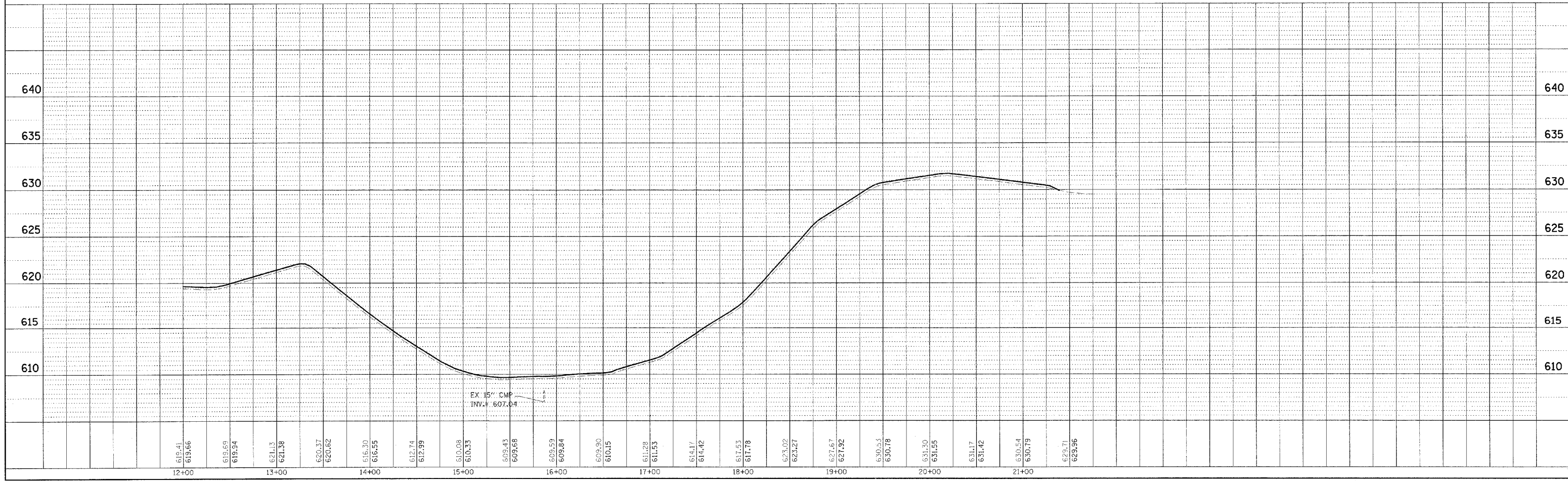

WEST OKAW FISH & WILDLIFE UNIT EROSION CONTROL PLAN AND PROFILE, PARK ROAD TO PARKING LOT 18

DATE	BY

PLAN SURVEYED  
PLOTTED  
NOTE BOOK NO. \_\_\_\_\_  
DATE OF WAY CHECKED \_\_\_\_\_  
FILE NAME \_\_\_\_\_

DATE	BY

PROFILE SURVEYED  
PLOTTED  
NOTE BOOK NO. \_\_\_\_\_  
DATE OF WAY CHECKED \_\_\_\_\_  
STRUCTURE RATINGS CHNG \_\_\_\_\_