

F.A. RTE.	SECTION	COUNTY	TOTAL SHEETS	SHEET NO.
*	**	***	310	139
STA. TO STA.				
CONTRACT NO. 74155				
<ul style="list-style-type: none"> * PARK ROADS ** SFWA PARK ROADS 2003-1 *** MOULTRIE AND SHELBY 				

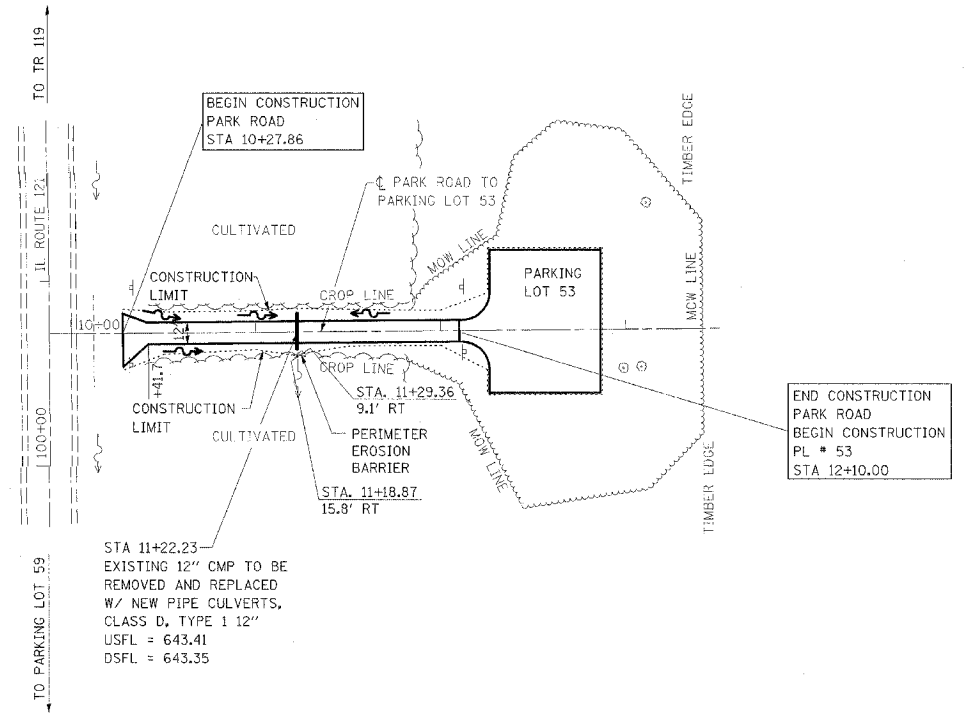

STA 11+22.23
EXISTING 12" CMP TO BE REMOVED AND REPLACED W/ NEW PIPE CULVERTS. CLASS D, TYPE 1 12" USFL = 643.41 DSFL = 643.35

END CONSTRUCTION PARK ROAD
BEGIN CONSTRUCTION PL # 53
STA 12+10.00

NOTE:
PARK ROAD
STA 10+27.86 TO STA 12+10.00
SURFACE IMPROVEMENTS,
ADD 3" AGGREGATE

REVISIONS TO PARK ROADS AND PARKING LOTS SHOWN ON PREVIOUS PLAN SHEETS THAT DO NOT IMPACT EROSION CONTROL ARE NOT BALLOONED OR NOTED AS REVISIONS TO ELIMINATE CLUTTER AND CROWDING ON THE EROSION CONTROL SHEETS



PLAN	DATE
BY	
NO.	

PROFILE	DATE
BY	
NO.	

