

F.A. RTE.	SECTION	COUNTY	TOTAL SHEETS	SHEET NO.
*	**	***	310	141
STA. TO STA.				
CONTRACT NO. 74155				
<ul style="list-style-type: none"> * PARK ROADS ** SFWA PARK ROADS 2003-1 *** MOULTRIE AND SHELBY 				

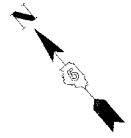

DATE	BY

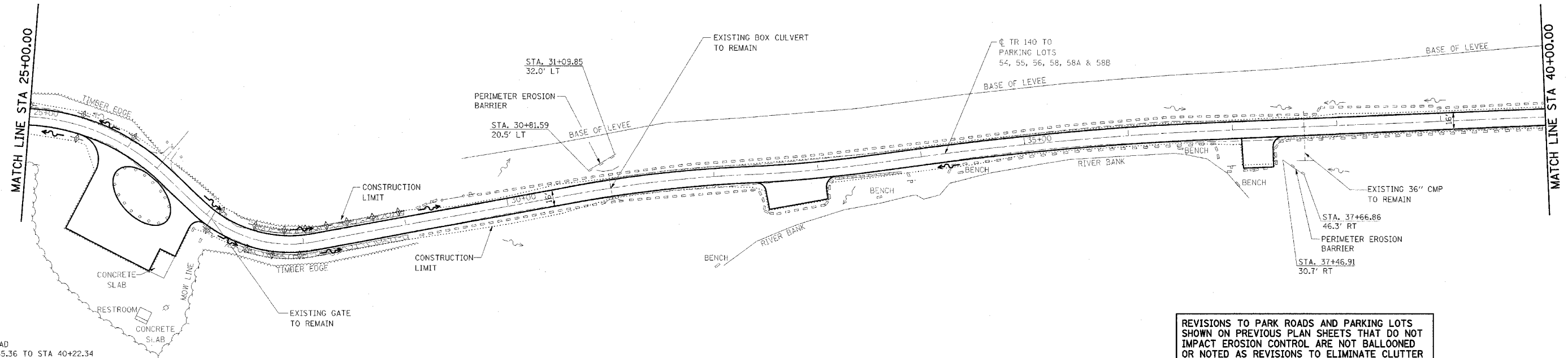

NOTE:
 PARK ROAD
 STA 11+55.36 TO STA 40+22.34
 SURFACE IMPROVEMENTS,
 ADD 3" AGGREGATE

REVISIONS TO PARK ROADS AND PARKING LOTS
 SHOWN ON PREVIOUS PLAN SHEETS THAT DO NOT
 IMPACT EROSION CONTROL ARE NOT BALLOONED
 OR NOTED AS REVISIONS TO ELIMINATE CLUTTER
 AND CROWDING ON THE EROSION CONTROL SHEETS

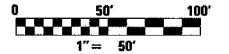

DATE	BY

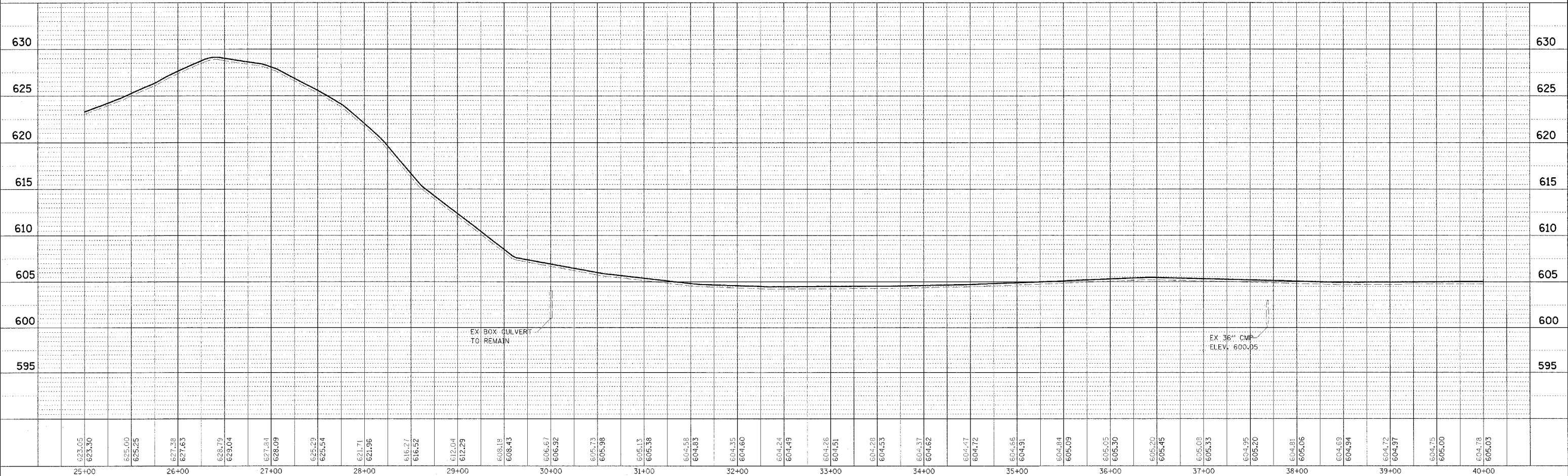

KASKASKIA FISH & WILDLIFE UNIT EROSION CONTROL PLAN AND PROFILE, TR 140 TO PARKING LOTS 54, 55, 56, 58, 58A & 58B