

F.A. RTE.	SECTION	COUNTY	TOTAL SHEETS	SHEET NO.
*	**	***	310	152
STA. TO STA.				
CONTRACT NO. 74155				
<ul style="list-style-type: none"> * PARK ROADS ** SFWA PARK ROADS 2003-1 *** MOULTRIE AND SHELBY 				

STA 1+48.07
EXISTING 12" CMP TO BE REMOVED AND REPLACED W/ NEW PIPE CULVERTS, CLASS D, TYPE 1 12"
USFL = 647.95
DSFL = 647.61

END CONSTRUCTION PL # 71
BEGIN CONSTRUCTION TR 118E
STA 1+48.42

STA. 1+41.98
18.3' LT
PERIMETER EROSION BARRIER
STA. 1+34.28
13.2' LT

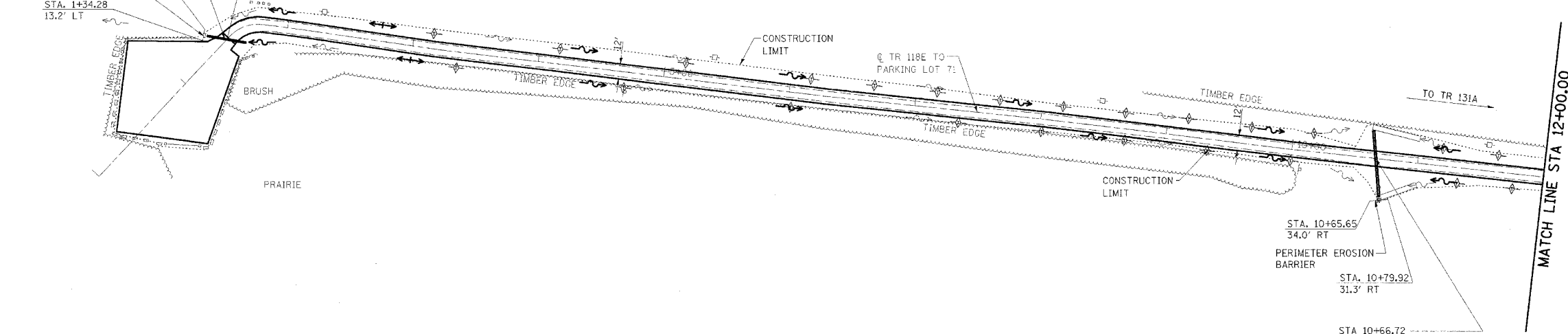

STA 10+66.72
EXISTING 18" CMP TO BE REMOVED AND REPLACED W/ NEW PIPE CULVERTS, CLASS D, TYPE 1 18"
USFL = 627.69
DSFL = 626.24

REVISIONS TO PARK ROADS AND PARKING LOTS SHOWN ON PREVIOUS PLAN SHEETS THAT DO NOT IMPACT EROSION CONTROL ARE NOT BALLOONED OR NOTED AS REVISIONS TO ELIMINATE CLUTTER AND CROWDING ON THE EROSION CONTROL SHEETS

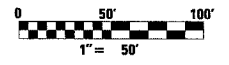

NOTE:
TR 118E
STA 1+48.42 TO STA 21+62.57
SURFACE IMPROVEMENTS,
ADD 3" AGGREGATE

DATE	BY

PLAN

NO. _____

DATE _____

BY _____

REVISIONS CHECKED _____

DATE _____

STATUS _____

NO. _____

DATE	BY

PROFILE

NO. _____

DATE _____

BY _____

REVISIONS CHECKED _____

DATE _____

STATUS _____

NO. _____

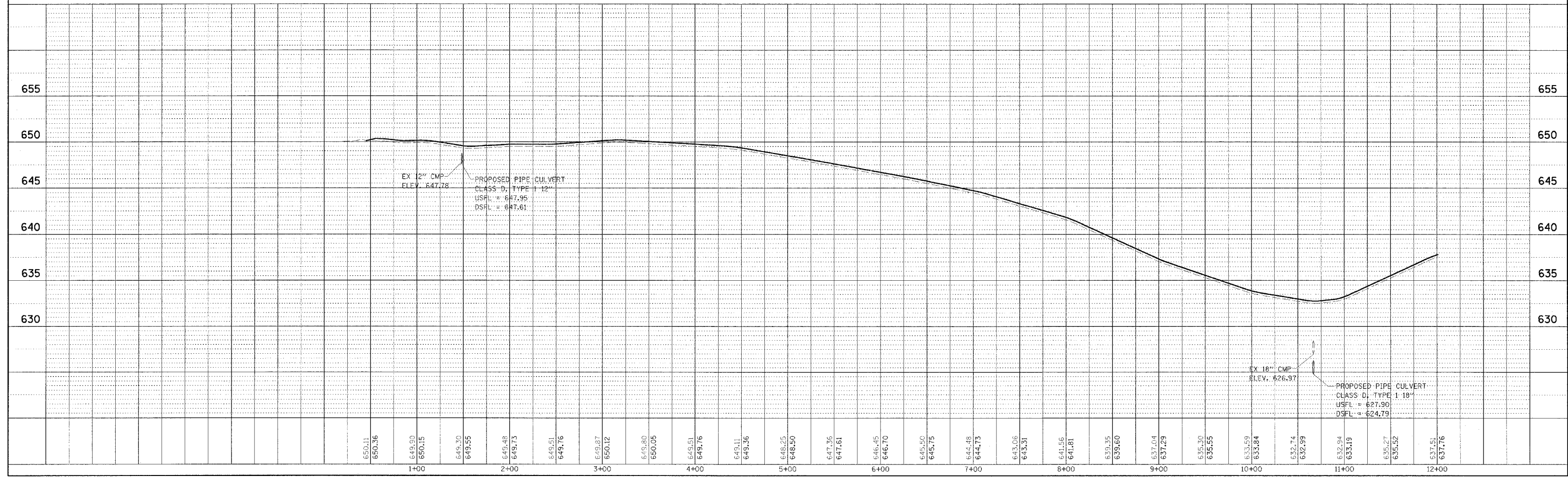

KASKASKIA FISH & WILDLIFE UNIT EROSION CONTROL PLAN AND PROFILE, TR 118E TO PARKING LOT 71