

REVIEWED	DATE
BY	
FINAL SURVEY	
NOTE BOOK	
AREAS CHECKED	

REVIEWED	DATE
BY	
ORIGINAL SURVEY	
NOTE BOOK	
AREAS CHECKED	

* PARK ROADS	F.A.P. RTE.	SECTION	COUNTY	TOTAL SHEETS	SHEET NO.
** SFWA PARK ROADS 2003-1	*	**	***	310	213
*** MOULTRIE AND SHELBY	CONTRACT NO. 74155				

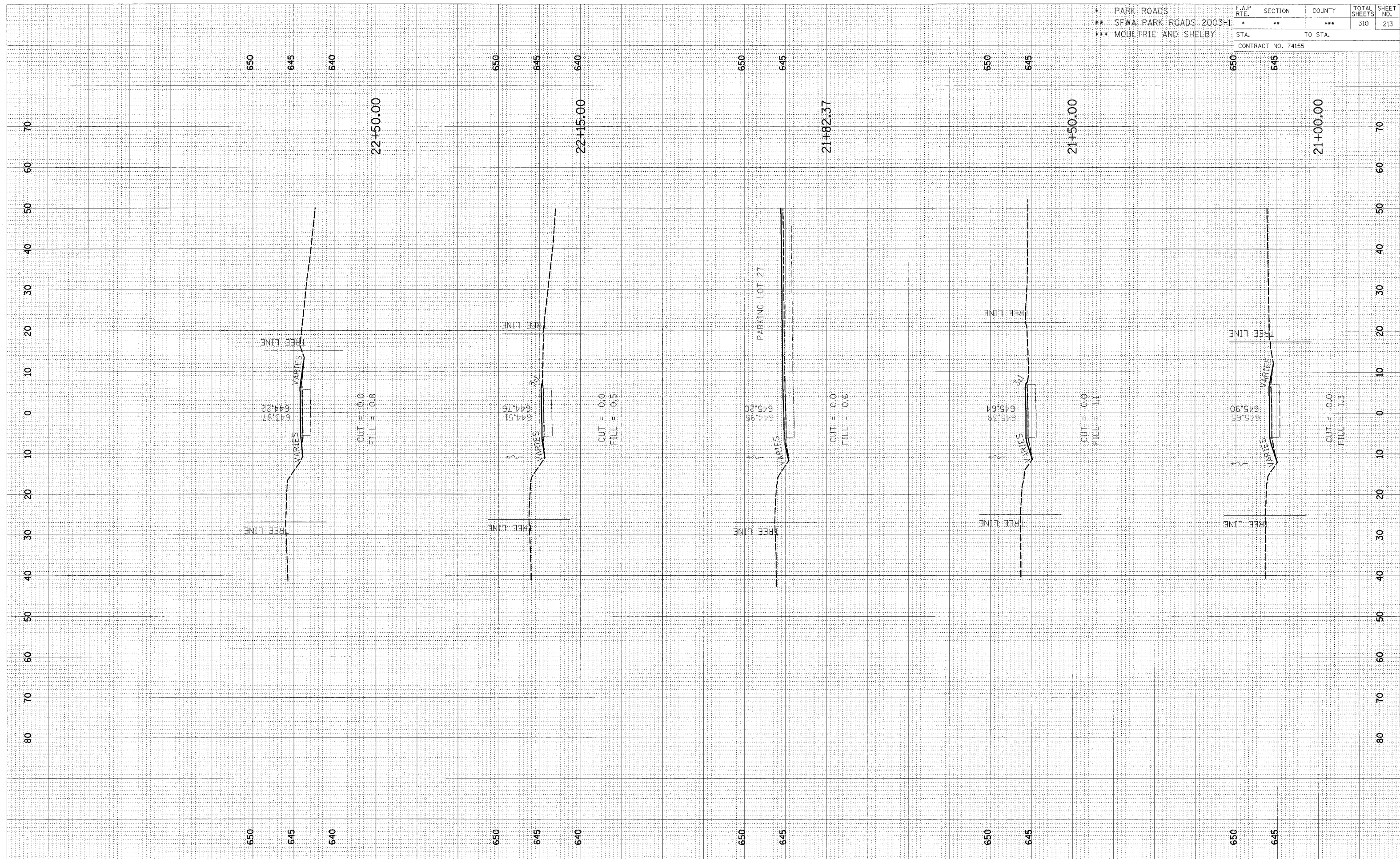

CROSS SECTION, OKAW, TOWNSHIP ROAD 24 TO PARKING LOT 27 & 29, STA 21+00.00 TO STA 22+50.00